

**ESTATE MAP AND WALKING TOUR**

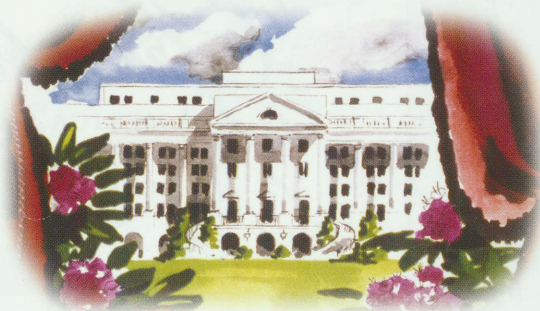



# ESTATE MAP AND

## The Greenbrier® AMERICA'S RESORT

1. **The Indoor Pool.** This structure, which houses the Indoor Swimming Pool, was built in 1912. The Mineral Bath Department was located on the upper two floors of this building for 75 years.

2. **The Mineral Bath and Spa Building.** The mineral water from the White Sulphur Spring is pumped to this building where guests may "take the waters" much as they have been doing for over two centuries. The first section of today's facility opened in 1987 but it was virtually rebuilt and doubled in size in 2001.

3. **Building History.** The earliest part of today's hotel opened in October 1913, but it was substantially expanded in 1931. The architect of the expanded hotel was Phillip Small of Cleveland.

3a. **The Front Entrance.** The hotel's entrance foyer was rebuilt and expanded during the construction of the underground casino in 2009-2010 but the iconic portico and columns are original. Extensive landscaping upgrades and addition of walking paths were also part of the casino project.

4a. **South Carolina Row.** White Sulphur Springs was always a popular destination in the 19<sup>th</sup> century for South Carolinians. The six cottages of South Carolina Row were originally built in 1858 during a period of rapid expansion at the resort.

4b. **Tansas Row.** The six cottages of Tansas Row were originally built in the 1850s – the first three were owned by families from Tansas Parish in northern Louisiana, thus the unusual name.

5. **The Security Building and Fire Department.** This is one of the few remaining U.S. Army buildings added to the property during World War II when The Greenbrier was used as a hospital.

6a. **Colonnade Estate House.** The Colonnade was built in 1838 as a summer house shared by Richard Singleton and Wade Hampton, II of South Carolina. In later years, it was the summer home of W.W. Corcoran who founded the Corcoran Gallery of Art in Washington, D.C.

6b. **President's Estate House.** For over forty years, presidents of The Greenbrier lived in this house. The home was originally built in 1912 for Edwin Hawley, the Chairman of the Board of the Chesapeake and Ohio Railway Company.

7a. **Baltimore Row.** In 1832, John H.B. Latrobe of Baltimore designed what is now Baltimore "B" and it became the architectural model for all the subsequent cottages. The seven Baltimore Row cottages were completed by 1838. Robert E. Lee and his family spent three post-Civil War summers in Baltimore "G" cottage.

7b. **Paradise Row.** These cottages were built in sections in the late 1820s and early 1830s and were called "paradise" because they were the best available.

8a. **The Presidents' Cottage Museum.** This structure, built as a private summer home for a wealthy Louisiana sugar planter in 1835, was the finest single accommodation and was used to house five U.S. Presidents in the summers before the Civil War.

8b. **Alabama Row.** Built in the 1830s as guest cottages, these are some of the oldest buildings at The Greenbrier. In the 1930s, the cottages of Alabama Row were converted into classrooms for an Art School and then refurbished in the 1950s as the Alabama Row Art Colony Shops.

9. **The Springhouse.** The story of The Greenbrier begins here, the spring of sulphur water – the White Sulphur Spring – that drew the first visitors to this valley. In 1778, people came to "take the waters" to restore their health.

10a. Tennis has been a feature of The Greenbrier since the early days of the 20th century. Courts were first built on the site of today's outdoor Har-Tru units in 1915. The Indoor Tennis Center opened in October 1975. Also located within the **Tennis Club** is the **Fitness Center**, featuring a wide range of aerobic and weight equipment as well as personal training and fitness evaluations.

10b. The Greenbrier's **Outdoor Swimming Pool** features a zero-entry, infinity-edge design; Tree Tops Café; men's and ladies' locker rooms and a retail swim shop.





# D WALKING TOUR



11. The earliest part of the **Golf Club** opened in 1913. It was expanded in 1930 and again in 1976. The interior was rebuilt in 1997 when Sam Snead's at the Golf Club and Slammin' Sammy's opened.

The **Greenbrier Course** opened July 4, 1924. It was redesigned by Jack Nicklaus in 1977 and was the site of the International Ryder Cup Matches in September 1979. The Solheim Cup Matches were held here in October 1994, making this course the only resort course to have hosted both the Ryder and Solheim Cup matches.

A small nine-hole course opened on the site of today's **Driving Range** in 1910 and remained in use until the first driving range was built in 1962.

The **Meadows Course** opened in 1999 after golf architect Bob Cupp redesigned, reconfigured and rebuilt an earlier course known as the Lakeside.

The **Old White TPC Course** was designed by "the Father of Golf Architecture in America," Charles Blair Macdonald in 1914 and has been completely restored to its original design by Lester George of George Golf Design in 2006.

12. The **Spring Row Guest Houses** were named because of their proximity to the spring that was the major attraction of the resort at the time of founding.

13. The **Croquet Lawn**. Built in 1990 on the site of the first permanent building (a dining room built in 1808) the Croquet Lawn is in front of the Spring Row cottages which were first occupied in the summer of 1989.

14a. From 1858 until 1922, the **Old White Hotel** stood where the current parking garages were built in 1930. The old hotel was a summer-only structure and was removed to allow for an expansion of The Greenbrier.

14b. The **North Entrance**. This is what might be called the "signature view" of The Greenbrier. The façade has remained essentially unchanged since completion in 1931.

15a. The **Florida Guest House** is the last remaining unit of Florida Row which was originally built in the late 1850s. Those cottages were removed after World War II.

15b. **Top Notch Estate House** was built for the president of the Chesapeake and Ohio Railway, George Stevens, in 1912. General Dwight D. Eisenhower vacationed in this cottage with his family in 1945, immediately following the end of World War II.

16a. The **West Virginia Wing** was built as part of "Project Greek Island" the once secret underground Cold War bunker created for emergency use by the U.S. Congress. The Bunker lies directly underneath this wing. Construction of The Bunker and the new wing took three years, from 1959 to 1962. The Greenbrier Clinic and guest rooms are located in the West Virginia Wing.

17. **Christmas Shop at The Depot**. This was the train station, built in 1931. The railroad – the Chesapeake and Ohio Railway – arrived at White Sulphur Springs in 1869. The Depot was converted into a year-round Christmas Shop in 1996.

18. The **Garden Gallery**. Located near the outdoor tennis courts, you'll find fun indoor and outdoor garden and home accessories including flags, lawn ornamentation outdoor fire bowls and pits as well as everything you need to create the whimsical garden masterpiece of your dreams.

The **Valley View Trail** is a level trail designed for hiking, biking and equestrian activities. The trail, most of which is paved, is two miles long and begins and ends at the Springhouse.



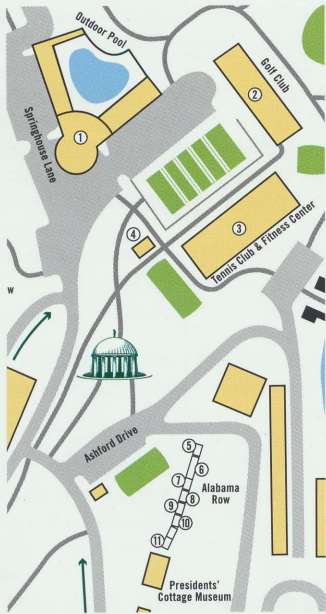

1. Spa & Swim Shop  
*Swimwear & body care products*
2. Golf Pro Shop at the Golf Club  
*Featuring Lilly Pulitzer, Polo, Nike & Adidas*
3. The Tennis Shop at the Tennis Club  
*Featuring Under Armor, Lacoste & Lija*
4. The Garden Gallery  
*Indoor & outdoor garden & home accessories*
5. Virtu  
*Creative jewelry & glass artwork*
6. Gibson's  
*Fine brass & inlaid stone accessories*
7. Studio 40  
*Silk & linen outerwear & accessories*
8. Atlantis Leather  
*Fine leather bags & leatherwork*
9. Joseph Mendel  
*Period furniture & innovative designs*
10. The Pottery  
*Clay creations with distinctive details*
11. Mackenzie Dow  
*17th- & 18th-century inspired wood furnishings*

## THE ART COLONY SHOPS

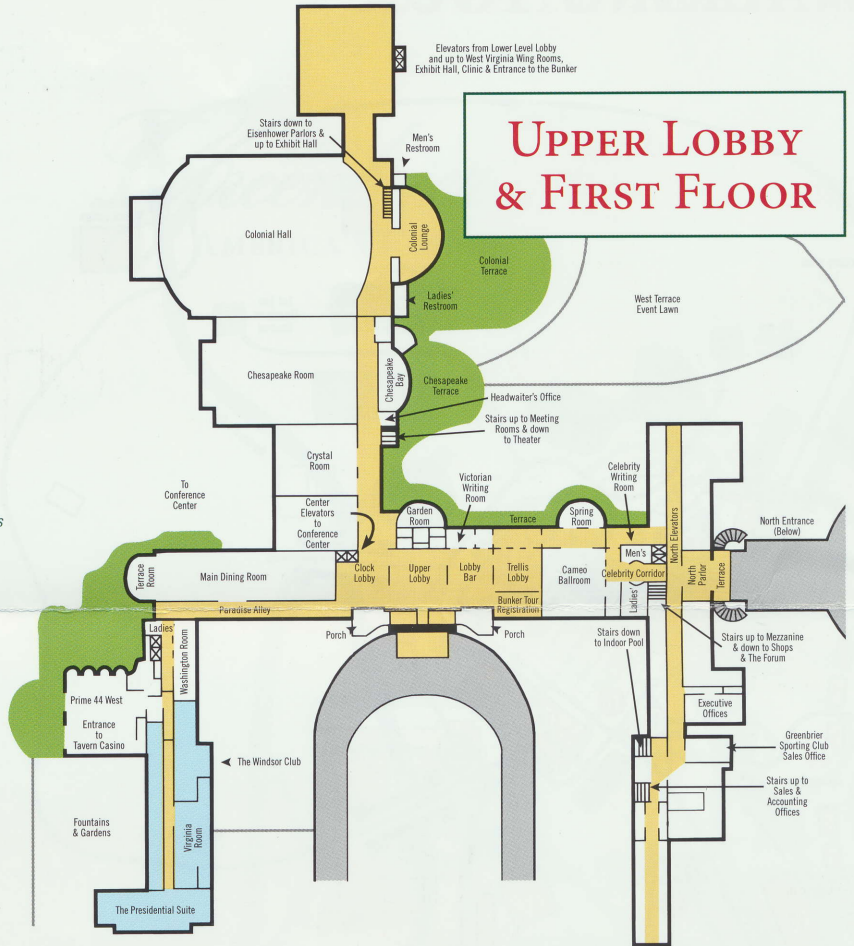

## UPPER LOBBY & FIRST FLOOR

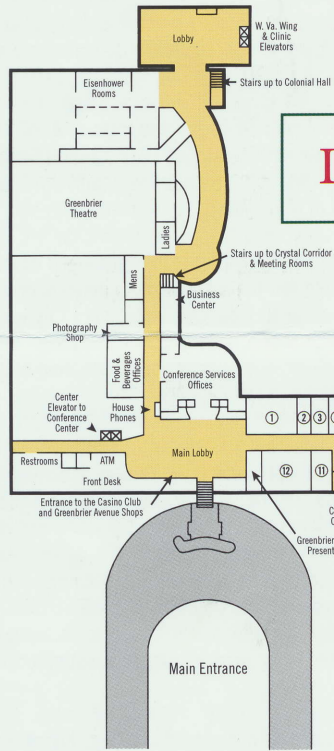

## LOWER LOBBY

1. The Greenbrier Shoppe & Newsstand  
*Greenbrier signature merchandise & gifts*
2. The Greenbrier Classic Shop  
*Officially licensed Greenbrier Classic merchandise*
3. Yarid's  
*Quality shoes in fashion styles*
4. Crepe Myrtle Bags & Beads  
*Featuring Vera Bradley, Brighton & Pandora*
5. My Sister's Circus  
*Children's fashions by Lilly Pulitzer, Ralph Lauren & Catimini*
6. The Greenbrier Gourmet  
*Kitchenware by Le Creuset Cookware & Wusthof Cutlery*
7. Carleton Varney Gift Gallery  
*Décor designs from Gallery Limoges, Bernardaud & Carleton Varney*
8. The Colony Gallery  
*Artwork from the Art Colony Shops*
9. The Jeweler  
*Jewelry by Miseno, Suna & exclusive Greenbrier charms*
10. Ralph Lauren  
*Apparel & accessories by Ralph Lauren*
11. Wicket's  
*Resort wear by Trina Turk, Juicy Couture, & Lilly Pulitzer*
12. Bellissima  
*Collections by Lafayette 148, Joseph Ribkoff & Badgley Mischka*

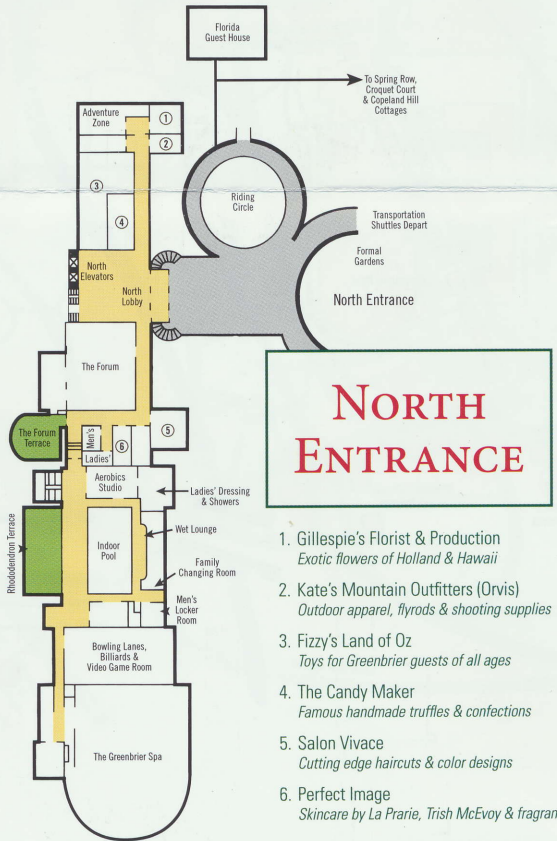

## NORTH ENTRANCE

1. Gillespie's Florist & Production  
*Exotic flowers of Holland & Hawaii*
2. Kate's Mountain Outfitters (Orvis)  
*Outdoor apparel, flyrods & shooting supplies*
3. Fizzy's Land of Oz  
*Toys for Greenbrier guests of all ages*
4. The Candy Maker  
*Famous handmade truffles & confections*
5. Salon Vivace  
*Cutting edge haircuts & color designs*
6. Perfect Image  
*Skincare by La Prairie, Trish McEvoy & fragrances*

# CONFERENCE CENTER



# CASINO MEZZANINE LEVEL

