

# North Mississippi Refuges Complex:

Coldwater River, Dahomey, Tallahatchie  
National Wildlife Refuges  
Hunting and Fishing  
Regulations 2020-2021

This is Not a Permit

## **Welcome**

The North Mississippi Refuges Complex was established in 1989 to manage U.S. Fish and Wildlife Service lands in the northern twenty-six counties of Mississippi. Headquartered in Grenada, the Complex manages Coldwater River, Dahomey, and Tallahatchie National Wildlife Refuges, plus smaller fee-title properties and easements. A total of 16,147 refuge-acres and an additional 9,500 acres of fee-title tracts are managed to conserve and restore bottomland hardwood forest and other wetlands to benefit waterfowl and other wildlife.

### North Mississippi Refuges Complex

2776 Sunset Drive

Grenada, MS 38901

662-226-8286

<http://www.fws.gov/refuge/dahomey>

[http://www.fws.gov/refuge/coldwater\\_river](http://www.fws.gov/refuge/coldwater_river)

<http://www.fws.gov/refuge/tallahatchie>

The refuge is part of the National Wildlife Refuge System, a national network of lands and waters managed for the benefit of wildlife and people. <http://www.fws.gov/1-800-344-WILD>

## **General Information**

### **Safety**

During Refuge deer firearms seasons (including primitive weapons and youth gun hunts) all hunters and visitors must wear in full view a minimum of 500 square inches of solid unbroken fluorescent orange. Waterfowl hunters and nighttime raccoon hunters are exempt from this requirement and do not need to wear fluorescent orange. When hunting quail, rabbit, or woodcock hunters must wear a fluorescent orange vest or cap at all times.

### **Firearms**

Persons possessing, transporting, or carrying firearms on National Wildlife Refuge System lands must comply with all provisions of State and local law. Persons may only use (discharge) firearms in accordance with refuge regulations (50 CFR 27.42 and specific refuge regulations in 50 CFR Part 32).

All weapons authorized under state law are allowed for Refuge hunts. Shotgun require non-toxic shot.

## Vehicles

Vehicles must not obstruct roads, gates, turn rows, field access ramps, or fire lanes and must be operated only on designated roads. ATVs and UTVs are prohibited.

## Boats

Boats including motorboats, kayaks, and canoes are permitted on Refuge waters. See map for boat ramps. Boats may not be stored overnight on the Refuge. State boating regulations apply.

## Hunting and Fishing Regulations

Hunting and fishing regulations are designed to provide safe recreational opportunities through wise use of renewable wildlife resources. Hunting and fishing are permitted in accordance with Federal regulations governing public use on National Wildlife Refuges as set forth in Title 50 of the Code of Federal Regulations.

State hunting and fishing regulations including shooting hours, methods of take, season bag and possession limits, and license requirements apply unless otherwise stated in this brochure. Consult current Mississippi Department of Wildlife, Fisheries and Parks Regulations for details ([www.mdwfp.com](http://www.mdwfp.com)).

## Access

**WHEN:** General Refuge hours are sunrise to sunset. Hunters may enter the Refuge at 4 am and must exit no later than two hours after sunset except during raccoon and frog hunts.

**WHERE:** Refer to maps in this brochure for locations of open and closed areas.

It is unlawful to hunt within or shoot into a 100' zone along either side of designated roads and parking lots.

## Mobility Impaired Persons

Special facilities are available to mobility impaired hunters at Dahomey NWR on a first come first served basis. A mobility impaired hunter is defined as:

1. A person permanently confined to a wheelchair, or a walker, or
2. A single- or double-leg amputee. Please contact the Complex headquarters for more information.

## Farm Service Agency Tracts

Approximately 4,200 acres acquired through the Farm Service Agency (FSA) are managed by the U.S. Fish and Wildlife Service and are open to small game hunting of rabbit, squirrel, and quail only. All hunting regulations apply. Please see maps. Properties include:

Bolivar County: Goss (543 acres), Hester III (386 acres), & Watts (214 acres)

Quitman County: Trainor (228 acres), Trainor (219 acres), Starr (750 acres), Starr (320 acres) & Savage (40 acres)

Tallahatchie County: Schiele (40 acres) & Castleberry (94 acres)

Sunflower County: Lindsey (204 acres), Povall (180 acres), Povall (80 acres), Povall (422 acres), & Walker (42 acres)

Marshall County: Smith (232 acres)

Leflore County: Robertson (655 acres)

## Permit Information

Hunters and anglers sixteen years of age and older are required to possess a \$15 North Mississippi Refuges Complex Hunting and Fishing Permit. All hunters and anglers under 16 years of age must be in the presence and under the direct supervision of a licensed or exempt hunter at least 21 years of age.

A North Mississippi Refuges Complex Hunting and Fishing Permit (license code 606) can be purchased from any state license vendor or from the Mississippi Department of Wildlife, Fisheries and Parks website at <http://www.mdwfp.com/license/hunting-license.aspx>. The permit is good one year from the date of purchase.

Each waterfowl hunter is reminded that they need a Migratory Bird Conservation Hunting Stamp also known as a Federal Duck Stamp to take migratory waterfowl. Migratory bird hunters sixteen years and older must possess a valid Federal Duck Stamp validated by their signature written by him/herself in ink across the face of the stamp prior to their taking such birds. Hunters that purchase a Federal Electronic Duck Stamp must have a traditional signed Federal Duck Stamp on his/her person after 45 days of purchase.

## Harvest Reporting

Each permitted hunter must complete a Harvest Report (FWS form 3-2359) card and display it on the dash of the vehicle so that the name is legible and clearly visible from the outside. Cards are available at any of the Refuge hunt kiosks (see map). Prior to leaving the Refuge, the card must be completed and deposited at a Refuge hunt kiosk. Any species not listed on the card should be reported in the "Other" section. Indicate "0" harvested if no game was harvested. Incorrect information reported on Harvest Report cards or failure to return the card after hunting could result in a Violation Notice and/or a seizure and/or forfeiture of harvested game. A hunter cannot possess more than one Harvest Report card at a time.

## Pets/Domestic Animals

Dogs are allowed for hunting migratory birds, squirrels, rabbits, quail, and raccoons during designated seasons only. The use of dogs is encouraged to retrieve dead or wounded waterfowl. Dogs must remain in the control of their handlers at all times, and be tagged with the owner's name and contact information. Dogs are not allowed on Refuge properties outside of hunting season.

All other domestic animals are prohibited.

## Deer Hunting

Deer hunting is prohibited in agriculture and open fields. These areas are designated on the brochure maps.

Organized drives for deer are prohibited.

Buckshot is prohibited.

Baiting, possession of bait in the field, and/or hunting over bait is prohibited.

## Tree Stands/Blinds

It is illegal to construct or hunt from any permanent stand or blind on the Refuge. Valid permit holders are allowed to possess and hunt from one portable stand or blind on the Refuge. Hunters must clearly label stands/blinds with their State license/sportsmen's identification number. Stands/blinds left on the Refuge do not reserve hunting locations. Stands/blinds may be placed seven days prior to the hunt and must be removed no more than seven days after the Refuge's deer season closes. Blinds may not be placed along trails and firebreaks. Stands/

blinds not in compliance with these regulations may be confiscated and disposed of by the Refuge staff.

Deer stands and/or steps cannot be nailed to trees nor can any blind/stand be attached to a tree by any metal object driven, screwed, or otherwise inserted into the tree.

When climbing a tree, installing a tree stand that uses climbing aids, or while hunting from a tree stand, hunters must use a fall-arrest system that is manufactured to Treestand Manufacturers Association standards.

## Chronic Wasting Disease (CWD)

Tallahatchie NWR lies within the CWD quarantine zone which prohibits movement of carcasses outside of the zone. Hunters may submit tissue from their deer for CWD testing at one of the Mississippi Department of Wildlife, Fisheries and Parks' CWD sampling sites. Deer harvested at Tallahatchie NWR may be taken to the Malmaison WMA headquarters in Leflore County. Deer harvested at Dahomey NWR may be taken to the Dahomey NWR headquarters on Highway 446. Testing is voluntary. For more information visit [www.mdwfp.com/wildlife-hunting/chronic-wasting-disease](http://www.mdwfp.com/wildlife-hunting/chronic-wasting-disease).

## Waterfowl Hunting

Waterfowl (ducks, teal, mergansers, coots, and geese), rail, and snipe hunting are allowed during specified state seasons on Wednesdays, Saturdays, and Sundays, thirty minutes before sunrise until noon. After duck season closes, light geese may be hunted on Wednesdays, Saturdays, and Sundays until noon during the time period and in the manner defined in the Light Goose Conservation Order. A free permit number (along with refuge permit) is required to hunt light geese during the Conservation Order.

Hunters may possess a maximum of 25 shotshells per person in the field, including waterfowl hunters using refuge boat ramps. Decoys, blinds, and spent shells must be removed following each day's hunt.

Farm Service Agency Tracts are closed to waterfowl hunting.

## Fishing Regulations

All federal and state regulations governing creel limits and licenses must be followed.

Commercial fishing is prohibited. Snagging is prohibited. Trotlines, yoyos, limb lines, and crawfish traps are permitted for recreational use only and must be checked every 24 hours. These devices must be legibly marked with the angler's State fishing license number. End of trotlines must be attached by a length of cotton line which extends into the water. Those lacking cotton line, having exposed hooks, or left untended for longer than 24 hours are subject to removal by Refuge staff.

Fishing is permitted in the borrow pits at Coldwater River NWR; south of Highway 8 at Tallahatchie NWR; and in all waters at Dahomey NWR. Fishing is also permitted on the following Farm Service Agency tracts: north of the Corps levee on the Robertson (655 acres) tract in Leflore County; the Trainor (219) & Lindsey (204) tracts in Sunflower County; and the Starr (750) tract in Quitman County.

### **PROHIBITED ACTIVITIES**

- USE OR POSSESSION OF ALCOHOL
- FIRES, CAMPING, OVERNIGHT PARKING, OR LITTERING
- COMMERCIAL ACTIVITIES INCLUDING GUIDING OR PARTICIPATING IN A PAID GUIDED HUNT
- SEARCHING FOR OR REMOVING ANY OBJECT OF ARCHAEOLOGICAL OR HISTORICAL SIGNIFICANCE INCLUDING ARROWHEADS, POTTERY, OR OTHER ARTIFACTS, AS WELL AS ANY NATURAL MATERIALS SUCH AS PLANTS, MUSHROOMS, BERRIES, AND ANTLER SHEDS
- USE OF FLAGGING TAPE, BRIGHT EYES, OR OTHER TRAIL MARKING DEVICES
- REMOVAL OR DESTRUCTION OF ANY TREES, OR PART OF A TREE TO INCLUDE LIMBS OR OTHER VEGETATION ON THE REFUGE FOR ANY REASON
- TARGET SHOOTING
- FIELD DRESSING GAME OR HOGS WITHIN 300' OF ANY ROAD, TRAIL OR PARKING LOT
- LEAVING PERSONAL PROPERTY (EXCEPT LEGAL DEER STANDS) ON A REFUGE

Hunt Type	Season Dates	Harvest	Hunt Areas	Other Regulations
<b>DEER</b>				
Deer Youth Hunt	State Season	State regulations apply with the following exceptions: Buck only with no antler restrictions (Dahomey NWR)	Open hunt areas at Dahomey and Tallahatchie NWRs	Buckshot prohibited
Deer Archery	October 1 – December 1, 2020	State regulations apply with the following exceptions: Buck only (Dahomey NWR)	Open hunt areas at Dahomey and Tallahatchie NWRs	State regulations apply
Deer Primitive Weapon	State Season	State regulations apply with the following exceptions: Buck only (Dahomey NWR)	Open hunt areas at Dahomey and Tallahatchie NWRs	Youth may use a rifle
Deer General Gun	December 16-31, 2020	State regulations apply with the following exceptions: Buck only (Dahomey NWR)	Open hunt areas at Dahomey and Tallahatchie NWRs	Buckshot prohibited
<b>MIGRATORY GAME BIRDS</b>				
Dove	State season	State regulations apply	Open hunt area at Dahomey and Tallahatchie NWRs	Non-toxic shot required
Waterfowl Youth/Veterans/Active Military	State Season until 12 noon	State regulations apply	Open hunt areas at Coldwater River, Dahomey, and Tallahatchie NWRs	25 shotshell limit per hunter
Waterfowl, rails, and snipe	State Season Wednesday, Saturday and Sunday until 12 noon	State regulations apply; Open seasons include ducks, geese, teal, mergansers, coots, rails, and snipe	Open hunt areas at Coldwater River, Dahomey, and Tallahatchie NWRs	25 shotshell limit per hunter
Woodcock	State Season	State regulations apply	Open hunt areas at Dahomey and Tallahatchie NWRs	Non-toxic shot required
<b>Small Game</b>				
Squirrel Youth	State Season	State regulations apply	Open hunt areas at Dahomey and Tallahatchie NWRs and open FSA tracts	Shotguns require non-toxic shot
Squirrel	State Season	State regulations apply	Open hunt areas at Dahomey and Tallahatchie NWRs and open FSA tracts	Shotguns require non-toxic shot

Squirrel Spring Season	State Season	State regulations apply	Open hunt areas at Dahomey and Tallahatchie NWRs and open FSA tracts	Shotguns require non-toxic shot
Rabbit	State Season	State regulations apply	Open hunt areas at Dahomey and Tallahatchie NWRs and open FSA tracts	Shotguns require non-toxic shot
Quail	State Season	State regulations apply	Open hunt areas at Dahomey and Tallahatchie NWRs and open FSA tracts.	Shotguns require non-toxic shot.
Raccoon	January 1 - February 28, 2021	State regulations apply	Open hunt areas at Dahomey and Tallahatchie NWRs	Shotguns require non-toxic shot
Frog	State Season	State regulations apply	Open hunt areas at Dahomey and Tallahatchie NWRs	State regulations apply
<b>Incidental Take Species</b>				
Feral hog, nutria, beaver, coyote	May be taken incidentally during Refuge hunts with the appropriate weapon and ammunition for that hunt	State regulations apply	Open hunt areas at Coldwater River, Dahomey, and Tallahatchie NWRs and open FSA tracts	The use of electronic calls is prohibited.
<b>ALL OTHER HUNTING SEASONS ARE CLOSED ON THE REFUGES</b>				

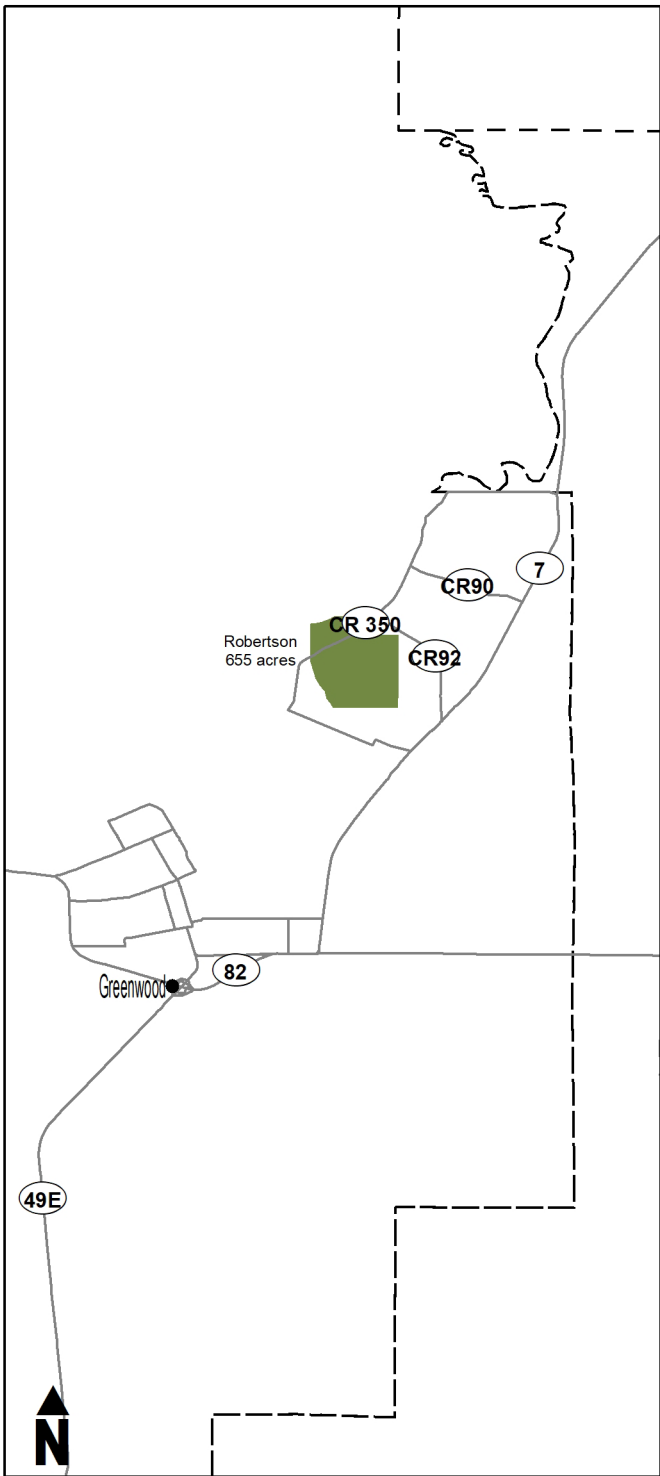

**Leflore County**

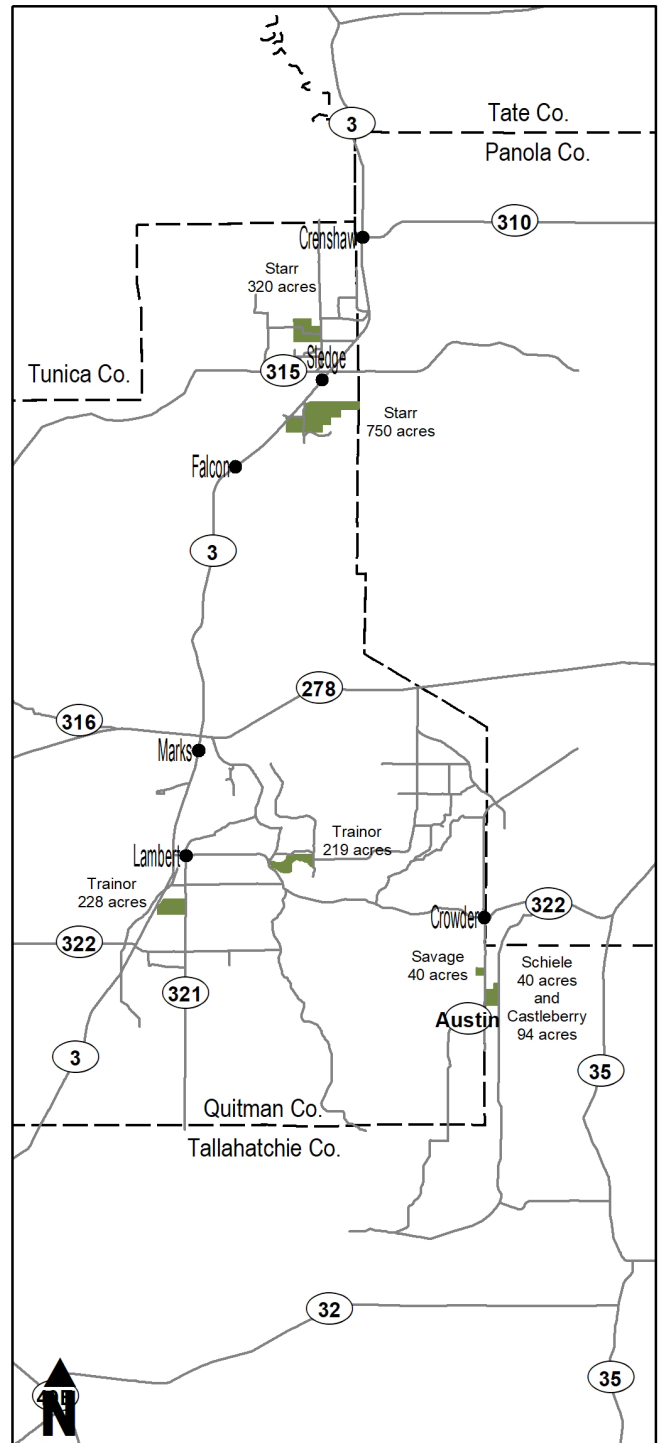
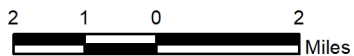

**Quitman and Tallahatchie Counties**

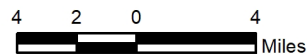



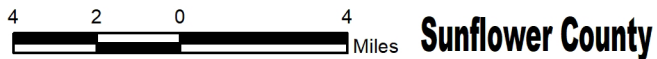
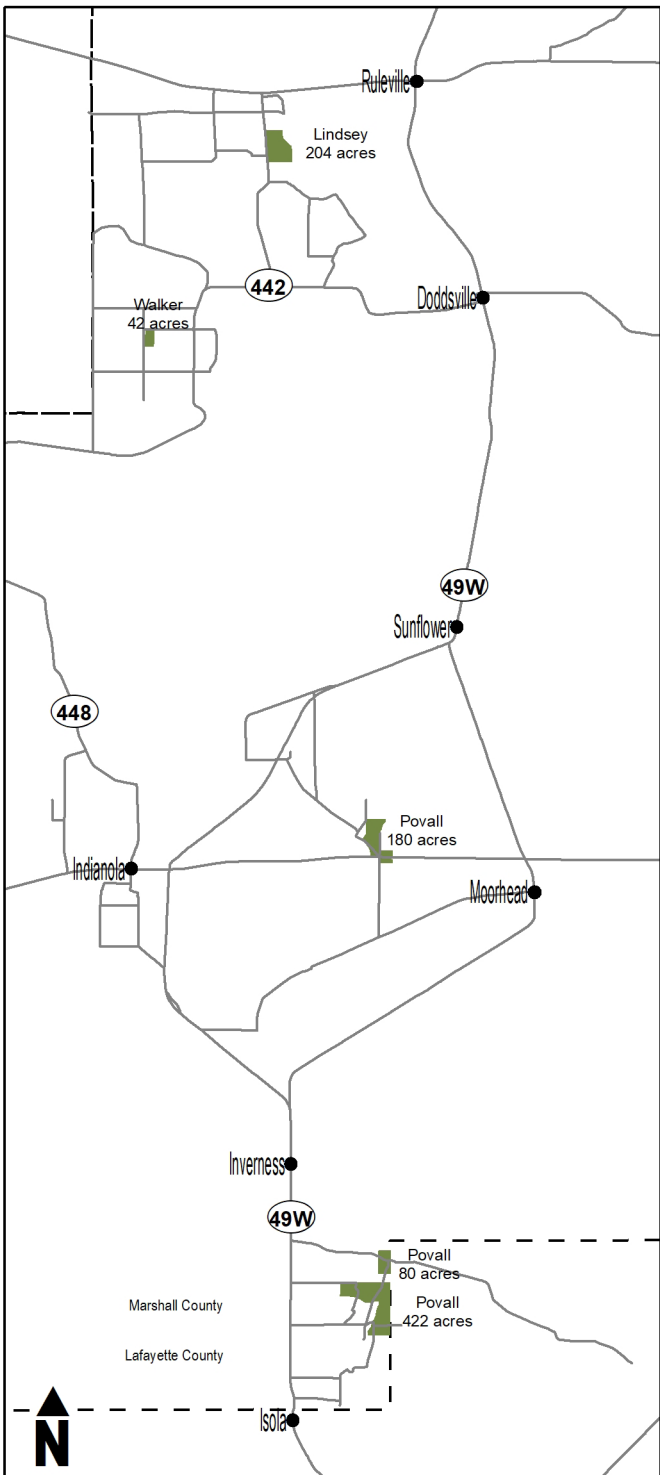

**Sunflower County**

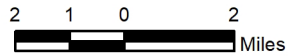
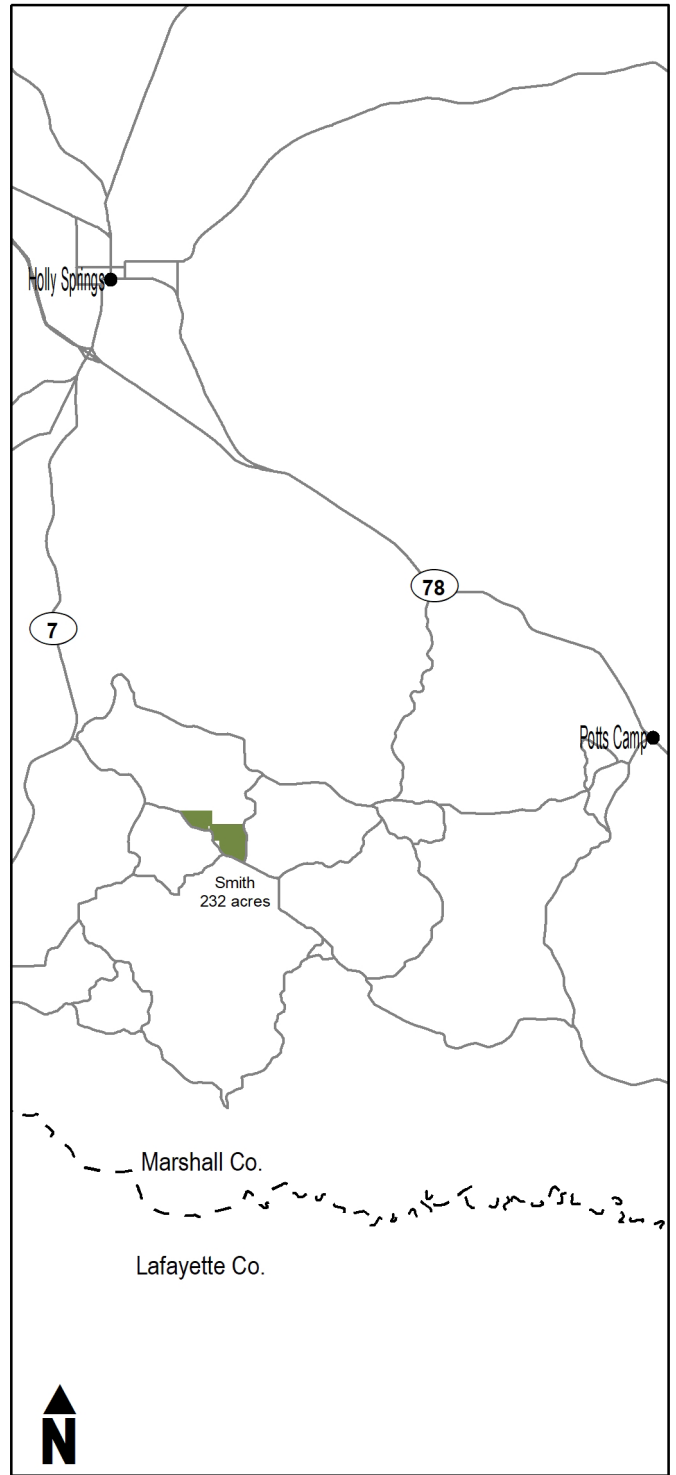

**Marshall County**

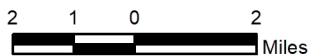
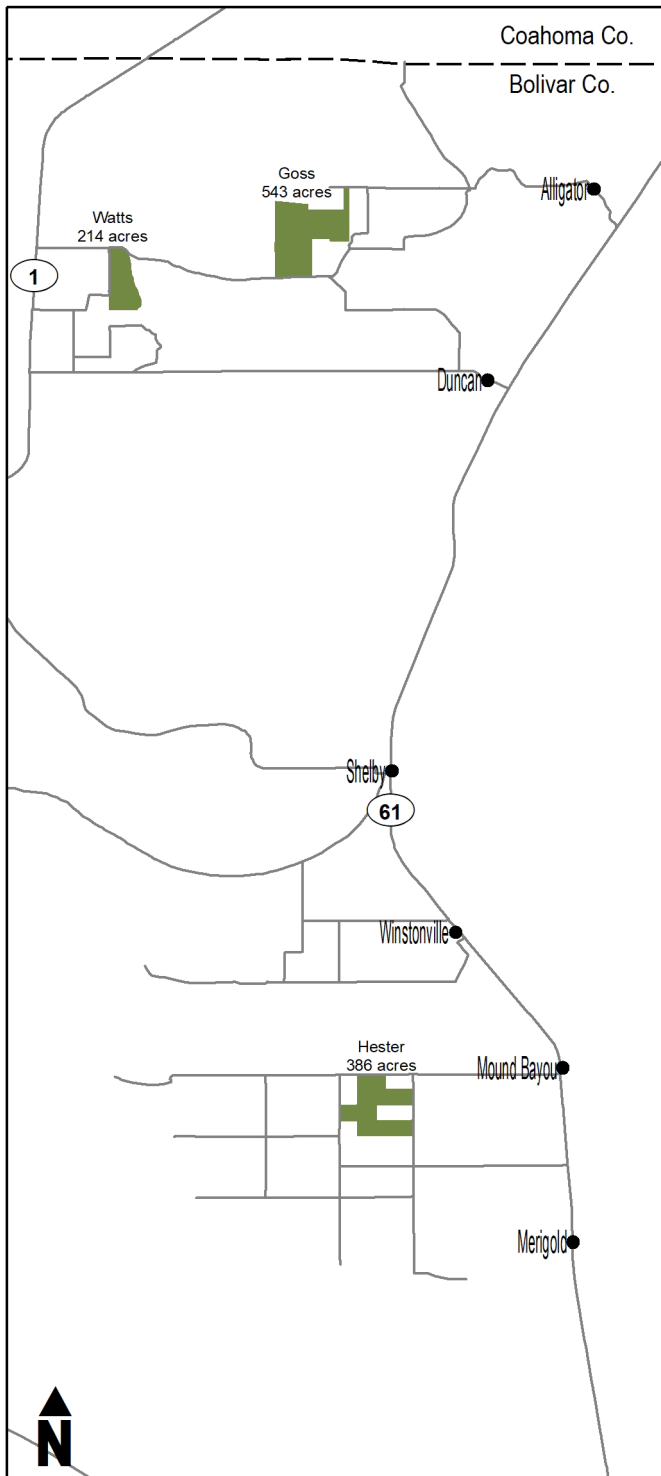

**Bolivar County**

## Signs Protect Visitors and Resources

Millions of people visit National Wildlife Refuges each year. The impact of human activity, if not regulated, can degrade these wildlands. Signs help control recreational activities while protecting natural resources on the Refuge. Please respect the following signs:

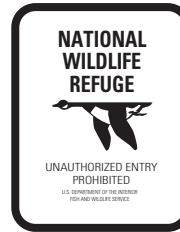

This sign delineates the Refuge boundary. Entry is permitted only for authorized uses in accordance with Refuge regulations. It is your responsibility to know where the property lines are and hunt within the boundaries.



This area is closed to all entry. No roads or trails are open to the public.







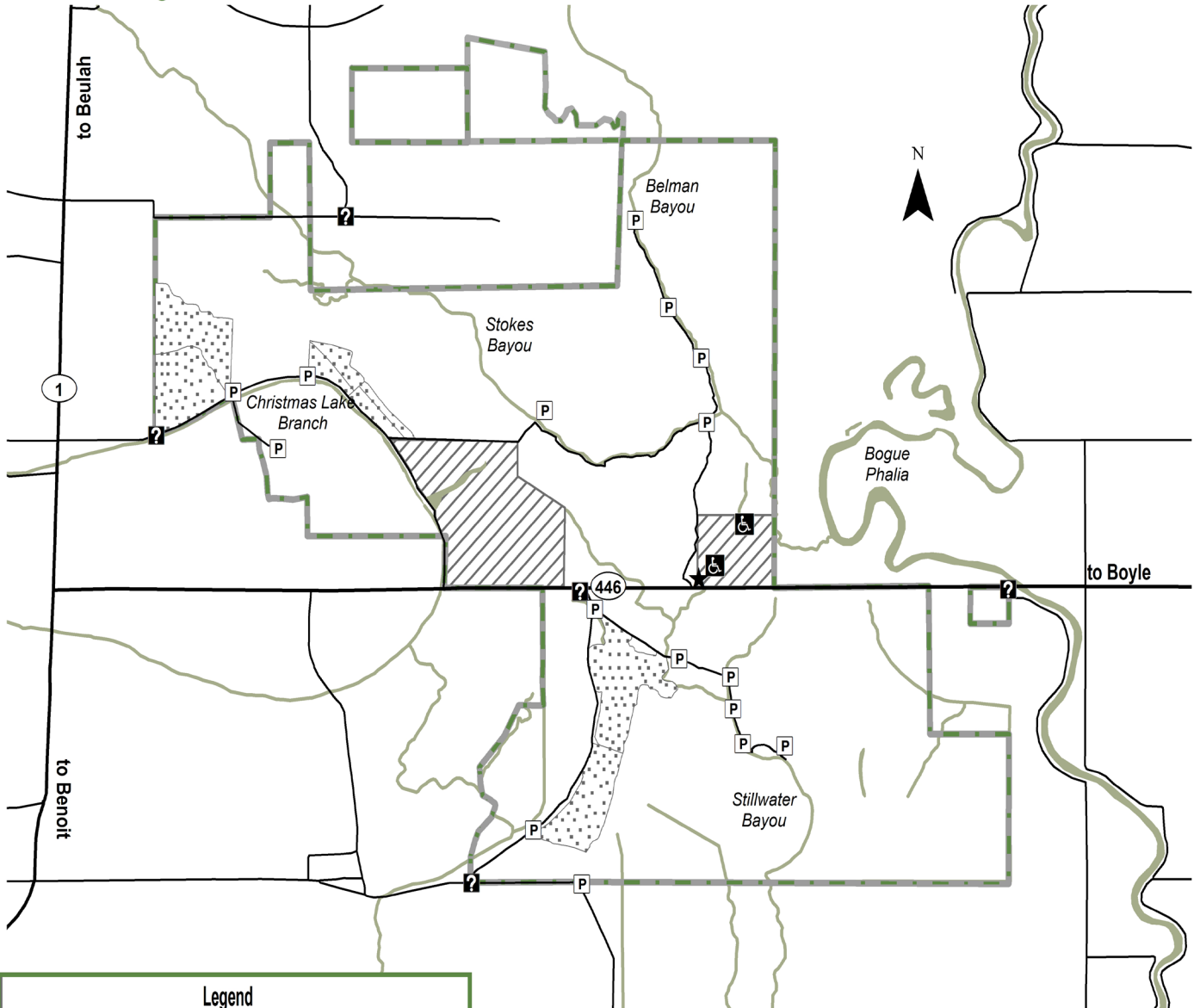





This area is closed to all hunting. Firearms and archery equipment are strictly prohibited.

# Dahomey National Wildlife Refuge



**Legend**







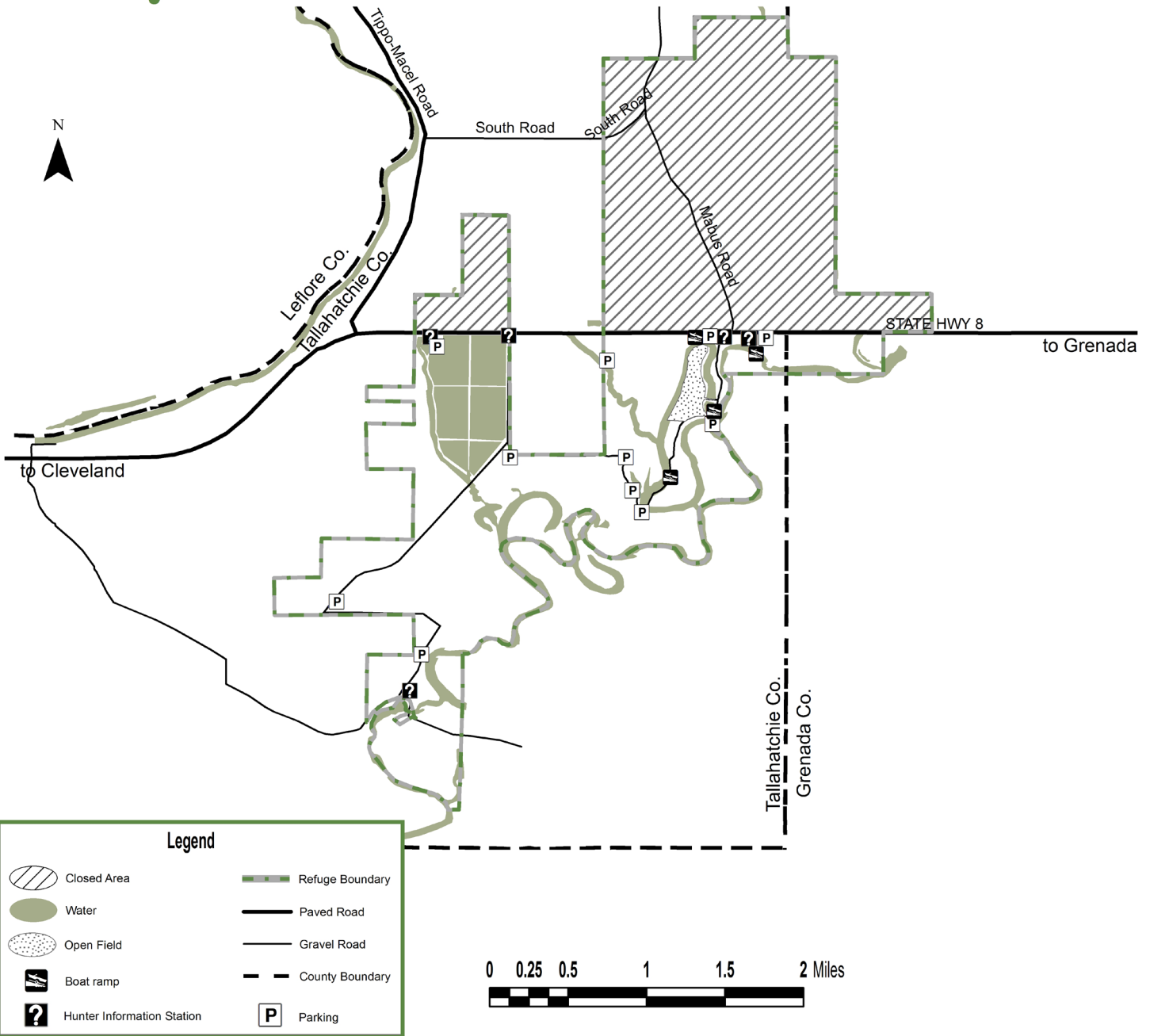

 Closed to Hunting	 Refuge Boundary
 Water	 Paved Road
 Open Field	 Gravel Road
 Refuge Headquarters	 Parking
 Hunter Information Station	 Handicapped Hunting Blind

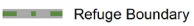

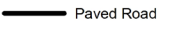
# Tallahatchie National Wildlife Refuge

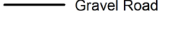

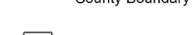
## Legend

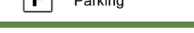
- |  |                            |   |                 |
|--|----------------------------|---|-----------------|
|  | Closed Area                |  | Refuge Boundary |
|  | Water                      |  | Paved Road      |
|  | Open Field                 |  | Gravel Road     |
|  | Boat ramp                  |  | County Boundary |
|  | Hunter Information Station |  | Parking         |







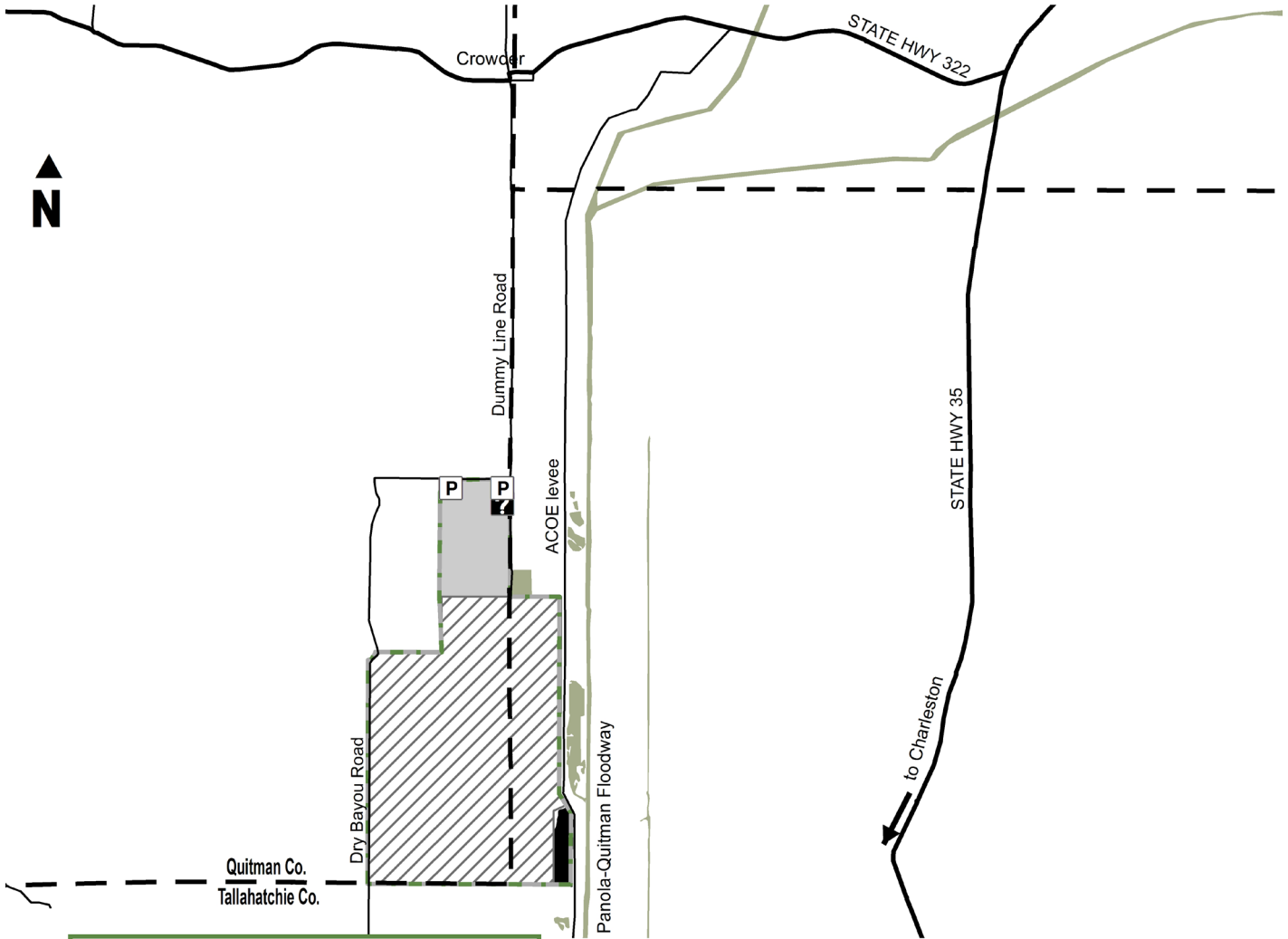



0 0.25 0.5 1 1.5 2 Miles



# Coldwater River National Wildlife Refuge



## Legend

- |   |                            |   |                 |
|---|----------------------------|---|-----------------|
|  | Waterfowl Hunt Area        |  | Refuge Boundary |
|  | Fishing Area               |  | Paved Road      |
|  | Closed Area                |  | Gravel Road     |
|  | Water                      |  | County Boundary |
|  | Hunter Information Station |  | Parking         |





**POACHING IS A CRIME**  
**To Report a Wildlife Crime:**  
**Email: [fws\\_tips@fws.gov](mailto:fws_tips@fws.gov)**  
**Call: 1-844-397-8477**

Help us to protect wildlife and your public lands by reporting wildlife crimes and violations. There are two options for reporting violations 24 hours a day, 7 days a week. You can email [fws\\_tips@fws.gov](mailto:fws_tips@fws.gov) or call 1-844-397-8477 and leave a message. Make sure to include the name of the refuge where the violation occurred and your contact information. Tips may be reported anonymously.

North Mississippi Refuges Complex

P.O. Box 1070

2776 Sunset Drive

Grenada, MS 38901

Phone: 662/226 8286

Fax: 662-226-8488

<http://southeast.fws.gov>

U.S. Fish & Wildlife Service

August 2020

