

Sieur de Monts Springhouse
Bar Harbor Vicinity
(Mt. Desert Island)
Hancock County
Maine

HABS No. ME-173

HABS
ME,
S-BAHA.V,
1-

MEASURED DRAWINGS

Historic American Buildings Survey
National Park Service
Department of the Interior
Washington, D.C. 20240

ME, 5-BAHA. V, 1-

BAR HARBOR VIC.
MT. DESERT ISLAND

35

MAINE
STATE

HANCOCK
COUNTY

TOWN or VICINITY

STRUCTURE SIEUR DE MONTS SPRINGHOUSE

CCN0187
(ME-173)

S end of Great Meadow at Rte. 3 and Park Rd.
Built 1909. 3 sheets (1976, incl. site
plan, plan, roof plan, elevation, section).
NPS

Card prepared 1982

THIS PROJECT WAS UNDERTAKEN BY THE HISTORIC AMERICAN BUILDINGS SURVEY IN COOPERATION WITH THE NORTH ATLANTIC REGIONAL OFFICE OF THE NATIONAL PARK SERVICE. UNDER THE DIRECTION OF JOHN POPPELIERS, CHIEF OF HABS, THE PROJECT WAS COMPLETED DURING THE SUMMER OF 1976 AT THE HISTORIC AMERICAN BUILDINGS SURVEY FIELD OFFICE, ON MOUNT DESERT ISLAND, MAINE, BY JACK W. SCHAFER (UNIVERSITY OF CINCINNATI) PROJECT SUPERVISOR; STEPHEN A. ENGLAND (UNIVERSITY OF CINCINNATI) PROJECT FOREMAN; AND ASSISTANT ARCHITECTS ARTHUR LEE H. EDWARDS (TUSKEGEE INSTITUTE) AND LENNARD ROBERTS (CORNELL UNIVERSITY).

SIEUR DE MONTS SPRINGHOUSE



ADAPTED FROM U.S.G.S. MAP, "ACADIA NATIONAL PARK AND VICINITY, 1971" CONTOUR INTERVAL 100' SCALE 1:125000

TYPICAL ELEVATION

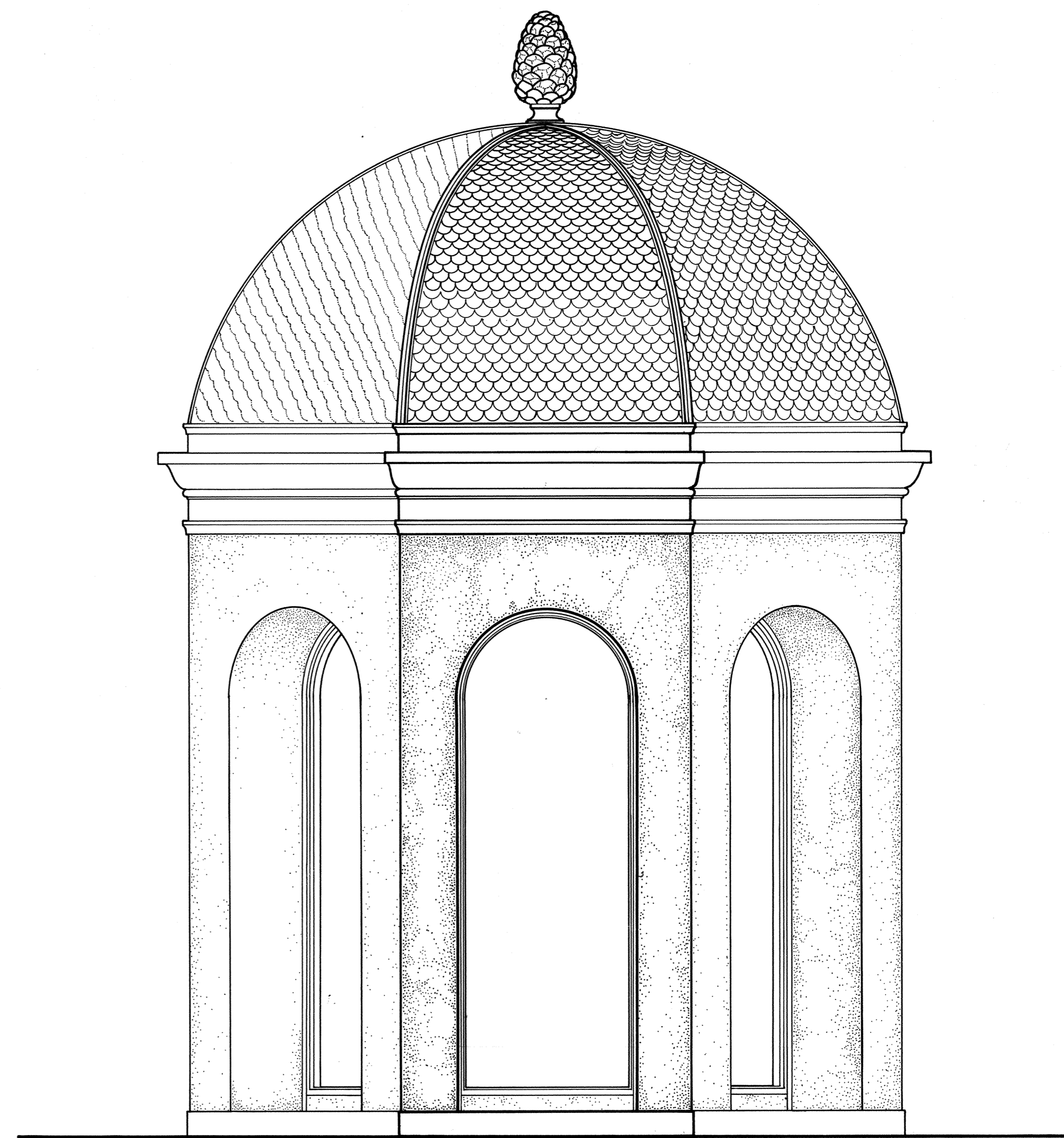

FEET 1/2" = 1'-0" METERS 1:24

ON NOVEMBER 8, 1603, KING HENRY IV OF FRANCE GRANTED A PATENT TO PIERRE DE GUA, SIEUR DE MONTS, GIVING HIM FULL AUTHORITY OVER *LA CADIE* (L'ACADIE OR ACADIA-FRENCH FOR THE INDIAN NAME "THE PLACE") WHICH WAS ALL OF NORTH AMERICA BETWEEN THE 40TH & 46TH PARALLELS. DE MONTS SAILED ON MARCH 7, 1604, WITH SAMUEL DE CHAMPLAIN AS GEOGRAPHER AND BY LATE JUNE HAD ESTABLISHED A SETTLEMENT ON WHAT IS NOW SAINT CROIX ISLAND NATIONAL MONUMENT. IN SEPTEMBER 1604 CHAMPLAIN, WHILE EXPLORING L'ACADIE, DISCOVERED AND NAMED L'ISLE DES MONTS-DÉSERT (ISLAND OF BARE MOUNTAINS), NOW MOUNT DESERT ISLAND. SIEUR DE MONTS SPRINGHOUSE WAS BUILT BY GEORGE B. DORR IN 1909 ON LAND ACQUIRED FOR \$5,000.00. DORR CLEANED THE SPRING, BUILT THE FLORENTINE SPRINGHOUSE AND NAMED IT SIEUR DE MONTS SPRING. AS EXECUTIVE SECRETARY OF THE HANCOCK COUNTY TRUSTEES OF PUBLIC RESERVATIONS, DORR WAS MOST INFLUENTIAL IN ESTABLISHING DE MONTS NATIONAL MONUMENT IN 1916, PREDECESSOR OF ACADIA NATIONAL PARK.

HISTORIC AMERICAN BUILDINGS SURVEY SHEET 1 OF 3 SHEETS
 SURVEY NO. ME-173
 NAME AND LOCATION OF STRUCTURE: SIEUR DE MONTS SPRINGHOUSE
 SOUTH END OF GREAT MEADOW AT ROUTE 3 AND THE PARK ROAD, MT. DESERT ISLAND, HANCOCK COUNTY, MAINE
 DRAWN BY: JACK SCHAFER
 ACADIA NATIONAL PARK PROJECT 1976
 ON BEHALF OF THE NATIONAL PARK SERVICE
 UNITED STATES DEPARTMENT OF THE INTERIOR

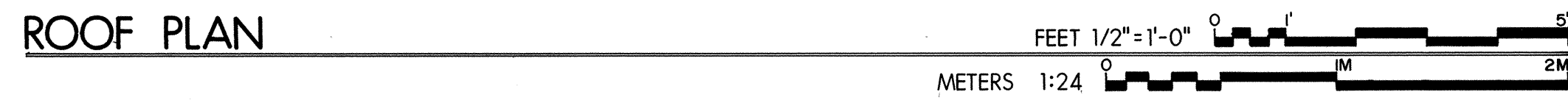
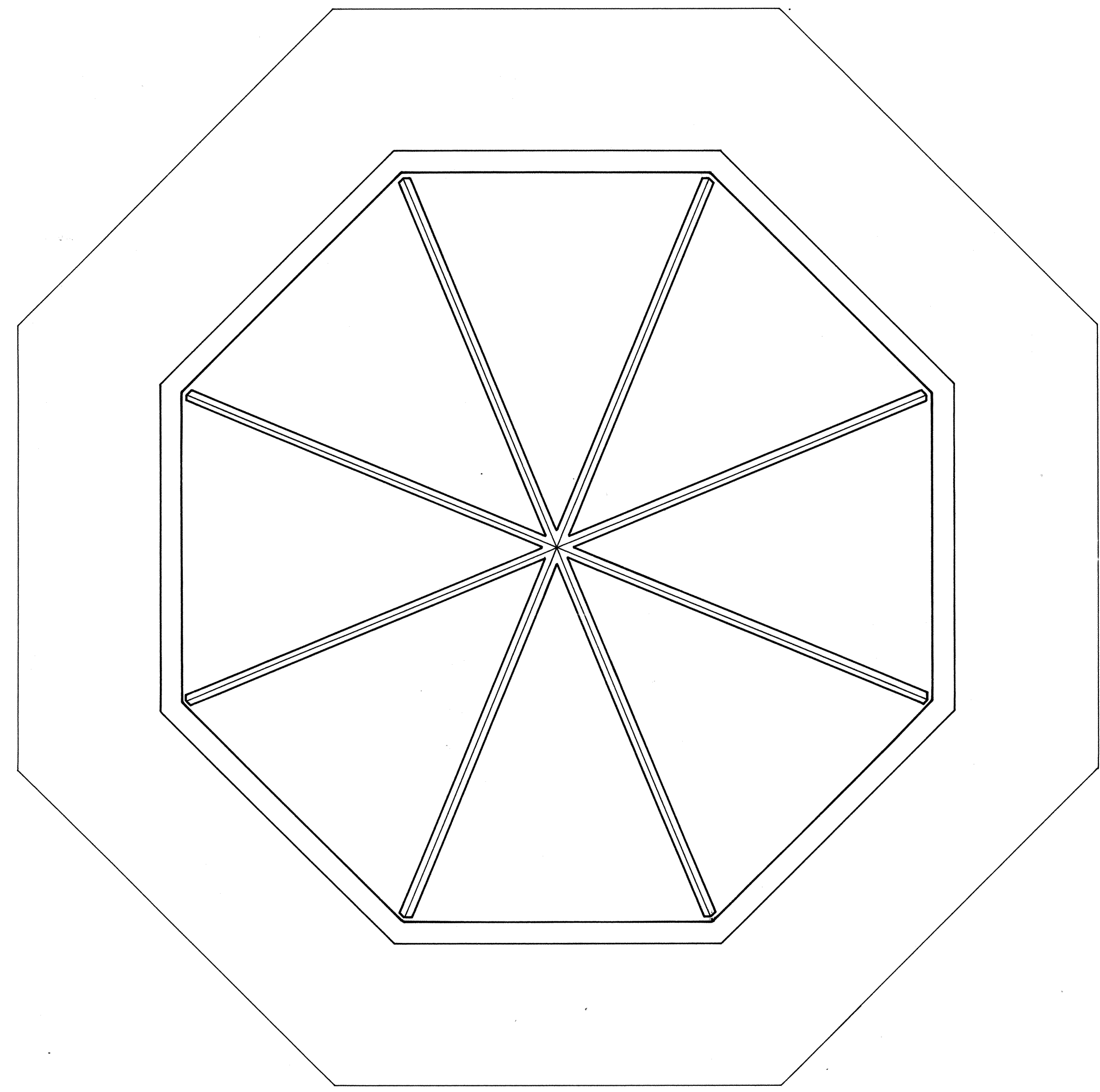
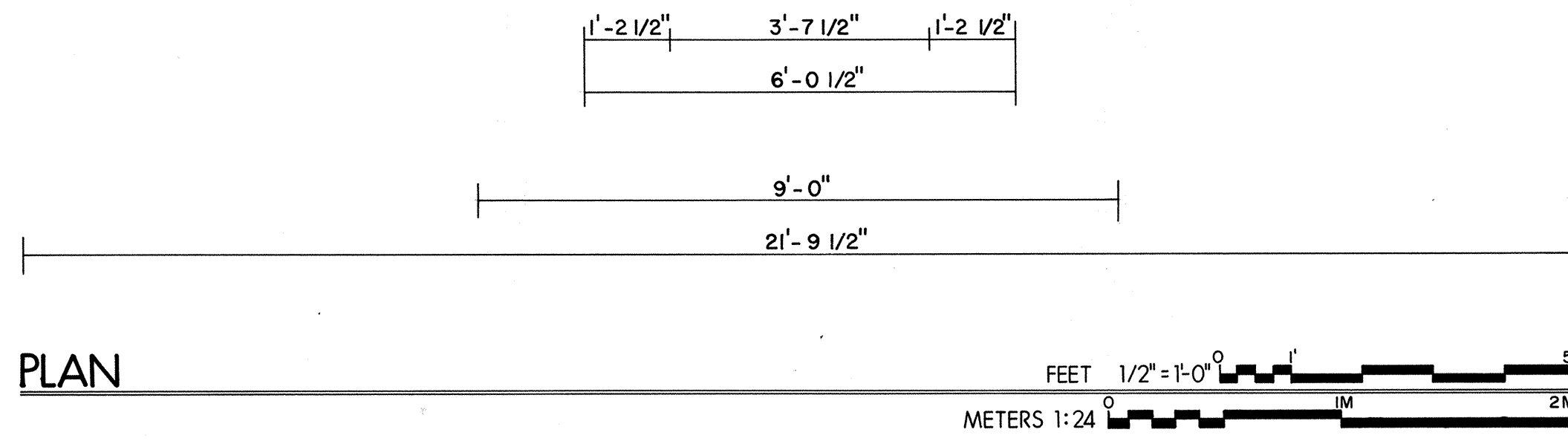
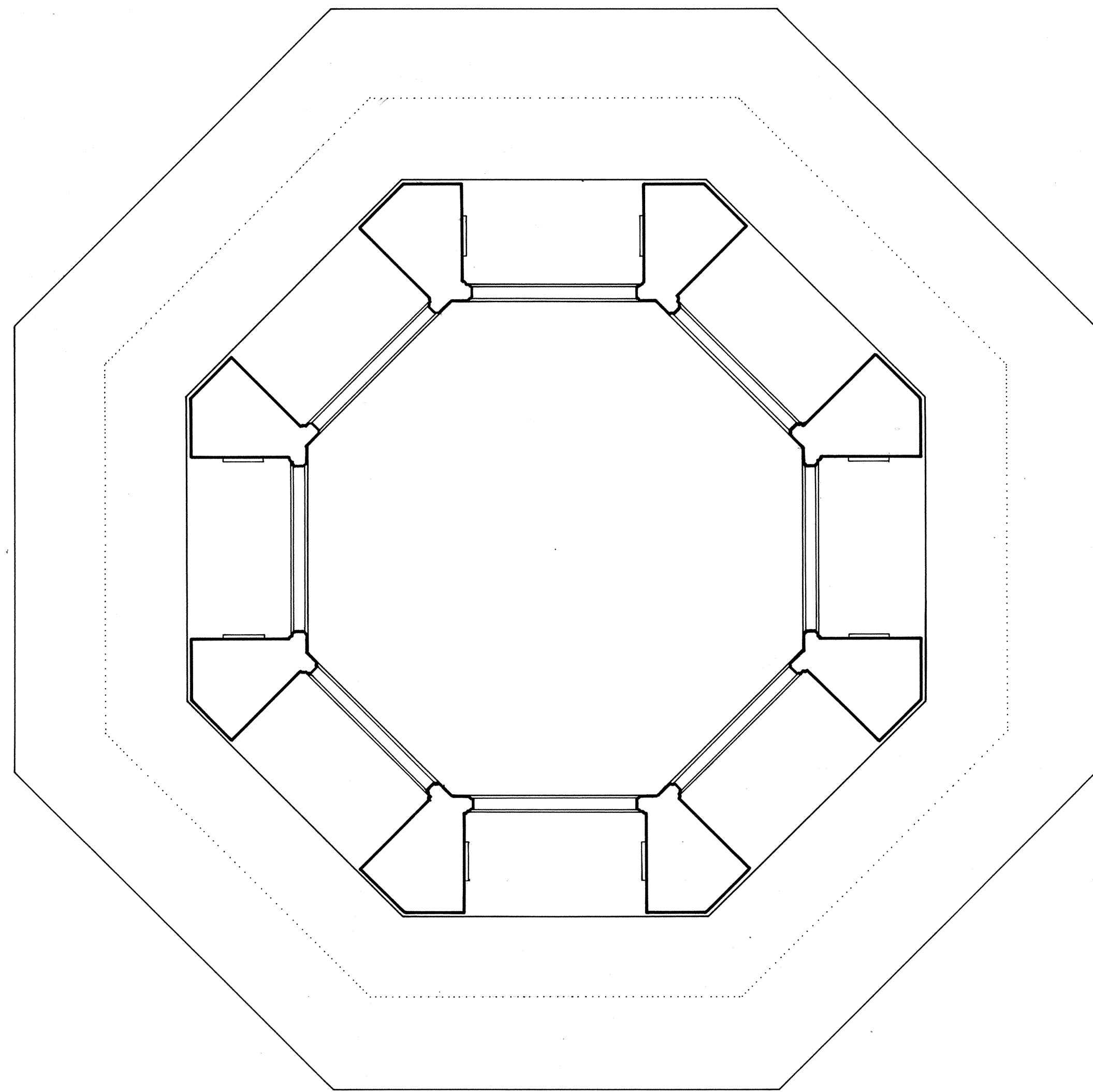

UNIVERSITY OF CONNETQUOT
 ARCHITECTS

HISTORIC AMERICAN
 BUILDINGS SURVEY
 SHEET 2 OF 3 SHEETS

SURVEY NO.
 ME-
 173

NAME AND LOCATION OF STRUCTURE
SIEUR DE MONTS SPRINGHOUSE
 SOUTH END OF GREAT MEADOW AT ROUTE 3 AND THE PARK ROAD, MT. DESERT ISLAND, HANCOCK COUNTY, MAINE

ACADIA NATIONAL PARK PROJECT 1976
 NATIONAL PARK SERVICE
 UNITED STATES DEPARTMENT OF THE INTERIOR

DRAWN BY: JACK SCHAEFER

SITE

TAKEN FROM 'PLAN NO. NP ACA 1109-9, SIEUR DE MONTS SPRING AREA, PART OF THE MASTER PLAN, ACADIA NATIONAL PARK'. ON FILE AT ACADIA NATIONAL PARK HEADQUARTERS. THE MAP DRAWN BEFORE 1937 AND CONSEQUENTIALLY BEFORE THE 1947 FIRE, IS SIGNED 'CONCURRED' BY GEORGE B. DORR THEN SUPERINTENDENT OF THE PARK.

FEET: 1" = 60'

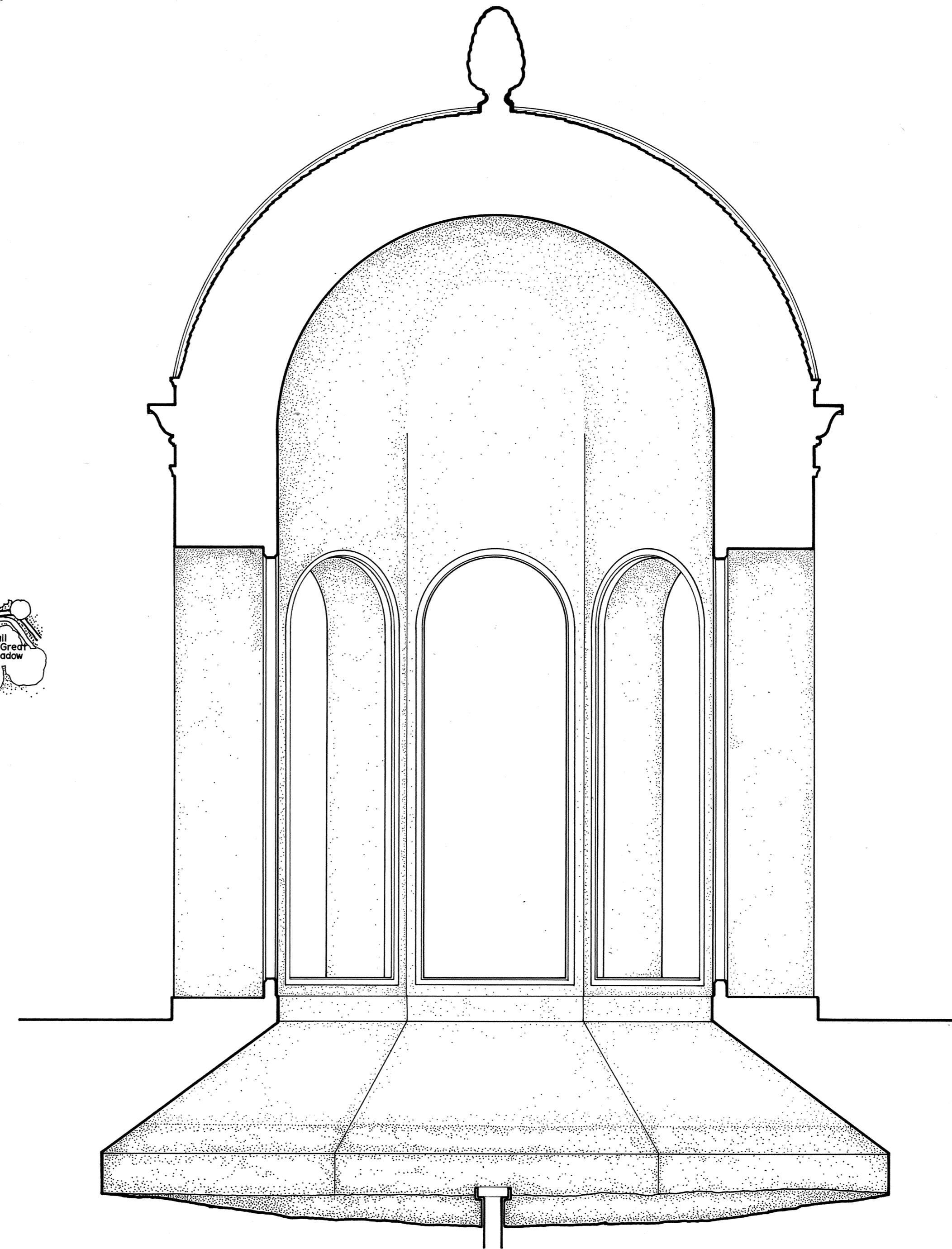
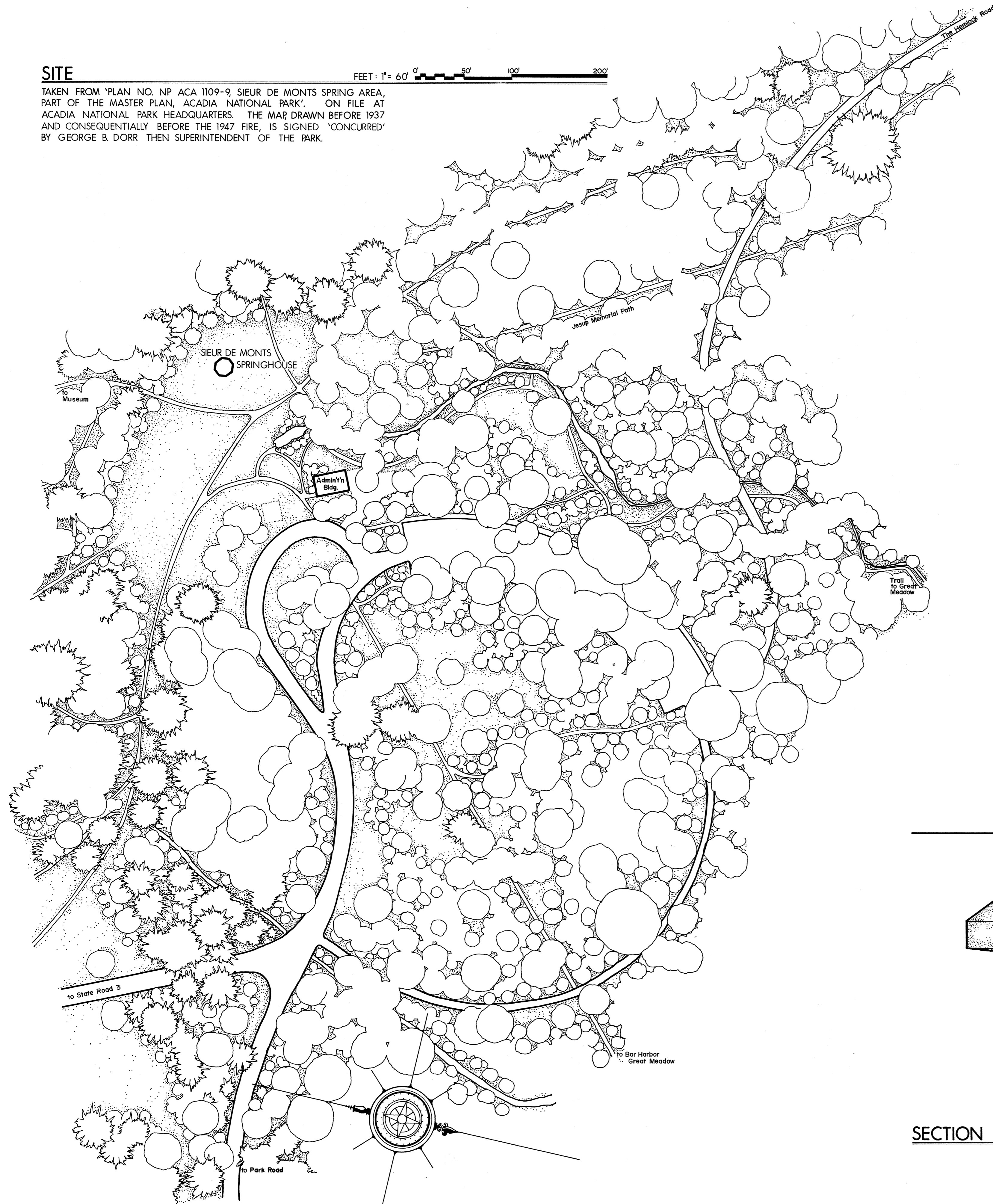
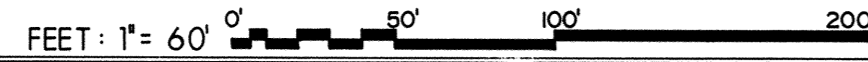

FINIAL - 22'-5"
TOP OF DOME - 20'-11 1/2"
CORNICE - 14'-2 1/2"
TOP OF ARCH SOFFIT - 10'-8"
STEP - 0'-6"
GROUNDLINE - 0'-0"
SPRING LEVEL - -4'-9"

SECTION

FEET 1/2" = 1'-0"

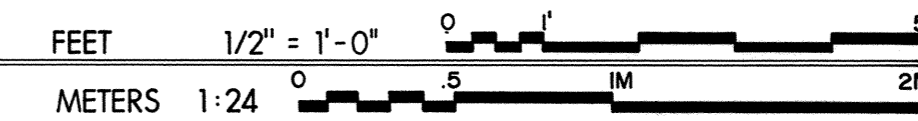

METERS 1:24

DRAWN BY: JACK SCHAFER
 ACADIA NATIONAL PARK PROJECT - 1976
 OFFICE OF ARCHITECTURE AND HISTORIC PRESERVATION
 UNDER DIRECTION OF THE NATIONAL PARK SERVICE
 UNITED STATES DEPARTMENT OF THE INTERIOR
 NAME AND LOCATION OF STRUCTURE
SIEUR DE MONTS SPRINGHOUSE
 SOUTH END OF GREAT MEADOW AT ROUTE 3 AND THE PARK ROAD, MT. DESERT ISLAND, HANCOCK COUNTY, MAINE
 SURVEY NO.
 ME-173
 HISTORIC AMERICAN BUILDINGS SURVEY
 SHEET 3 OF 3 SHEETS