

PREPARED	DATE	DRAWING NO.	550
DESIGNED			28,000
CHECKED		PCIP PKG.	
DRAWN		SHEET	2
DATE			OF 13

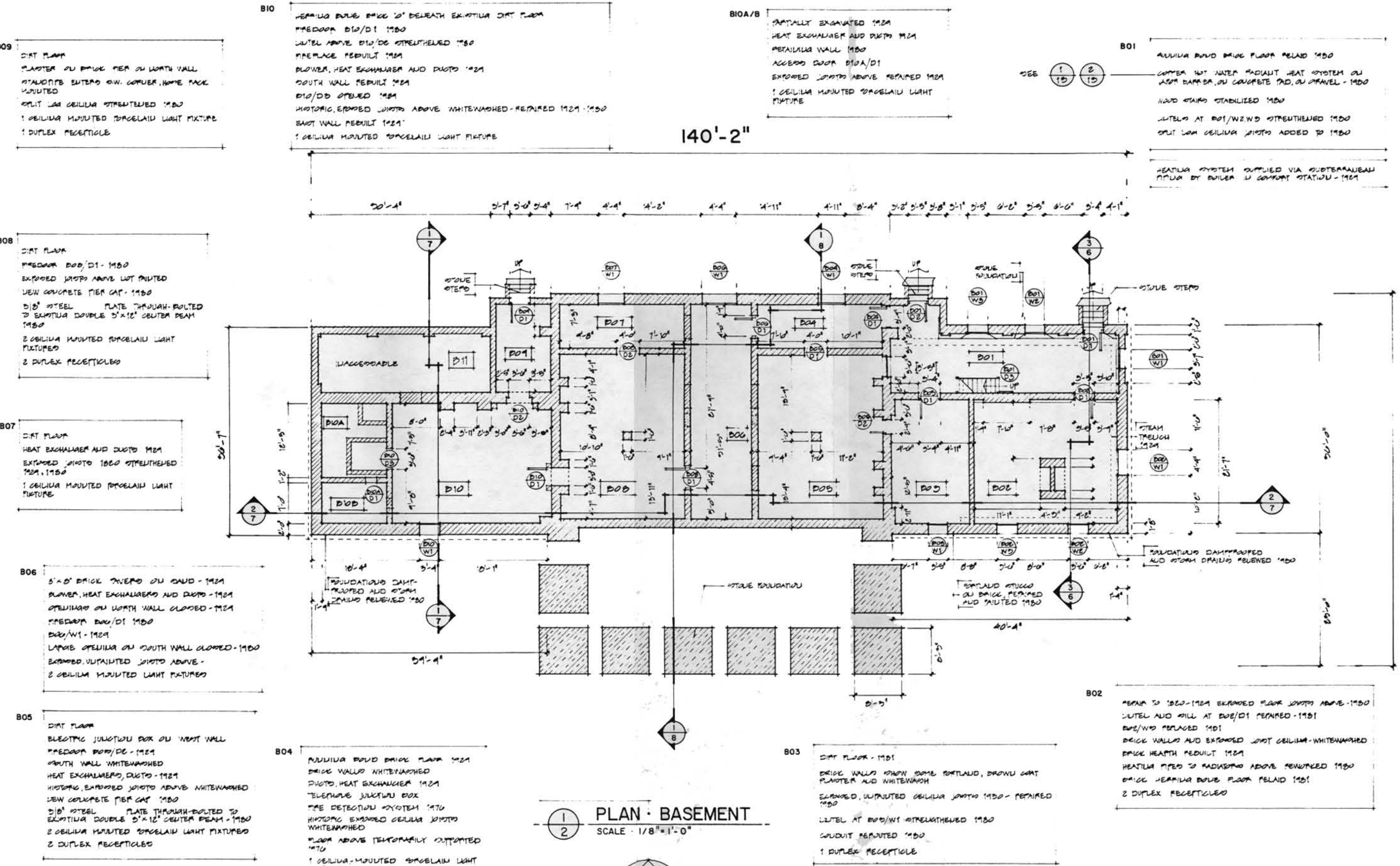

**B09**  
DIRT FLOOR  
PLASTER ON BRICK TIE ON NORTH WALL  
STANDARD ENTERED SW. CORNER, HOME PLACE  
MOUNTED  
SPLIT LAM. CEILING STRENGTHENED 1950  
1 CEILING MOUNTED PORCELAIN LIGHT FIXTURE  
1 DUPLEX RECEPTICLE

**B10**  
HEATING BOILER BRICK 12" DEPTH EXISTING DIRT FLOOR  
FIREDOOR B10/D1 1950  
LITEL ABOVE B10/D2 STRENGTHENED 1950  
FIREPLACE RESULT 1924  
BLOWER, HEAT EXCHANGER AND DUCTS 1924  
SOUTH WALL RESULT 1924  
B10/D3 OPENED 1954  
HISTORIC, EXPOSED JOISTS ABOVE WHITENASHED - RETAINED 1924 - 1950  
EAST WALL RESULT 1924  
1 CEILING MOUNTED PORCELAIN LIGHT FIXTURE

**B10A/B**  
PARTIALLY EXCAVATED 1924  
HEAT EXCHANGER AND DUCTS 1924  
METALLIC WALL 1950  
ACCESS DOOR B10A/D1  
EXPOSED JOISTS ABOVE RETAINED 1924  
1 CEILING MOUNTED PORCELAIN LIGHT  
FIXTURE

**B01**  
MULLION BRICK BRICK FLOOR FELLAD 1950  
COPPER HOT WATER RADIANT HEAT SYSTEM ON  
LARGE BRICK, ON CONCRETE PAD, ON GRAVEL - 1950  
WOOD STAIRS STABILIZED 1950  
LITELS AT B01/W2, W3 STRENGTHENED 1950  
SPLIT LAM CEILING JOISTS ADDED TO 1950  
  
HEATING SYSTEM SUPPLIED VIA SUBTERRANEAN  
PIPING BY BOILER IN GARAGE STATION - 1924

**B08**  
DIRT FLOOR  
FIREDOOR B08/D1 - 1950  
EXPOSED JOISTS ABOVE NOT PAINTED  
NEW CONCRETE TIE CAP - 1950  
510" STEEL PLATE THROUGH-BOLTED  
TO EXISTING DOUBLE 5"x12" CENTER BEAM  
1950  
2 CEILING MOUNTED PORCELAIN LIGHT  
FIXTURES  
2 DUPLEX RECEPTICLES

**B07**  
DIRT FLOOR  
HEAT EXCHANGER AND DUCTS 1924  
EXPOSED JOISTS 1950 STRENGTHENED  
1924, 1950  
1 CEILING MOUNTED PORCELAIN LIGHT  
FIXTURE

**B06**  
5'x5' BRICK TIE ON SAND - 1924  
BLOWER, HEAT EXCHANGER AND DUCTS - 1924  
OPENINGS ON NORTH WALL CLOSED - 1924  
FIREDOOR B06/D1 1950  
B06/W1 - 1924  
LARGE OPENING ON SOUTH WALL CLOSED - 1950  
EXPOSED, UNPAINTED JOISTS ABOVE -  
2 CEILING MOUNTED LIGHT FIXTURES

**B05**  
DIRT FLOOR  
ELECTRIC JUNCTION BOX ON WEST WALL  
FIREDOOR B05/D2 - 1924  
SOUTH WALL WHITENASHED  
HEAT EXCHANGER, DUCTS - 1924  
HISTORIC, EXPOSED JOISTS ABOVE WHITENASHED  
NEW CONCRETE TIE CAP 1950  
510" STEEL PLATE THROUGH-BOLTED TO  
EXISTING DOUBLE 5"x12" CENTER BEAM - 1950  
2 CEILING MOUNTED PORCELAIN LIGHT FIXTURES  
2 DUPLEX RECEPTICLES

**B04**  
MULLION BRICK BRICK FLOOR 1924  
BRICK WALLS WHITENASHED  
DUCTS, HEAT EXCHANGER 1924  
TELEPHONE JUNCTION BOX  
FIRE DETECTION SYSTEM 1970  
HISTORIC EXPOSED CEILING JOISTS  
WHITENASHED  
FLOOR ABOVE TEMPORARILY SUPPORTED  
1970  
1 CEILING MOUNTED PORCELAIN LIGHT  
FIXTURE

**B03**  
DIRT FLOOR - 1951  
BRICK WALLS SHOW SOME PORTLAND, BROWN GRAY  
PLASTER AND WHITENASH  
EXPOSED, UNPAINTED CEILING JOISTS 1950 - RETAINED  
1950  
LITEL AT B03/W1 STRENGTHENED 1950  
CONDUIT RESULT 1950  
1 DUPLEX RECEPTICLE

**B02**  
REPAIR TO 1950 - 1924 EXPOSED FLOOR JOISTS ABOVE - 1950  
LITEL AND MILL AT B02/D1 REPAIRED - 1951  
B02/W3 REPLACED 1951  
BRICK WALLS AND EXPOSED JOIST CEILING - WHITENASHED  
BRICK HEARTH RESULT 1924  
HEATING PIPES TO RADIATORS ABOVE REWORKED 1950  
BRICK HEATING BOILER FELLAD 1951  
2 DUPLEX RECEPTICLES

**PLAN - BASEMENT**  
SCALE: 1/8" = 1'-0"

