

430

United States Department of the Interior  
National Park Service

NATIONAL REGISTER OF HISTORIC PLACES  
REGISTRATION FORM

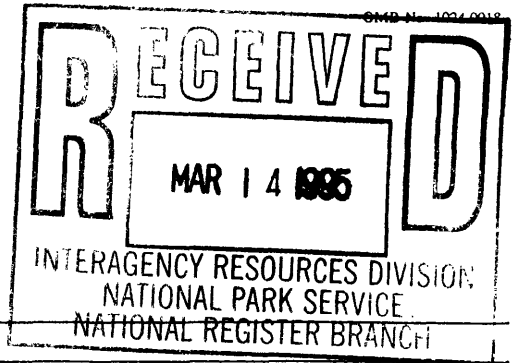

1. Name of Property

historic name: Old Administration Building

other name/site number: Nature Center; Museum; HS-31

2. Location

street & number: Bryce Canyon National Park

not for publication: n/a  
vicinity: X

city/town: Bryce Canyon

state: Utah code: UT county: Garfield code: 017 zip code: 84717

3. State/Federal Agency Certification

As the designated authority under the National Historic Preservation Act of 1986, as amended, I hereby certify that this X nomination \_\_\_ request for determination of eligibility meets the documentation standards for registering properties in the National Register of Historic Places and meets the procedural and professional requirements set forth in 36 CFR Part 60. In my opinion, the property X meets \_\_\_ does not meet the National Register Criteria. I recommend that this property be considered significant \_\_\_ nationally X statewide \_\_\_ locally. ( \_\_\_ See continuation sheet for additional comments.)

[Signature] 3/14/85  
Signature of certifying official Date  
National Park Service  
State or Federal agency or bureau

In my opinion, the property X meets \_\_\_ does not meet the National Register criteria.

[Signature] 2-21-95  
Signature of commenting or other official Date  
Utah State Historic Preservation Office  
State or Federal agency and bureau

4. National Park Service Certification

I, hereby certify that this property is:

- entered in the National Register \_\_\_ see continuation sheet
- determined eligible for the National Register \_\_\_ see continuation sheet
- determined not eligible for the National Register \_\_\_ see continuation sheet
- removed from the National Register \_\_\_ see continuation sheet
- other (explain):

[Signature]  
Signature of the Keeper

4/25/95  
Date of Action

**Old Administration Building**

Name of Property

**Garfield County, Utah**

County and State

**5. Classification**

Ownership of Property: Government-Federal

**Number of Resources within Property**

Category of Property: Building

Contributing

Noncontributing

Number of contributing resources previously listed in the National Register: None

10

building(s)

Name of related multiple property listing: Bryce Canyon National Park Multiple Property Submission

00

sites

00

structures

00

objects

10

Total

**6. Function or Use**

Historic Functions:

Government; government office

Current Function:

Government; government office

**7. Description**

Architectural Classification:

Rustic

Materials:

foundation: Concrete

walls: Wood, log

roof: Wood, shingle

other: Stone

**Narrative Description****Summary and Setting**

The old administration building (HS-31) is located not far from the rim of the Paunsaugunt Plateau, in the vicinity of Sunrise Point Overlook. The front of the building faces east, onto one of the main park access roads. Scattered native pine trees and shrubbery are located in front of the building and the area is surrounded by gravel. The low knoll behind (west) the building is more densely timbered with ponderosa pine. Bryce Inn is located immediately north of HS-31, across a paved parking area.

**Description**

The building is "T" shaped and is constructed on a stone foundation. (Stone footings and steel girders provide structural support beneath the interior floor). The building is joined at the corners with ventral saddle notches. The log ends of this building are finished in "chopper cut" fashion; wherein the ends form a point of two or more sides. In addition, the length of the logs are staggered. The gable ends are infilled with vertically placed logs. Daubing (applied to the longitudinal gaps in the logs) consists of a mixture of lime and portland cement, the latest application having been made in 1987. These design features contribute to the rustic appearance of the building. The logs on the exterior of the building have been stained dark brown. The window trim is painted green.

The original architectural drawings for this building show that two phases of construction were planned from the outset. The first component (represented by the east half of the building) consisted of a single "public" room. This original component has a side facing gable roof. The gable roof of the addition (built to contain office space for the Park Ranger) is oriented perpendicular to that of the original building, forming a cross gable. The roof of both components is covered with wooden shingles, which are doubled very fifth course.

The east elevation contains a central open porch with a cross gable roof, which shelters the entry into the public room of the building. The roof is supported by log columns, and the king post truss is exposed in the pediment. The entry has a modern flush wood door with three staggered lights, paired with a wooden, three-panel screen door.

**Old Administration Building**

Name of Property

**Garfield County, Utah**

County and State

**8. Statement of Significance**

Certifying official has considered the significance of this property in relation to other properties:

Applicable National Register Criteria: A and C

Areas of Significance: Architecture, Government, Recreation

Criteria Considerations (Exceptions): n/a

Period(s) of Significance: 1932-1944

Significant Person(s): n/a

Significant Dates: 1933, 1934

Cultural Affiliation: n/a

Architect/Builder: NPS Branch of Plans and Design

**Narrative Statement of Significance**

The old administration building has statewide significance under National Register Criterion A, for its association with the development of NPS administrative facilities in BRCA. It also possesses significance as an example of NPS rustic architecture. This building is included in the property type defined at "Resources Associated with NPS Administrative Development" which is part of the Bryce Canyon National Park Multiple Property Submission.

The Administration Building represents the first NPS facility constructed within the park to house the administrative activities of NPS personnel. It's placement adjacent to the rim established an administrative presence in an area heavily used by park visitors, and prior to its establishment, controlled by the UPC. This building continues to provide the only NPS presence in the Sunrise Point area. This building is an excellent example of the rustic design preferred by NPS managers for much of the historical period and produced by architects working in the Branch of Plans and Design. The use of log and stone in its construction, and the use of chopper cut log ends, tie the building to the surrounding landscape both in terms of the materials used and their dimensions.

9. Major Bibliographic References

Drawing Nos. NP-BC 2011; NP-BC 2018; NP-BC 2004; B 3007 A; and another with an illegible number. All available from BRCA maintenance files.

Previous documentation on file (NPS):

- \_\_\_ preliminary determination of individual listing (36 CFR 67) has been requested.
\_\_\_ previously listed in the National Register
\_X\_ previously determined eligible by the National Register
\_\_\_ designated a National Historic Landmark
\_\_\_ recorded by Historic American Buildings Survey #
\_\_\_ recorded by Historic American Engineering Record #

Primary Location of Additional Data:

- \_\_\_ State Historic Preservation Office
\_\_\_ Other State agency
\_X\_ Federal agency
\_\_\_ Local government
\_\_\_ University
\_\_\_ Other -- Specify Repository:

10. Geographical Data

Acreege of Property: Less than one acre

Table with 4 columns: UTM References, Zone, Easting, Northing. Values: A 12, 397260, 4165360.

Verbal Boundary Description

The paved curb in front of the building serves as the east boundary. The north, west and south boundaries are drawn to encompass the remaining elevations of the building and its immediate setting.

Boundary Justification

The nominated property includes the area historically used for the administration building.

11. Form Prepared By

name/title: Janene Caywood
organization: Historical Research Associates, Inc. date: December 31, 1994
street & number: P.O. Box 7086 telephone: 406 721-1958
city or town: Missoula state: MT zip code: 59807-7086

Property Owner

name/title: Bryce Canyon National Park
street & number: telephone: 801 834-5322
city or town: Bryce Canyon state: UT zip code: 84717

United States Department of the Interior  
National Park Service

## National Register of Historic Places Continuation Sheet

Section number        7                                Page    1

---

### Old Administration Building Garfield County, Utah

#### Description (continued)

Narrow, eight-light casement windows are located directly adjacent to each side of this entry and are also protected by the porch overhang. The east elevation contains two additional eight-light casement windows, one on either side of the porch.

The north elevation of the building incorporates a variety of windows. A narrow, fixed, six-light, wood frame window is located high in the gable end of the original component. The wall below the gable contains a large picture window flanked on either side by one eight-light casement windows. The north wall of the addition has three six-light casement window, one occurs singly and the other two in a pair towards the west end of the elevation.

The west elevation of the building contains a large picture window flanked on either side by a six-light casement windows, all of which are centered in the wall beneath the gable end. A louvered vent is centered high in the gable end.

The south elevation contains an entry that accesses the interior office space. This entry is located towards the east end of the 1934 component and is protected by a small gable-roof overhang supported by log brackets. Two stone steps lead to the entry which has a vertical tongue and groove door with four fixed lights. A pair of six-light casement windows is located in the wall to the east of the entry. Fenestration in the south elevation of the original (1932) component is identical to the north elevation, namely a fixed, six-light window in the gable end and a picture window flanked by two eight-light casement windows in the ground level wall.

On the interior the wall surfaces are formed primarily by the exposed logs. The exception is the west elevation interior surface of the addition, wherein the log surface has been covered with paneling. The remaining interior log surfaces have been varnished. A new hearth and wood stove are currently located in the public room. This room also contains some portable display cases for NPS literature and plant collections. The original oak floor and wrought iron brackets for the interior truss system remain in place. The light fixtures and ceiling fans in this room are modern.

The interior of the addition (the western component) is divided into two large rooms by an east/west oriented partition. This partition is constructed of 1X6" board and 1X6" tongue and groove paneling. The north half is currently used for storage and the south half is used as a research/office facility by NPS personnel. The 3" board floor is exposed in the storage area, however it is covered with carpet in the office area. A small bathroom with a toilet and sink has been enclosed within the office area. None of the rear rooms are open to the public.

Modifications during the modern period include the application of epoxy "patches" to rotting segments of the chopper cut log ends. In 1987, NPS crews replaced "in kind", the roof and daubing. The interior partition in the addition appears to be modern, however the date of its construction is unknown. Also, the one interior paneled wall likely dates to the modern period.

OLD ADMINISTRATION BUILDING AND BRYCE INN  
BRYCE CANYON NATIONAL PARK

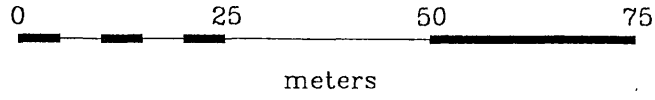

*HRA Project 144-025\nat WRH 8/92*

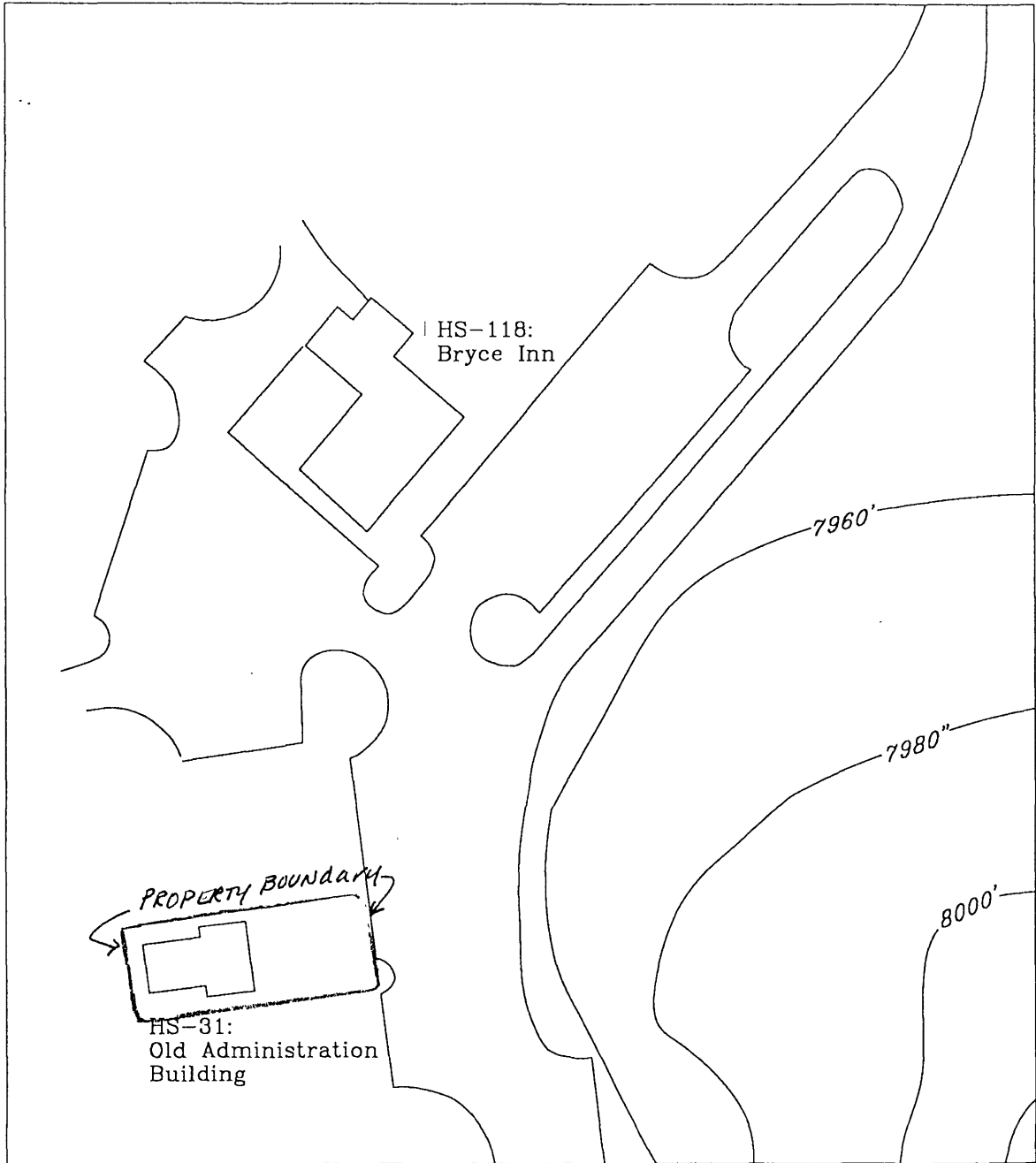

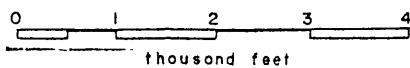
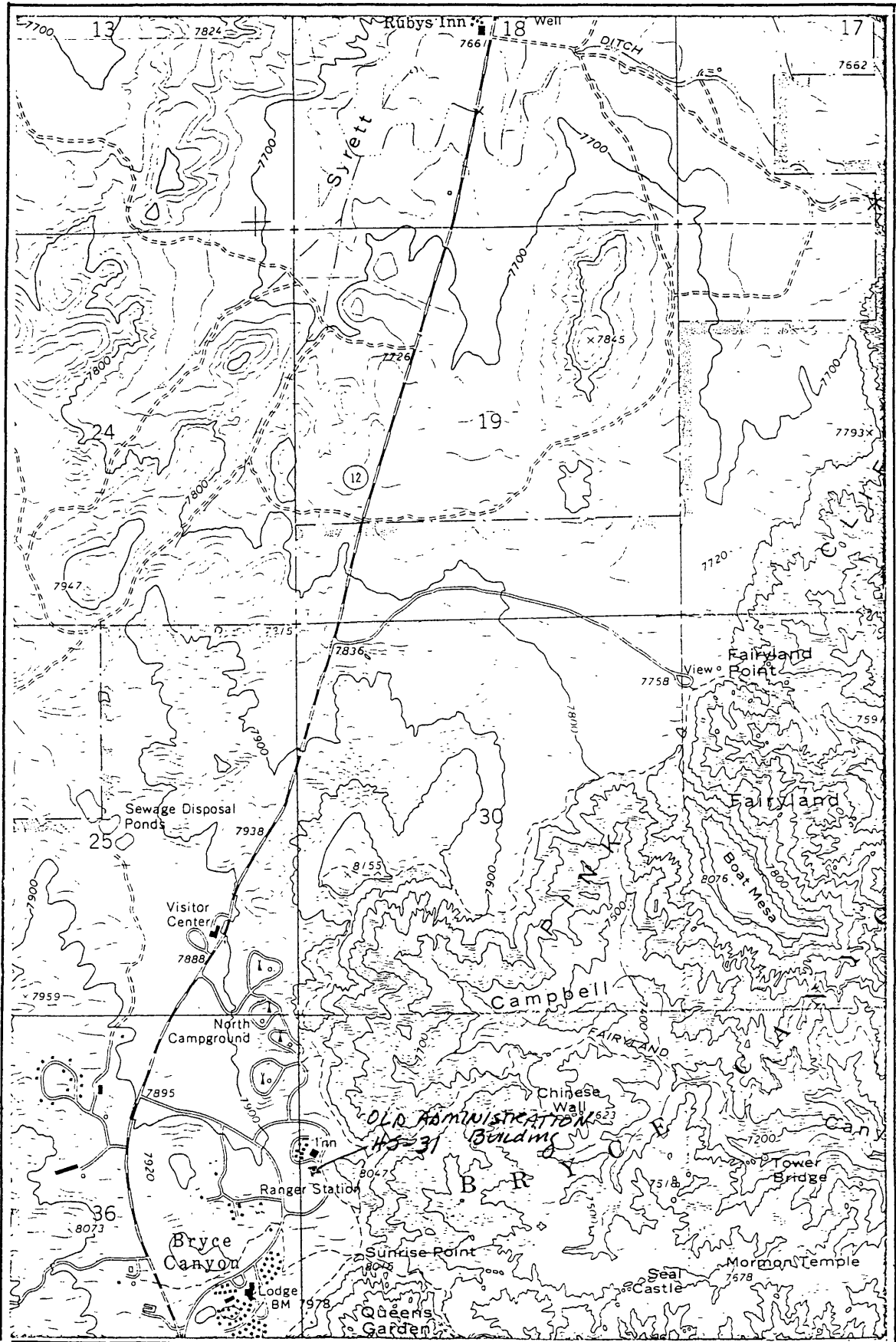

1: 24000



USGS 7.5' Quad BRYCE CANYON, UTAH  
 Sec. 31 T 36S R 3W  
 County GARFIELD

United States Department of the Interior  
National Park Service

## National Register of Historic Places Continuation Sheet

Section number      Photographs      Page    2

---

### Old Administration Building Garfield County, Utah

1. Old Administration Building (Nature Center)
  2. Garfield County, Utah
  3. Janene M. Caywood (HRA, Missoula MT)
  4. June, 1992
  5. NPS Rocky Mountain Regional Office, Denver, Colorado
- (Information in items 1-5 applies to all photos of HS-31)

Photo #1

Looking west to east elevation (main entry).

Photo #2

Looking northwest to south elevation.

Photo #3

Looking southeast to north and west elevations.





SUNRISE NATURE CENTER  
INFORMATION / EXHIBITS

PERMIT BOX



