

U.S. Military Reservation

FLARNED

KANSAS

Surveyed & laid off Sept 1874

BY LIEUT. M. R. BROWN, U.S. CORPS & ENG'G

Chief Engineer, Dept. of the Mo.

Scale 1/2 in to 1 mile

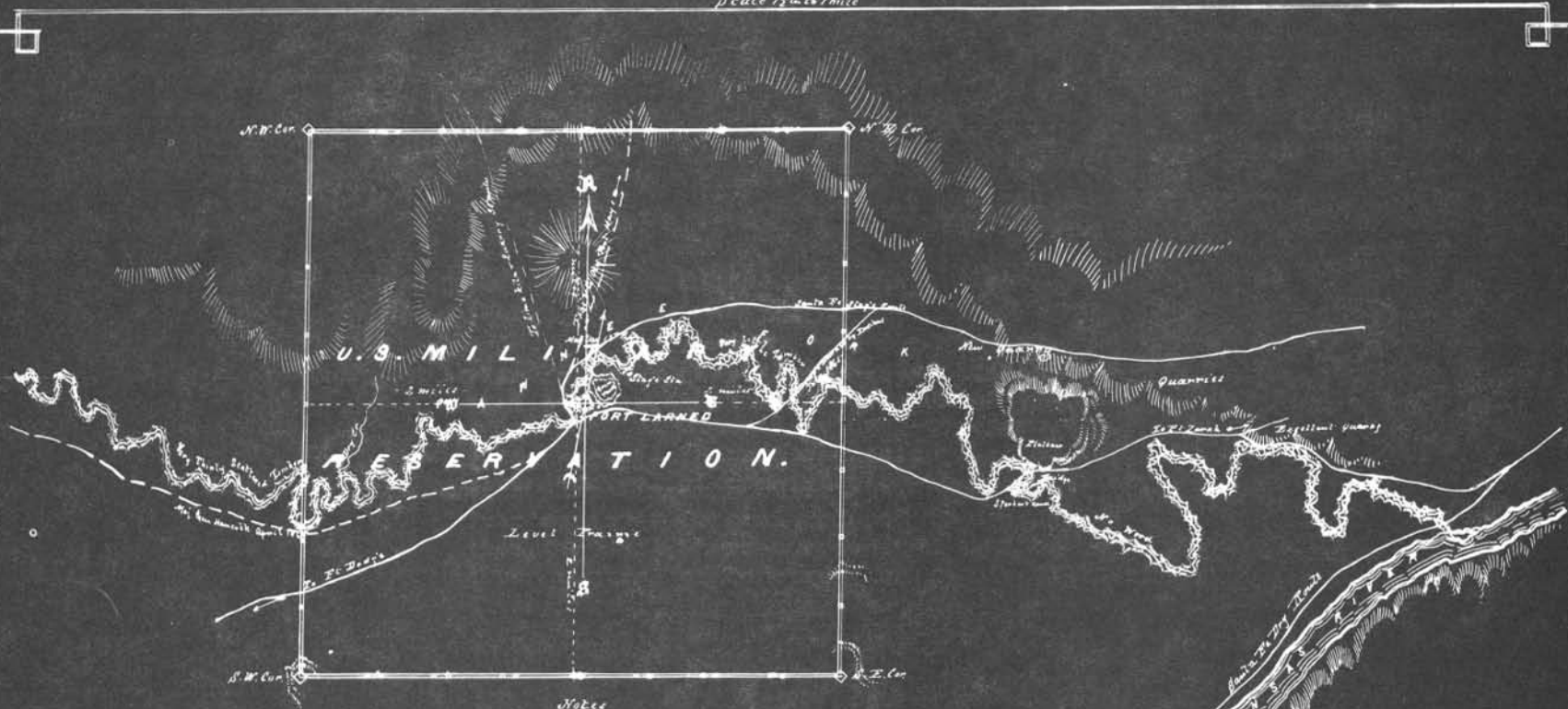

Hd. Qrs Dept. of the Mo  
Engineer's Office

Official

*M. R. Brown*

1<sup>st</sup> Lieut. U.S. Corps of Eng'g  
Chief Engineer

- ◆ Stone marked U.S. Res. placed at each of the corners
- Stakes marked U.S. Res. placed between stones at intervals of 1/2 mile

