

COMMISSARY STOREHOUSE

BUILDING NO. 43

FORT UNION

THE SOUTH WALL OF THE COMMISSARY STOREHOUSE AT FORT UNION WAS ORIGINALLY CONSTRUCTED AS A FREE-STANDING WALL, HENCE THE FOUR INTERMEDIARY BUTTRESSES SPACED ALONG ITS LENGTH. THIS WALL ENCLOSED THE YARD NEXT TO THE NORTHERNMOST OF THE THREE ADJACENT QUARTERMASTER STOREHOUSES (BUILT 1866-67), AND HAD A BOARD-AND-BATTEN SHED-TYPE EXTENSION ATTACHED ALONG ITS ENTIRE LENGTH. CONSTRUCTION OF THE REMAINING WALLS AND ROOF OF THE COMMISSARY STOREHOUSE BEGAN DURING THE SUMMER OF 1867, AND THE BUILDING WAS PROBABLY IN SERVICE BY THE MIDDLE OF 1868.

BUILT PARALLEL TO AND IN LINE WITH THE OTHER THREE STOREHOUSES, AS WELL AS SIMILAR IN SIZE (APPROXIMATELY 52' x 201'), THE COMMISSARY STOREHOUSE NONETHELESS DIFFERS FROM THE OTHER STOREHOUSES IN SEVERAL RESPECTS. IN PLAN, THE COMMISSARY STOREHOUSE IS DIVIDED INTO TWO LARGE STOREROOMS, LACKING THE CENTER PASSAGE FOUND IN THE OTHER STOREHOUSES. A LARGE

BASEMENT (APPROXIMATELY 38' x 105'), FOR THE STORAGE OF PERISHABLE FOODSTUFFS, UNDERLIES MOST OF THE WEST STOREROOM. ACCESS TO THE BASEMENT IS FROM AN EXTERIOR STONE STAIRWAY CENTERED IN THE BASEMENT ROOM ALONG THE NORTH SIDE OF THE BUILDING. THIS IS THE ONLY SUBSTANTIAL BASEMENT IN ALL OF FORT UNION.

SIMILARLY TO ALL OF THE BUILDINGS AT FORT UNION, THE COMMISSARY STOREHOUSE WAS CONSTRUCTED WITH A FOUNDATION (INCLUDING THE BASEMENT WALLS) OF LOCALLY-QUARRIED SANDSTONE. THE WALLS (APPROXIMATELY 30" THICK) WERE CONSTRUCTED OF ADOBE. TRACES OF LIME PLASTER REMAIN ON THE SOUTH EXTERIOR WALL. THE EXTERIOR WALLS WERE CAPPED WITH A BRICK CORNICE/PARAPET. RARE AMONG THE BUILDINGS AT FORT UNION, THE EAST WALL OF THE COMMISSARY STOREHOUSE WAS BUILT OF STONE. THE BUILDING WAS DIVIDED INTO THREE LONGITUDINAL STRUCTURAL BAYS, WITH

HEAVY TIMBER FRAMING SUPPORTING THE FIRST FLOOR JOISTS ABOVE THE BASEMENT, AND THE ROOF JOISTS. THE ROOF WAS ORIGINALLY SHEATHED WITH TIN PANELS.

DOCUMENTATION OF THE COMMISSARY STOREHOUSE AT FORT UNION WAS UNDERTAKEN BY THE HISTORIC AMERICAN BUILDINGS SURVEY / HISTORIC AMERICAN ENGINEERING RECORD (HABS/HAER) DIVISION OF THE NATIONAL PARK SERVICE (NPS), E. BLAINE CLIVER, CHIEF. THE PROJECT WAS SPONSORED BY HABS; BY THE INTER-MOUNTAIN REGION (IMR), NPS, KAREN WADE, DIRECTOR; AND BY FORT UNION NATIONAL MONUMENT (FOWN), NPS, HARRY C. MYERS, SUPERINTENDENT. PROJECT PLANNING WAS COORDINATED BY PAUL DOLINSKY, CHIEF, HABS; BY RODD WHEATON, ASSISTANT REGIONAL DIRECTOR, CULTURAL RESOURCES AND PARTNERSHIPS, IMR; AND BY BOB HARTZLER, EXHIBIT SPECIALIST, FOWN. THE FIELD RECORDING WAS UNDERTAKEN AND THE DRAWINGS WERE PRODUCED BY HABS ARCHITECTS MARK SCHARA, RAUL VAZQUEZ, AND GREG HARRELL.

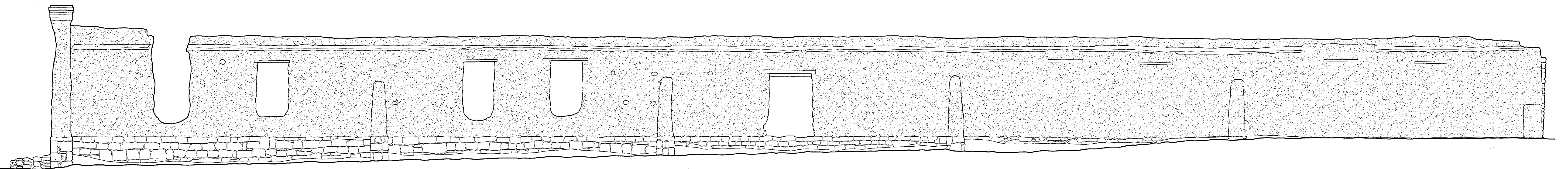

SOUTH ELEVATION

3/16"=1'-0" 1:64

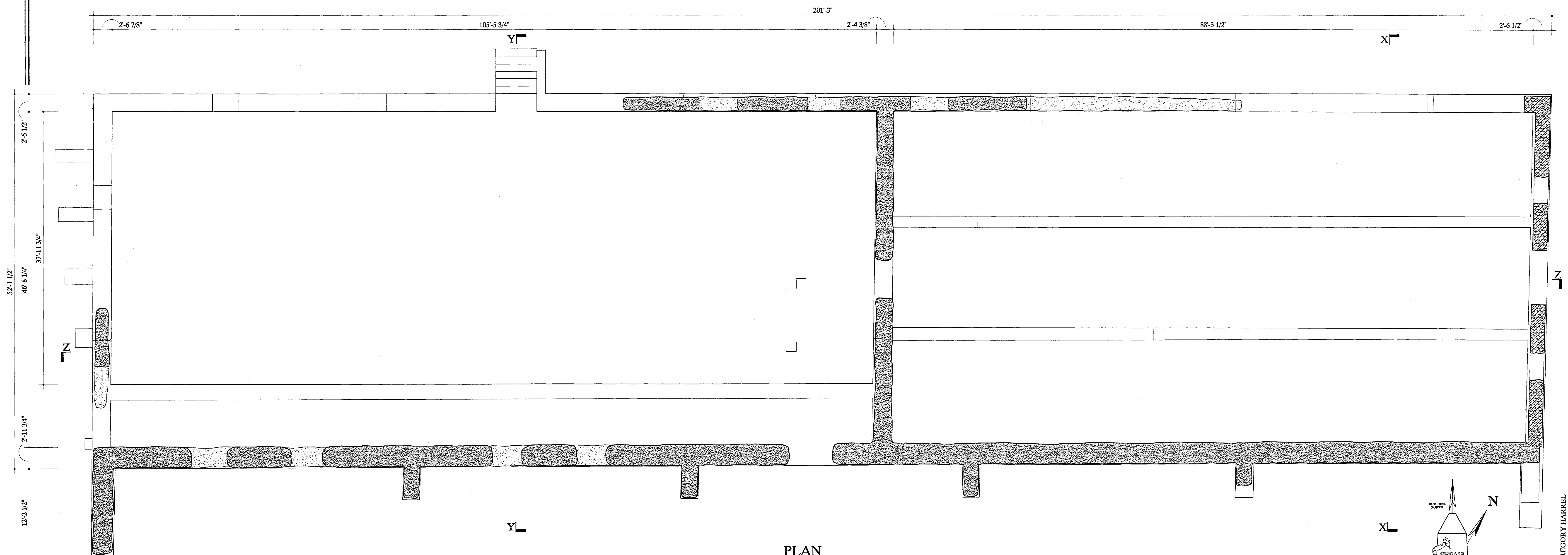

PLAN

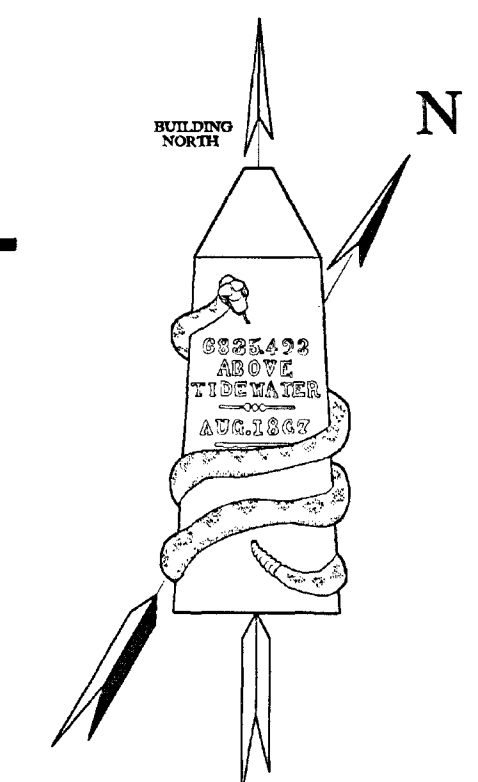
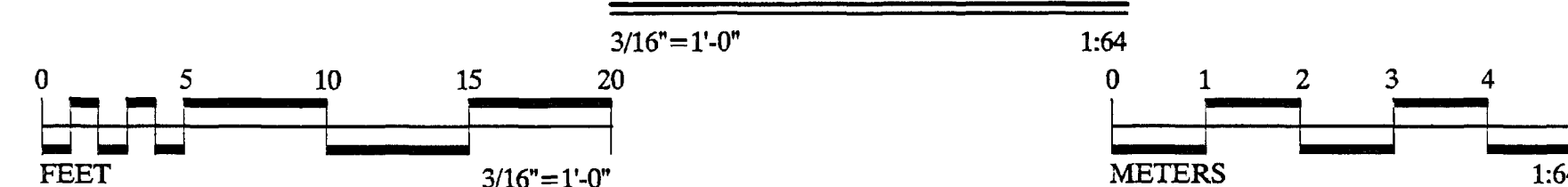

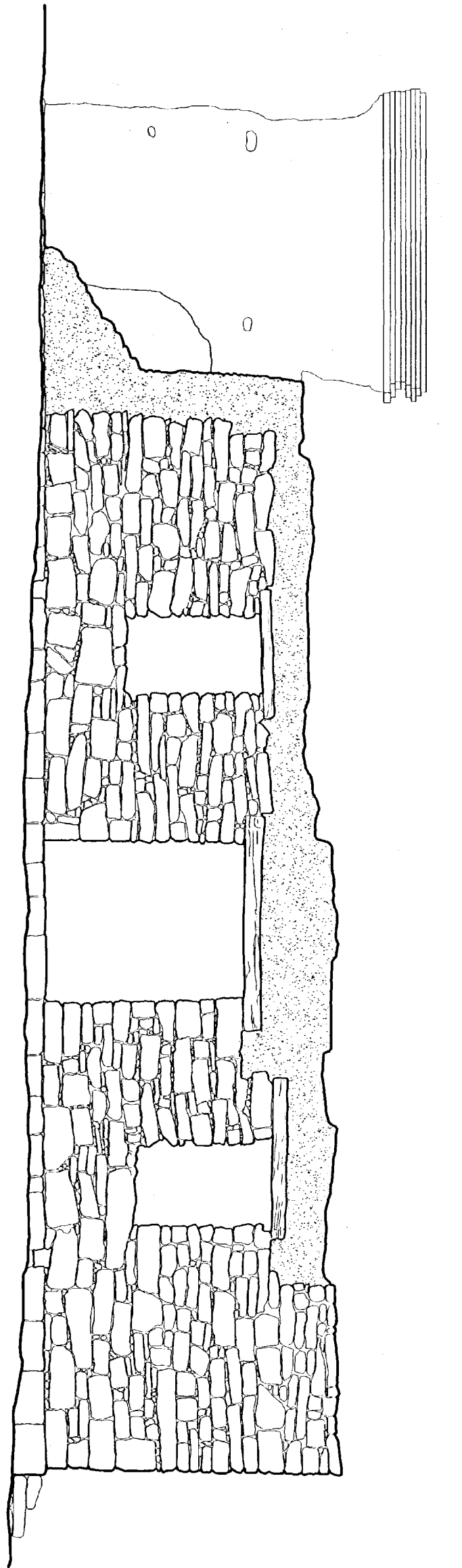

EAST ELEVATION
3/16"=1'-0"
154

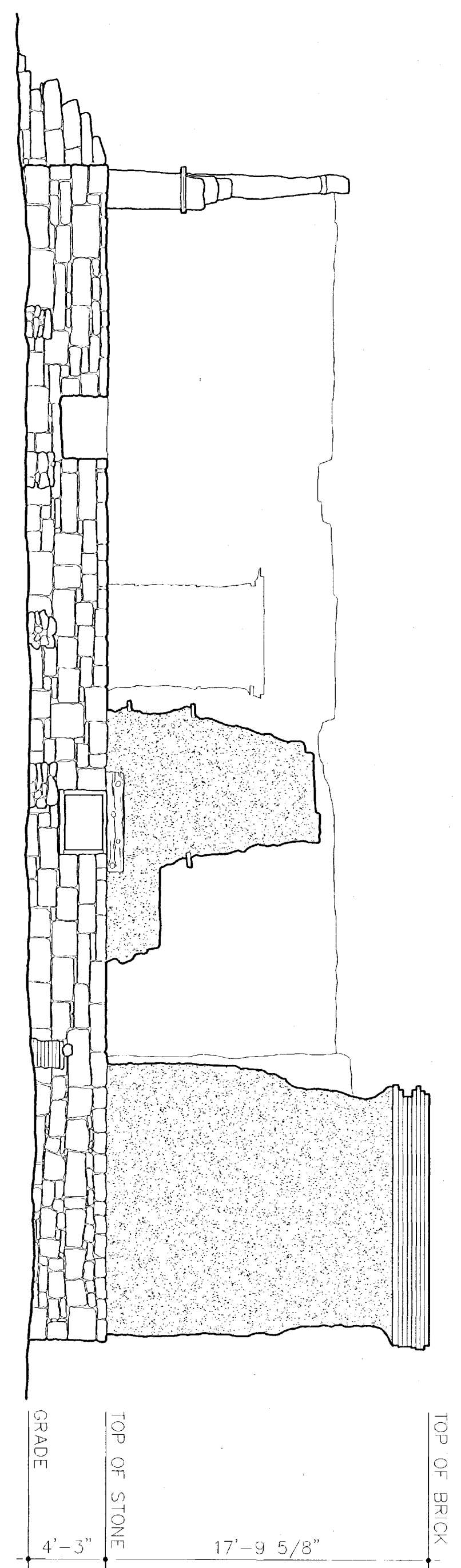

WEST ELEVATION
3/16"=1'-0"
154

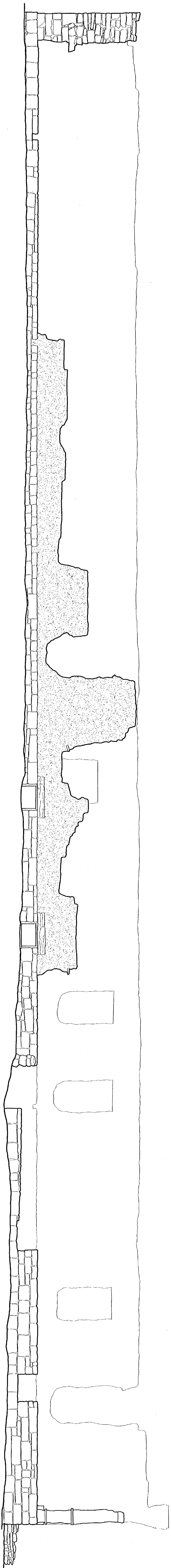

NORTH ELEVATION
3/16"=1'-0"
154

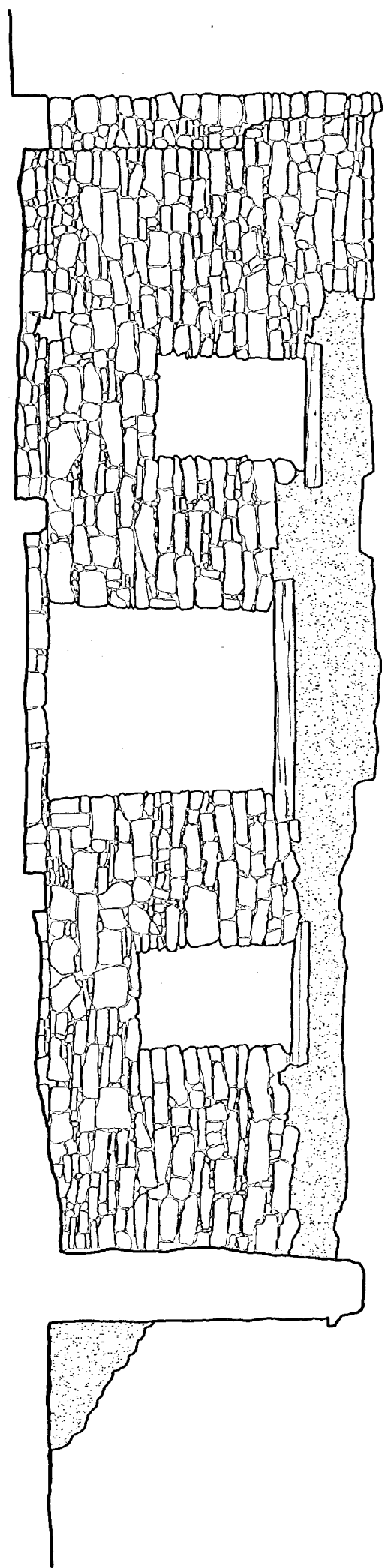

SECTION X-X
3/16"=1'-0"
154

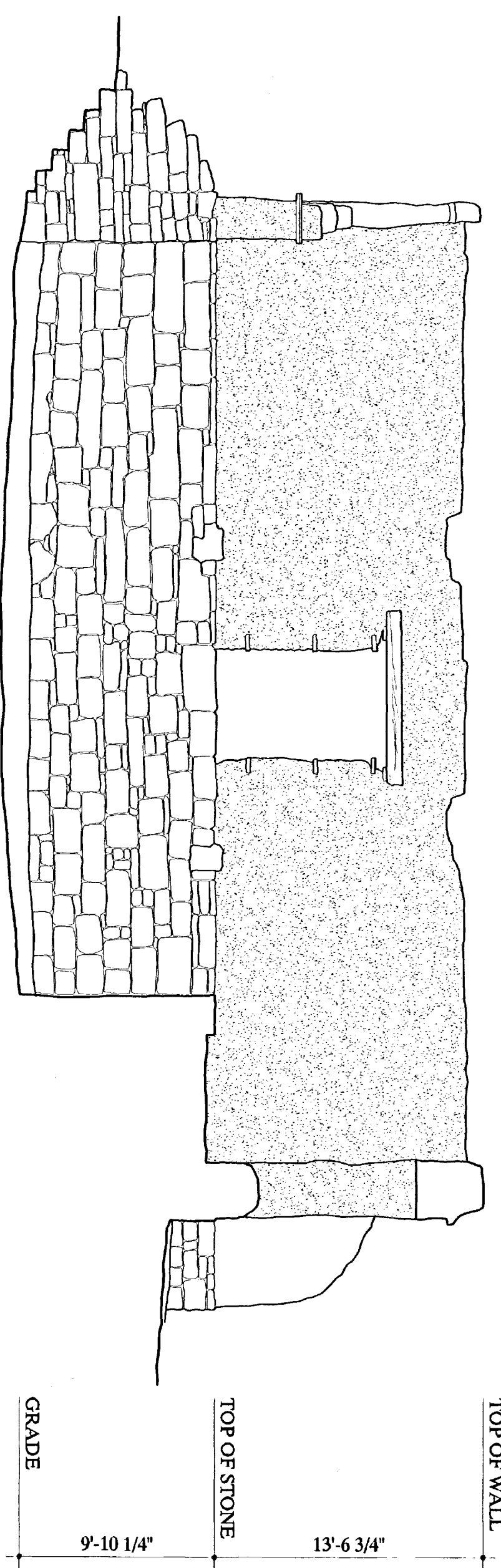

SECTION Y-Y
3/16"=1'-0"
154

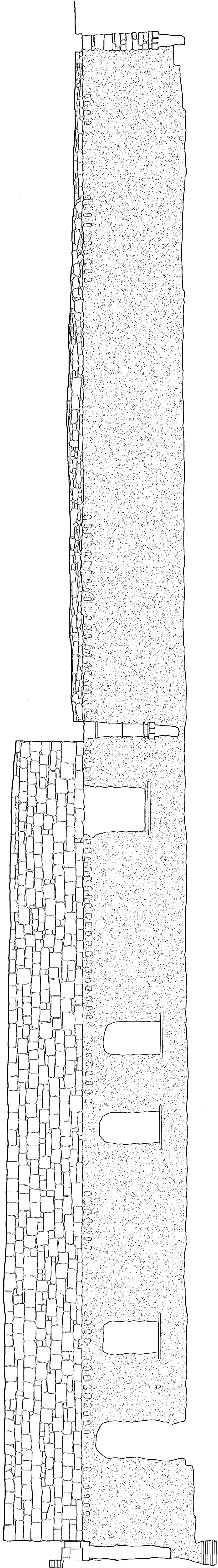

SECTION Z-Z
3/16"=1'-0"
154

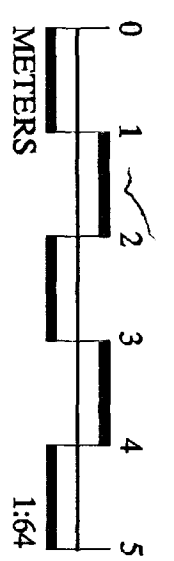
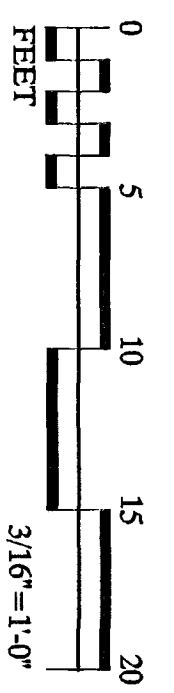

DRAWN BY: GREGORY HARREL

FORT UNION PROJECT 2000
NATIONAL PARK SERVICE
UNITED STATES DEPARTMENT OF THE INTERIOR

STATE HIGHWAY 161

FORT UNION · COMMISSARY STOREHOUSE
WATROUS VICINITY MORA COUNTY

NEW MEXICO

SHEET 2
OF 2 SHEETS

HISTORIC AMERICAN
BUILDINGS SURVEY
NM-164-AA

LIBRARY OF
CONGRESS
DIGITIZATION



document B 10
1938



ORIENTAL B 12



HARRIS. N.M. 164. 11. 13

SPHERICAL B 41



HS-05. N.C. 164. AA. 1

