

by Lieut. Haunover. W.B.M.P. Bluffs
30

30 Enclosure where the Sandwich Islanders reside. Note the dotted line marks out limits of the former settlement in.

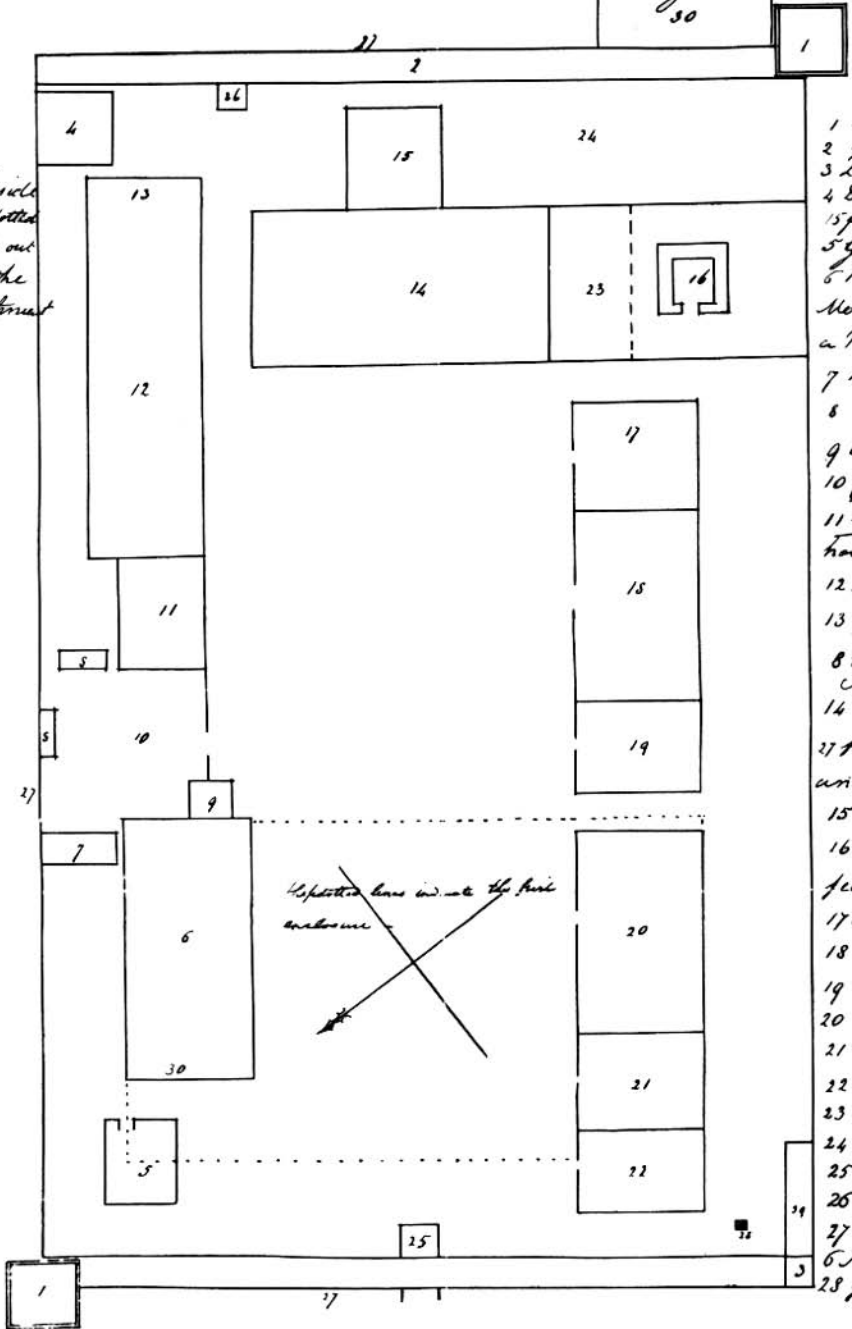

References

- 1 Block Houses 15 feet ^{one} by 7
- 2 Gallows 151 feet by 7
- 3 Look out house 7 feet square
- 4 Dwelling house and 4. feet 15 feet square.
- 5 Grain store 11 by 15.
- 6 Residence of the principal Merchant 36 by 26 including a Writing office. -
- 7 Butlers shop 15 by 7.
- 8
- 9 a hall not finished
- 10 Court yard 30 by 35
- 11 Gentlemans dwelling house 23-18
- 12 Mens Mess Room 70 by 15
- 13 Blacksmiths shop 8 by 25
- 14 House not finished
- 15 for the resident Merchant and Gentlemen 60 by 30
- 15 Kitchen 19 by 21
- 16 Powder Magazine 15 feet square
- 17 Indian Store 22 by 26
- 18 Balung Store 38 by 26
- 19 Squip Store 20 by 26
- 20 Provision Store 42 by 26
- 21 Daily ration Store 20 by 26
- 22 Receiving Store 18 by 26
- 23 Waste Ground
- 24 Poultry yard
- 25 Front entrance
- 26 Back do
- 27 Piles of fir 12 feet by 6 inches in diameter
- 28 flag staff. 29 Coopers shed.