

Map 1.

"Deer Lodge Townsite," 1907.

Courtesy of Milwaukee Road Offices, Deer Lodge, Montana.

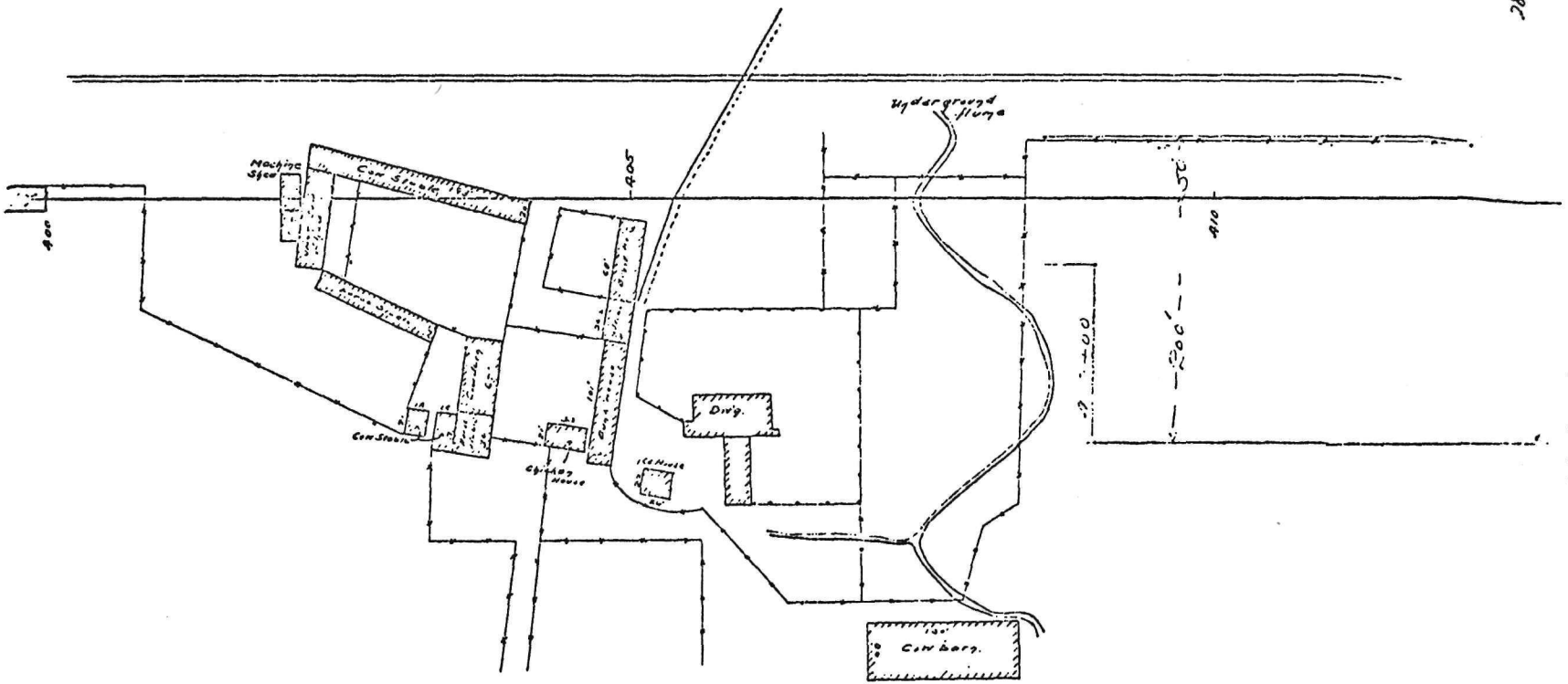

Kohrs & Bielenberg

C. M. & S. P. RY OF MONT.

MADE BY HAD + CTM DATE Feb. 25th 07.
 AT Missoula FILE NO
 CORRECT INDEX NO
 SCALE: 1"=100'

[A PARTIAL MAP OF]
 DEER LODGE TOWNSITE,
 AND N. P. RY. STATION GROUNDS,

POWELL COUNTY.

Copied from N. P. Map,
 Office of Engr,
 Missoula, Mont.
 Feb 25th July 6, 07.

Map 2.

"Kohrs & Bielenberg Grazing Areas & Cattle Trails, 1862-1924."

While many of the early grazing areas changed according to the availability of grass and water, this map shows the general extent of the Kohrs and Bielenberg cattle business. It was prepared by George Reinbold of the Rocky Mountain Regional Office, NPS.

1. The home ranch and Deer Lodge Valley ranges
2. The Sun River range
3. The DHS range
4. N Bar N and associated ranges
5. Powder River range
6. The Milk River range
7. Cypress Hills range (Canada)
8. Fort Benton ranges
9. The Malta range
10. Snake River ranch
11. Fort Steele range
12. North Park

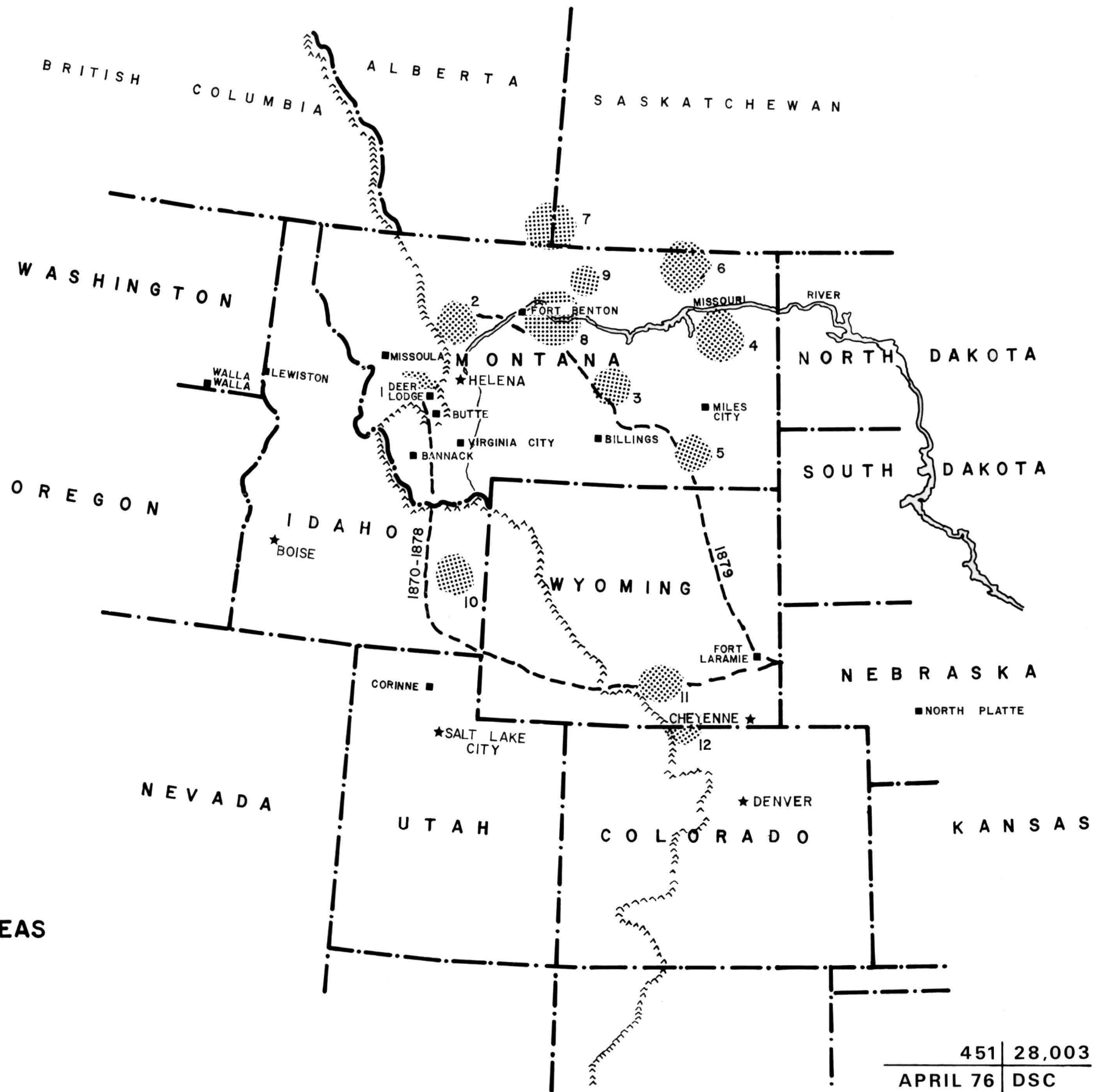

**KOHR'S & BIELENBERG GRAZING AREAS
& CATTLE TRAILS. 1862-1924**

Map 3.

"Building the Home Ranch: Kohrs & Bielenberg, 1866-1908"

"DB" refers to Transcribed Powell County Deed Books, namely those deed books now at Powell County that were transcribed from the original Deer Lodge County Deed Books at the time a portion of the original Deer Lodge County became Powell County, January 1, 1901.

"PC-DB" refers to the Powell County Deed Books created after Powell County was organized.

All "DB" references, therefore, date from *before* January 1, 1901, and all "PC-DB" entries were made after that date.

NOTE: Areas marked LL are those that were part of the ranch on June 1, 1908 (PC-DB 9, pp. 476-77), but to which no earlier reference has yet been located in the county deed books.

Data based on "Kohrs-Grantee" in Transcribed Powell County Deed Books:

- A. 10 Oct 71 DB 1, p. 492.
- B. 10 Oct 71 DB 1, pp. 486-87.
- C. 1 Jun 72 DB 2, pp. 286-88.
- D. 7 Jan 73 DB 2, p. 339.
- E. 28 Feb 78 DB 3, pp. 359-60.
- F. 29 Jun 80 DB 3, pp. 647-48.
- G. 2 Jan 83 DB 4, pp. 563-65.
- H. 5 Apr 84 DB 4, pp. 502-3.
- I. 2 Jan 85 DB 4, p. 585.
- J. 10 Jan 76 HOMESTEAD by Conrad Kohrs.
- K. 13 May 90 DB 5, p. 66.
- L. 29 May 90 DB 7, p. 182.
- M. 22 Dec 90 DB 5, p. 74 (overlaps with C).
- N. 2 Dec 91 DB 5, p. 431.
- O. 18 Jul 92 DB 7, p. 355.
- P. 28 Nov 98 DB 12, pp. 614-15.
- Q. 21 Jan 99 DB 12, pp. 625-26.
- R. 30 Aug 99 DB 7, p. 578.
- S. 1 Oct 99 DB 10, pp. 510-11.
- T. 14 Aug 00 DB 5, pp. 524-25.
- U. 31 Oct 00 DB 10, p. 591.

Data based on "Bielenberg-Grantee" in Transcribed Powell County Deed Books:

- V. 1 Aug 78 DB 3, pp. 398-99 (this is 1/4 interest for JNW Bielenberg, indicating it is already owned, but the exact date of purchase was not located).
- W. 23 Sep 90 DB 5, p. 73.
- X. 2 Dec 91 DB 5, p. 432.
- Y. 30 Jul 95 DB 12, pp. 160-61.
- Z. 31 Aug 99 DB 10, pp. 501-2.
- AA. 21 Jan 95 DB 12, p. 112.
- BB. 10 Oct 98 DB 12, pp. 595-96.
- CC. 14 Dec 98 DB 12, pp. 608-9.

Data based on "Kohrs-Grantee" in post-1901 Powell County Deed Books:

- DD. 15 Jun 01 PC DB 1, p. 135.
- EE. 15 Jun 01 PC DB 1, p. 136.
- FF. 15 Jun 01 PC DB 1, p. 137.
- GG. 14 Feb 02 PC DB 1, p. 430.
- HH. 14 Feb 02 PC DB 1, p. 431.
- II. 5 Nov 02 PC DB 2, p. 63.
- JJ. 7 Mar 03 PC DB 5, p. 161.
- KK. 15 Oct 07 PC DB 9, p. 48.

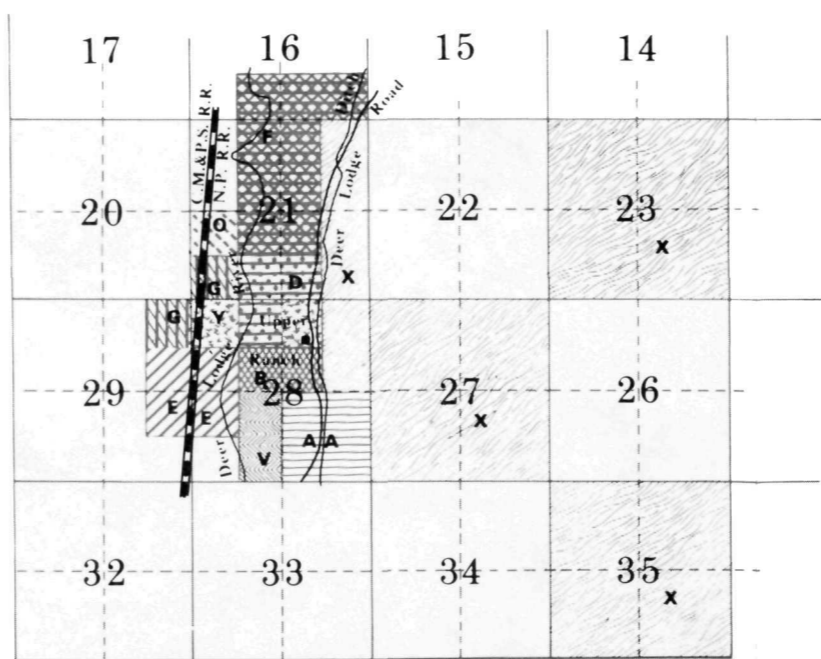

**BUILDING THE HOME RANCH:
 KOHRS & BIELENBERG**
 1866-1908
 DEER LODGE VALLEY, POWELL COUNTY MONTANA
 MONTANA

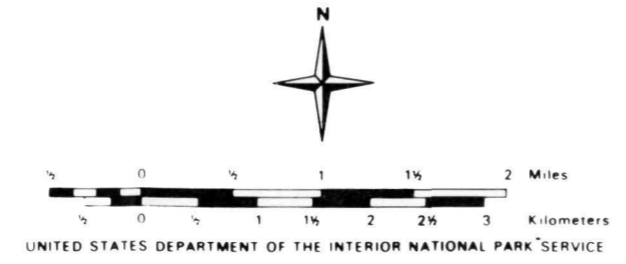

Map 4.

"Building the Home Ranch: Kohrs & Bielenberg, 1866-1908-by Decades"

Decade and a half - the 1860s and 1870s (1866 to December 31, 1879)

Decade of the 1880s - (1 January 1880 to 31 December 1889)

Decade of the 1890s - (1 January 1890 to 31 December 1899)

1st Decade 20th Century - (1 January 1900 to 1 June 1908)

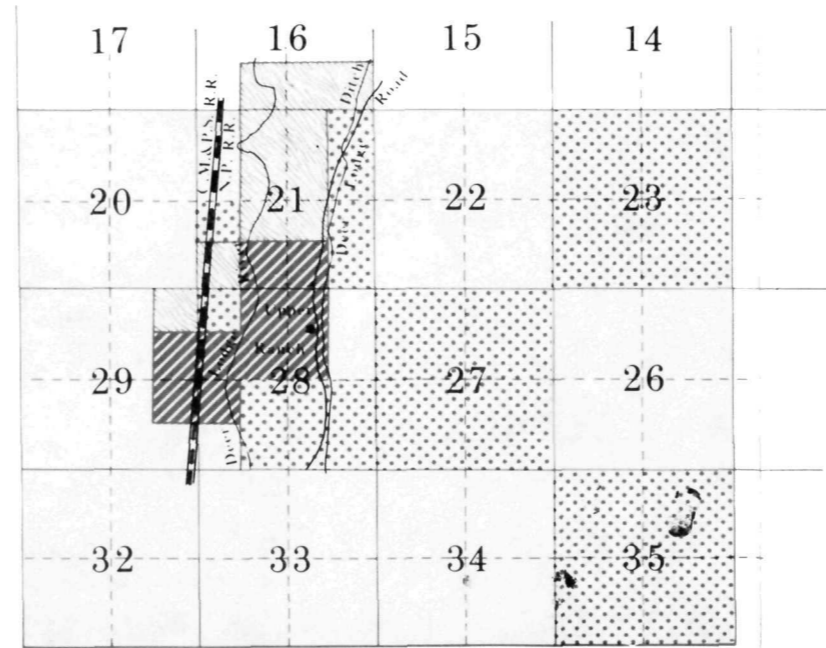
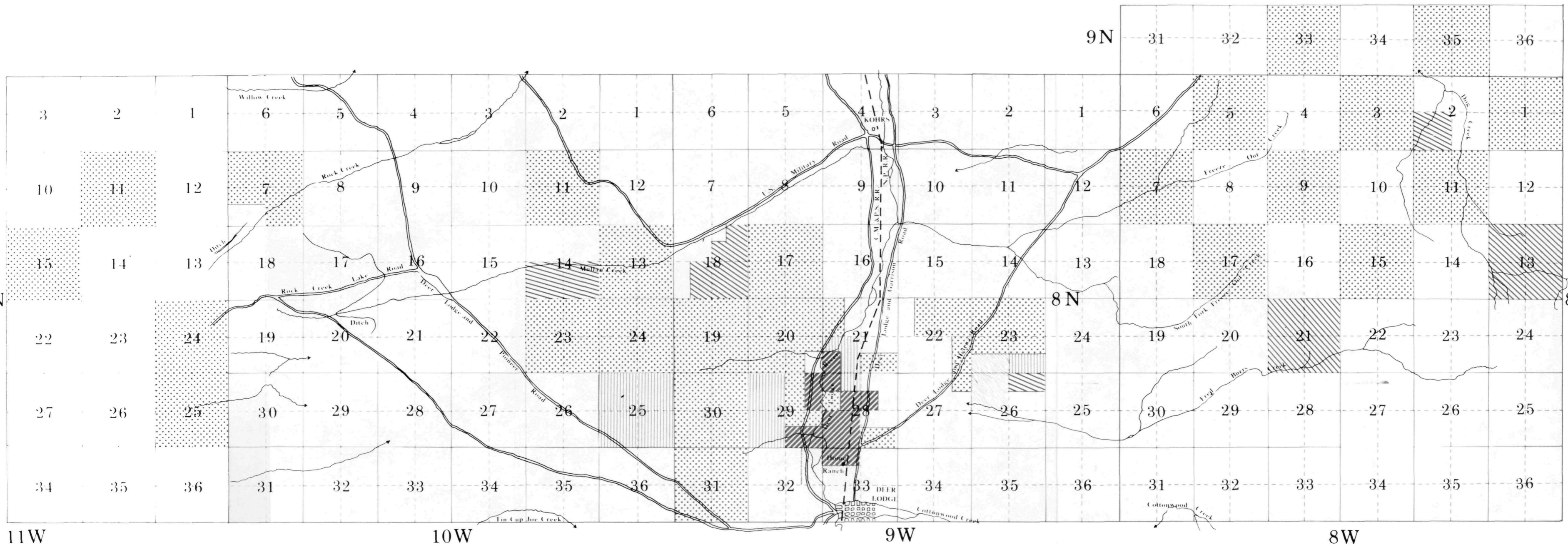

**BUILDING THE HOME RANCH:
 KOHRS & BIELENBERG**
 1866-1908-BY DECADES
 DEER LODGE VALLEY, POWELL COUNTY MONTANA
 MONTANA

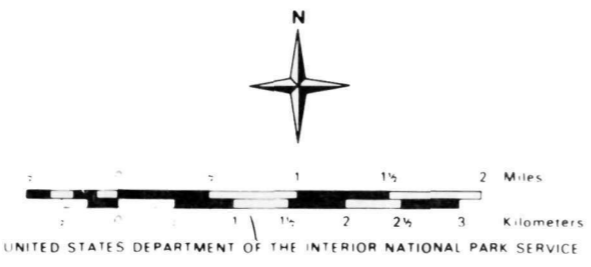

Map 5.

"Selling the Home Ranch: Kohrs & Bielenberg, 1919-1924"

2 June 1919 offer to sell by Rock Creek Ditch and Mining Company, along with various claims and water rights not shown (\$50,000).

2 June 1919 offer to sell by Kohrs and Bielenberg Land and Livestock Company (\$100,000).

18 September 1924. This agreement included leased land as well. Initial cost of \$75,000, which, with 6 percent interest for full term of contract, became \$91,020.

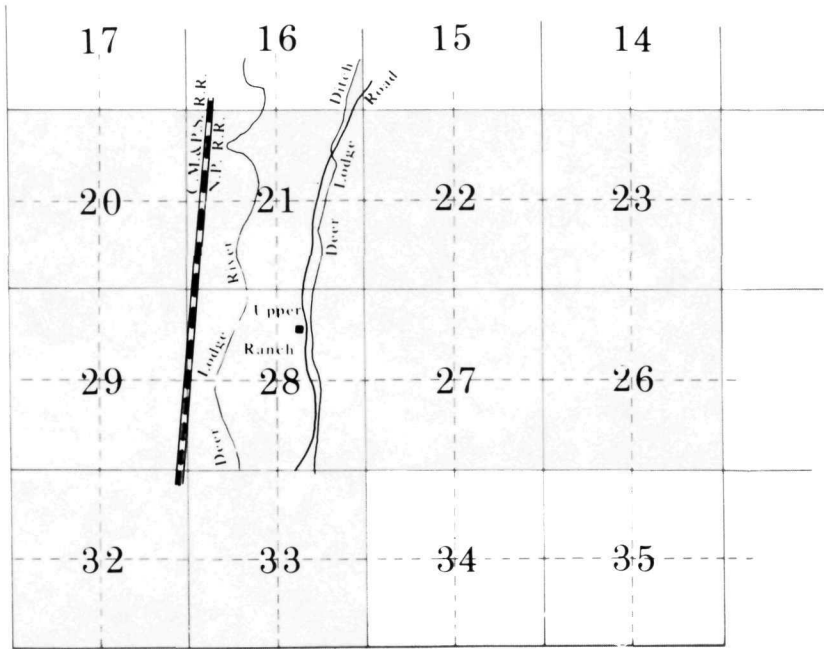
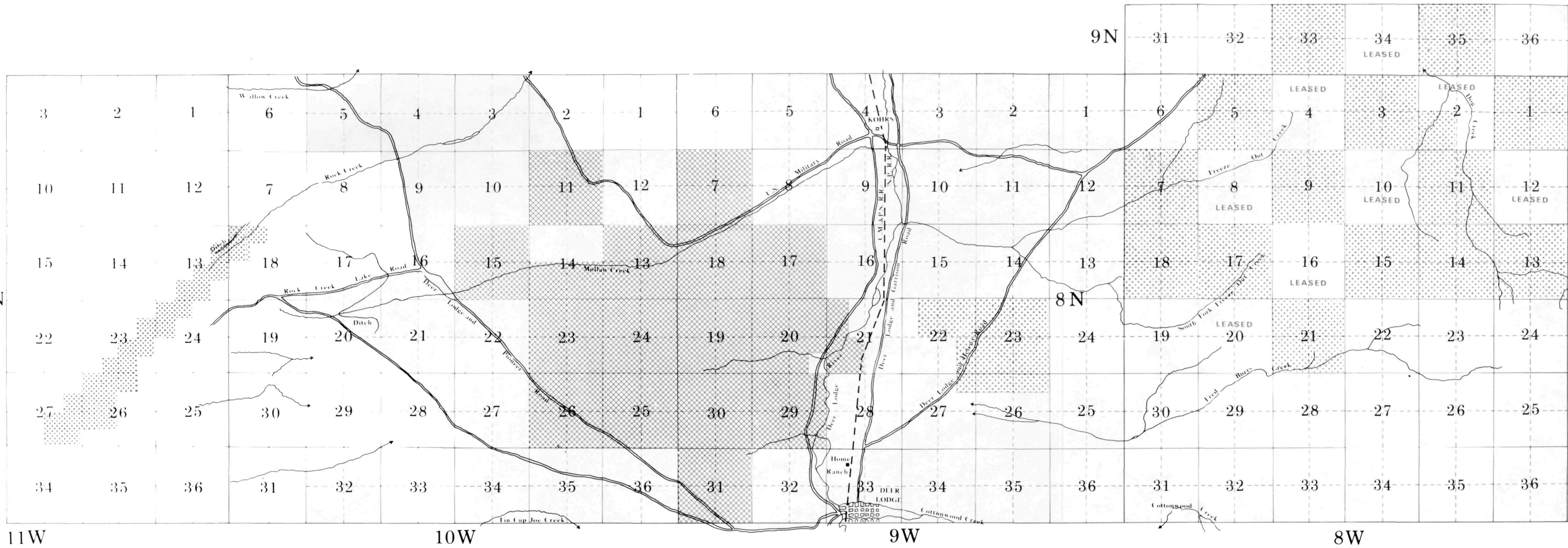

**SELLING THE HOME RANCH:
KOHRS & BIELENBERG**

1919-1924
DEER LODGE VALLEY, POWELL COUNTY MONTANA
MONTANA

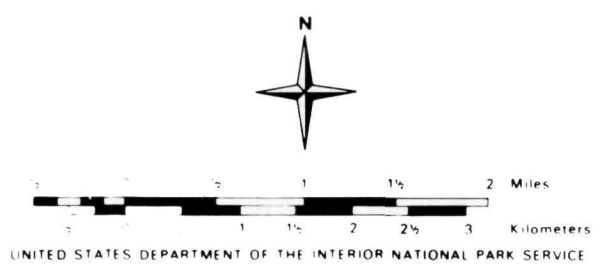

Map 6.

Map marked "Cattle from Montana," by Con Kohrs, 1881.

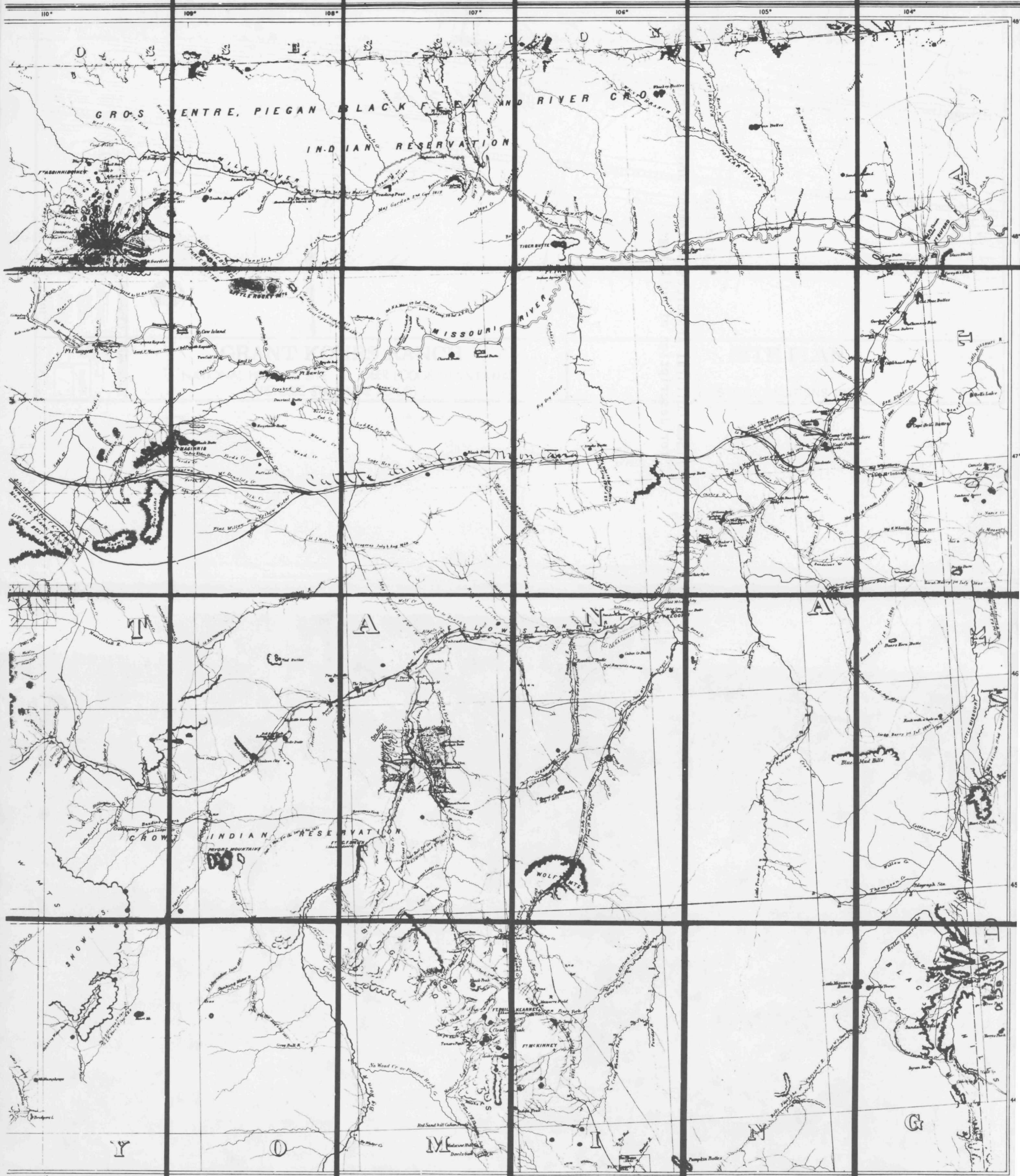

Site Plan

(See Cultural Resources Statement and Historic Structure Report
for description of buildings.)

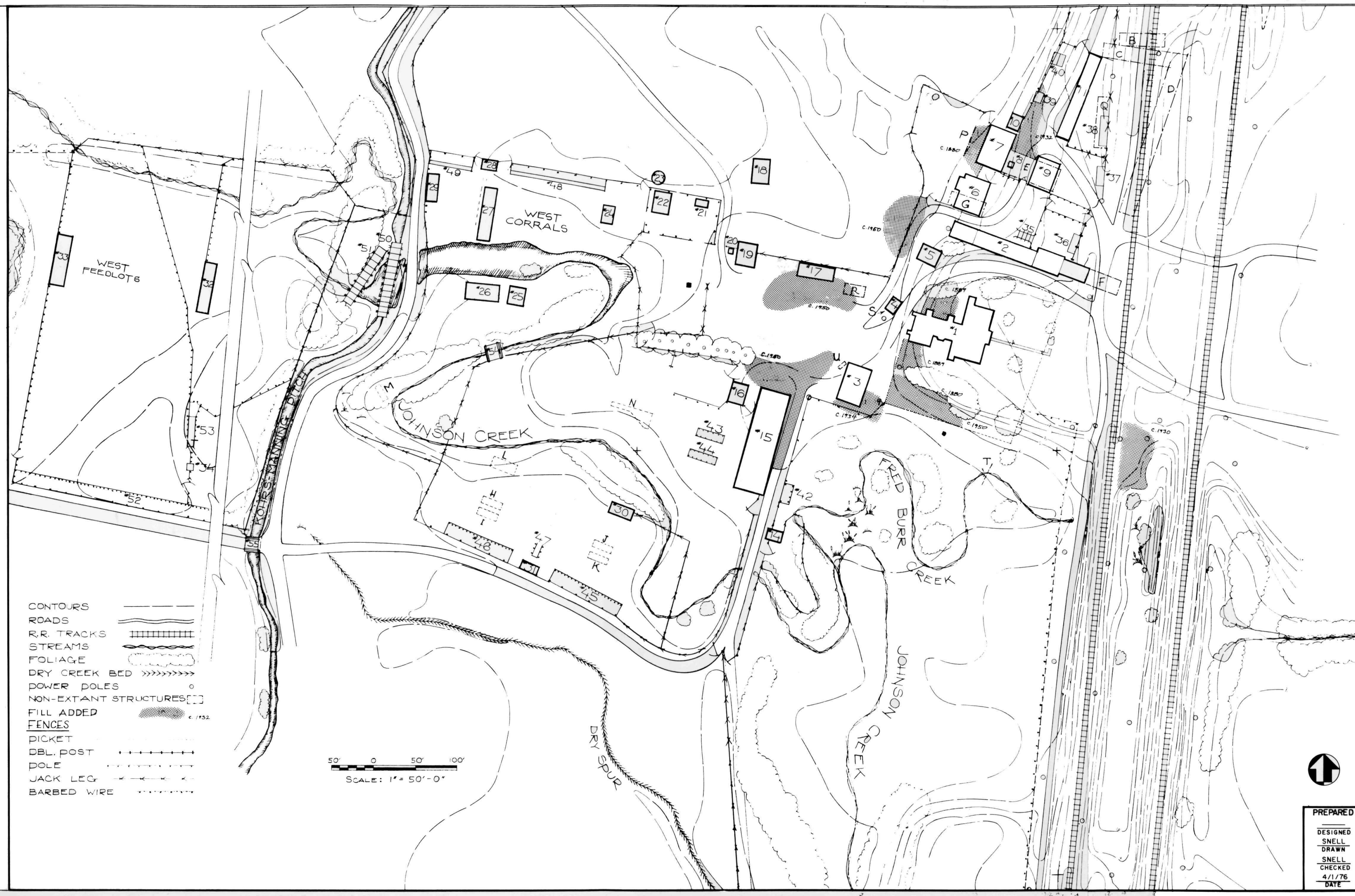

- CONTOURS
- ROADS
- R.R. TRACKS
- STREAMS
- FOLIAGE
- DRY CREEK BED
- POWER POLES
- NON-EXTANT STRUCTURES
- FILL ADDED c. 1952
- FENCES
- PICKET
- DBL. POST
- POLE
- JACK LEG
- BARBED WIRE

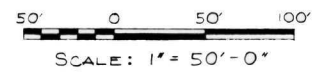

SITE PLAN

GRANT KOHRS RANCH

NATIONAL HISTORIC SITE DEER LODGE MONTANA
HISTORIC STRUCTURE REPORT

EXISTING CONDITIONS 1975

PREPARED	DRAWING NO.
DESIGNED	457
SNELL	28004
DRAWN	PKG NO.
SNELL	SHEET
CHECKED	1
4/1/76	OF 2
DATE	

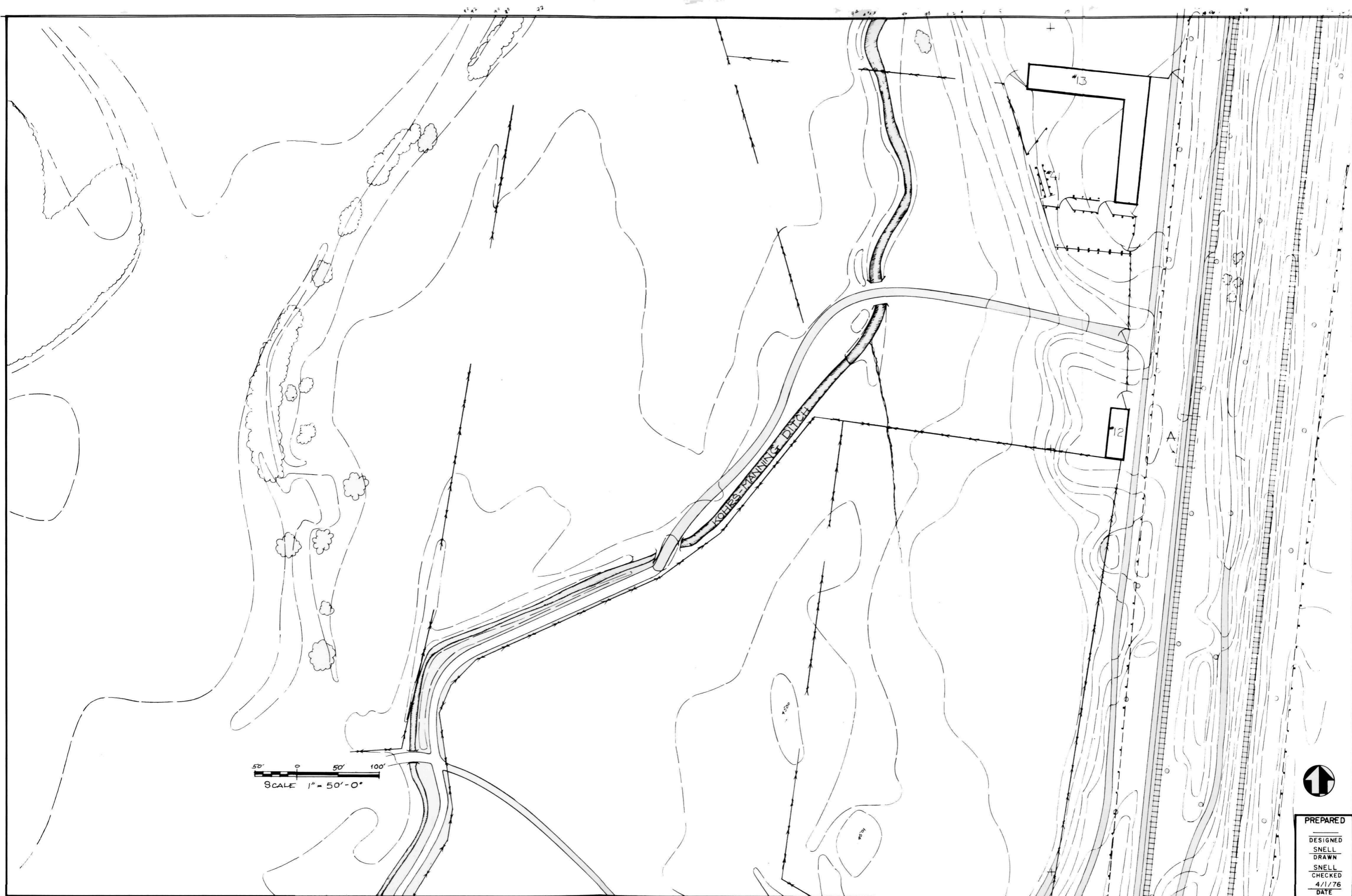

50' 0 50' 100'
SCALE 1" = 50'-0"



DESIGNED	457
SNELL	28004
DRAWN	
PKG. NO.	
SNELL	2
CHECKED	
4/1/76	
DATE	OF 2

SITE PLAN

GRANT KOHRS RANCH
NATIONAL HISTORIC SITE DEER LODGE MONTANA
HISTORIC STRUCTURE REPORT

EXISTING CONDITIONS 1975