

# LASSEN NEWS

A PUBLICATION OF THE LASSEN PARK FOUNDATION

FALL 2006

CAMPAIGN GOAL OF \$500,000 NEARLY MET—ONLY \$35,000 TO GO!

highlights  
this Issue

Visitor Center  
Campaign

New Board  
Members

Support for  
Youth Programs

New Opportunity  
to Donate  
IRA Assets

Endowment  
Fund



Kohm Yah-mah-nee, the long-awaited, year-round Visitor Center for Lassen Volcanic National Park is still on schedule to begin construction in early Summer 2007 and continue through Summer 2008, with an opening planned for October 2008. The Lassen Park Foundation's campaign goal of \$500,000 is on schedule too—with just \$35,000 left to raise. Thank you to everyone who has given to this campaign so far, and thank you too if you are planning to give soon. There is still time to have your name on the donor wall if your contribution is \$1,000 or more, however all gifts are important.

A design-build contract was awarded to Slayden Construction Group of Stayton, Oregon in June and at the present, design refinements are taking place. The architect is Ward Young of Truckee. Through the winter months further preparations will take place in preparation for next spring, when construction will begin and continue through the summers of 2007 and 2008. The plans were adapted to a single-story structure of 8,800 square feet and will still include interpretive exhibits and displays, an auditorium for Park films and events, a fireplace, an outdoor amphitheater, a bookstore for educational products, a gifts and souvenirs section, a restaurant, restrooms, first-aid services and after-hours orientation displays. The overall budget is \$10.8 million.

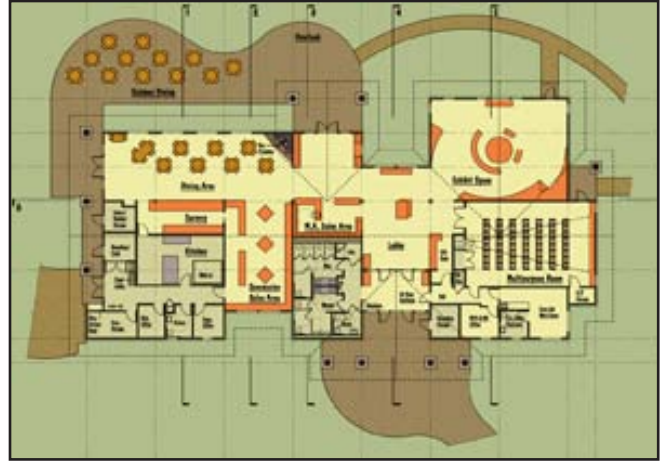

The orientation film that will be shown continuously at the Center is a major item sponsored exclusively by the Lassen Park Foundation. The filming for this film has been accomplished and in 2007 the final version will be complete.

*Dear Friends,*

*The Lassen Park Foundation came into being 24 years ago when a small group of individuals became interested in creating a park friends organization that would improve visitor services in Lassen Volcanic National Park--the immediate goal was to have a real Visitor Center for our favorite National Park. It has been a circuitous route but we are very close*

*to the realization of this dream. Thank you for your strong support for the project. I hope that you'll plan to be there with me in October 2008 when Kohm Yah-mah-nee opens!*

*Along the way our organization has grown and matured. We are planning for the future by continuing to build our Board of Directors, reaching out to new friends and donors, and building our resources. We have a Planned Giving Program and an Endowment Fund. Our Board has identified the need to enlarge our Youth Program due to the real need for all young people to have extraordinary outdoor experiences. In the next year we will also consider a new capital campaign—support for a large project in the Park or Forest.*

*Thank you for your continued support. It is only this that allows us to accomplish our work.*

*Best wishes for the holiday season,*

*John W. Koeberer*

## NEW BOARD MEMBERS ENERGIZE THE FOUNDATION

In October four new individuals joined the Board of Directors of the Lassen Park Foundation bringing new expertise and energy to the group. All have an association with the Lake Almanor area and have a close connection to Lassen Volcanic National Park and Lassen National Forest. Derek Anderson of Mill Valley and Lake Almanor, the managing member and founder of Plantagenet, Inc., has over thirty-five years of experience in investment management and corporate restructuring. Arlie Holland, of Chester, has been a Realtor-Associate with Coldwell Banker Kehr/O'Brien Real Estate in Chester for over nineteen years. Robert Klein of Granite Bay and Lake Almanor, is a partner in Technical Transportation, a nationwide specialty service provider, and has worked in the transportation industry for the last forty years. Sharon Thrall, of Chester, is Supervisor Elect for Plumas County District Three and has been involved in local community and county issues for many years.

BECOME A FRIEND OF THE LASSEN PARK FOUNDATION  
CHECK OUT OUR WEBSITE: [WWW.LASSENPAKFOUNDATION.ORG](http://WWW.LASSENPAKFOUNDATION.ORG)  
YOU MAKE IT POSSIBLE - YOUR CONTRIBUTION IS SO APPRECIATED!

## FOUNDATION RE-ITERATES STRONG SUPPORT FOR YOUTH CAMPING

Is a camping trip just for fun, or are there valuable life lessons to learn? If we have no one to take us camping when we are young, how will we go? If we have a chance to go, will we get along with the other kids, or know how to put up our tent, or be afraid of bears? How will we cook our food or take a shower? Will we be able to keep up on a hike or lend a hand to someone who is slower? These are the elements of a camping trip that nurture growth of character in youth. A life-changing summer experience can render significant change in young people, but especially those from backgrounds of financial limitation, emotional stress, or behavior challenges. A coordinator of one of our Summer 2006 camping groups wrote, "I believe that the biggest change that occurred for the kids was that they gained a lot of confidence, strength and perseverance throughout the week. They have all been survivors their whole lives but the difference was that now they began to take care of each other."



*"Victorious on Lassen Peak- Youth for Change kids make it to the top!"*

It was another wonderful year of camping for our kids: Five youth groups that totaled seventy-five youth and twenty-eight adults had successful trips to LVNP all because of the Lassen Park Foundation's Youth Camping Program which makes small grants to youth groups to organize camping trips. This year the groups who benefited were: Whitmore Elementary School, in Shasta County, Americorps Foster Youth Mentoring Program from Susanville, the Youth Outreach Program, Redding, Teens at Heart, Anderson, Youth for Change, Paradise. The Foundation also made a contribution of \$500 to the Junior Scientist Program at Lassen Volcanic National Park and invested in the Interpretative Intern Program at the Park. The Interpretive Intern Program's eight interns logged 913 volunteer hours of their work in interpretation of the natural and cultural resources as well as visitor protection and maintenance.



*Youth Outreach Program in Redding*



*Above and right, Anderson Teen Center*



*Below Youth for Change*



*"Today me and my peers had a great time climbing mount Lassen wich errepted in 1915. Some did not make it. I almost didn't make it but I did. I felt great when I got to the top of Lassen. I thank you for making this happen for us all! We are having the best time ever. I might bring my dad up here next time."*

## NEW OPPORTUNITY TO DONATE IRA ASSETS- CHARITABLE IRA ROLLOVER

President Bush recently signed the Pension Protection Act of 2006 (HR4). One of the provisions of this legislation allows IRA owners to share the wealth of their retirement savings by giving directly to charity - without first counting it as income and paying income tax. Specifically, the new law permits people who have reached 70 1/2 to make charitable transfers up to \$100,000 per year to a qualifying charity. These IRA charitable rollovers will be allowed in 2006 and 2007 only.

Please take advantage of this and other "creative giving" strategies that we have to offer. As always, it's important to talk to your tax advisor to see if this would be an appropriate gift to the Lassen Park Foundation.

For more information please call Jane Ziad at the Lassen Park Foundation. 530-898-9309.

## AN ENDOWMENT FUND FOR THE LASSEN PARK FOUNDATION

The Lassen Park Foundation began an endowment fund in 1998 at the North Valley Community Foundation in Chico with the vision of building stability in perpetuity for the Lassen Park Foundation. Many worthy non-profit organizations fade away because their existence is dependent on current management and cultivation of annual income.

Good stewardship of our Foundation includes creating an endowment fund so that we may ensure consistent services far into the future. Planned gifts may be directed to the endowment fund too so that donors feel they can ensure the future of the Lassen Park Foundation.

To learn more about endowment funds and how they can help you maintain your annual gifts forever, please call Jane Ziad at the Lassen Park Foundation, (530) 898-9309.