

23
 Mr. President.

Re: National Parks Nov-11-1967- A

NOV 27 1967

FNT

Dear Mr. Lyndon B. Johnson.

We have a request to make - and not sure who to write to, so - we are writing to you - and asking if you would please put our letter into the right hands for consideration.

There is one area that is native to the Valley - San Joaquin Valley Calif. It is a small area of native Sagebrush and about the only such area left that we know of - we think it would be nice if it was made into a Park - and call it "National Sage Brush Park" to keep it as natural as possible but have rest rooms and Picnic area and Paths & road in it. It is located on Highway 41 - South West of Fresno, on way to San Luis Obispo & Paso Robles and Morro Bay and the Coast Area's. It would be a good place for a Park - as it's a long way between towns at this corner. It should have water too, for people to use - I'm also including a map of the area.

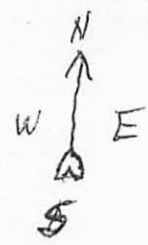
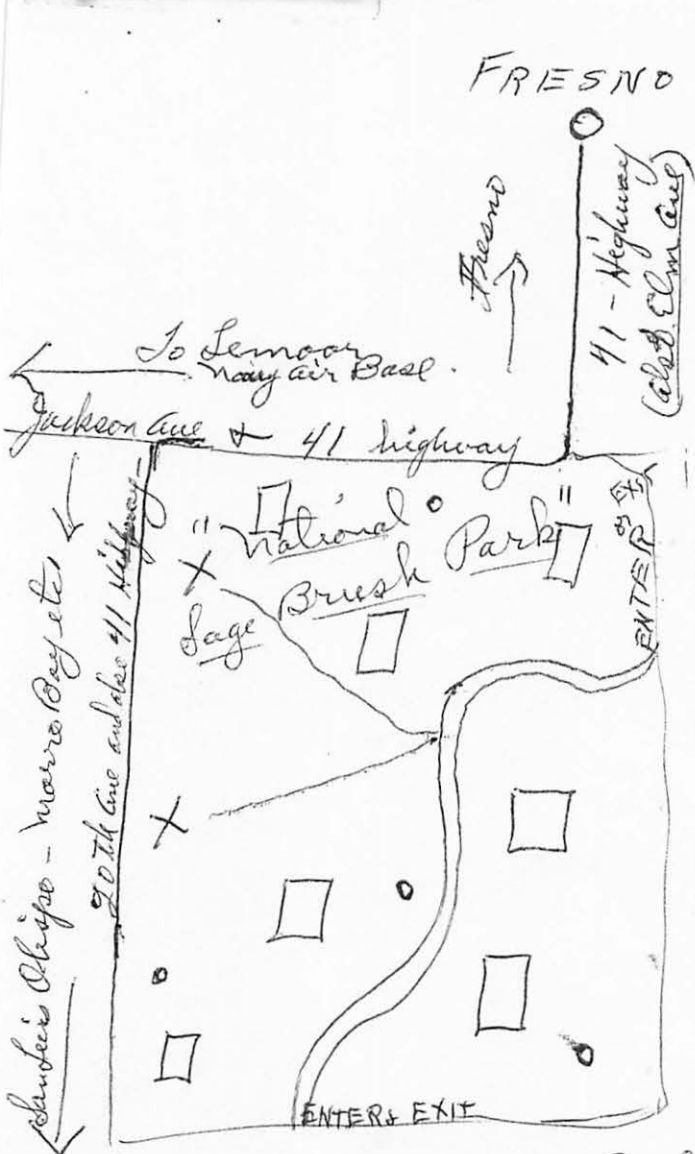

I'm not sure of the size of this area - But it's large enough for a little Park - like a roadside or National Park

There is no Roadside Parks between Fresno and Marro Bay - make this would be a good Place - X rest rooms - Picnic Area - Water taps - roads = Paths -

Respectfully yours -

716 Waterman Ave - Fresno Calif 93706 - Mrs & Mrs Ocie Randall

T. Schlafman 11/28
J. Bright for
R. Dickenson 11/28
C. Dale 11/28

Post 11-29

DEC 4 - 1967

158-10

Dear Mr. and Mrs. Randall:
716 Waterman Avenue
Fresno, California 93706

Dear Mr. and Mrs. Randall:

On behalf of President Johnson, thank you for your recent letter in which you urge the creation of a "National Sage Brush Park."

We share your concern for preserving the natural environment. Currently, many agencies, both State and Federal, are reviewing the potential of a great many sites that would undoubtedly merit strong consideration for addition to the National Park System. The site you suggest is an interesting one, but in our opinion, not one of national significance.

We feel, therefore, that the California Department of Parks and Recreation would be the agency in the best position to give your proposal the consideration it deserves. You may wish to write to that agency at the following address:

Department of Parks and Recreation
Room 1416
Resource Building
1416 Ninth Street
Sacramento, California 95814

Enclosed for your use and interest is a booklet entitled "NPS Criteria For Parklands." Thank you for your interest in the National Park Service. We hope that you are successful in your endeavor.

Sincerely yours,

(SGD) THEODOR R. SWEM

Assistant Director

Enclosure

cc:
DAL, Mr. Melvin
C, Mrs. Reiner
TSchafman:pj 11/29/67

Handwritten signature and date: 11-29