

KEY TO UNITS

-1-	COOK	8'x8' CANVAS
-2-	FOOD SUPPLIER	6'x6'
-3-	CABINAGE BACK	2'-2' FRAME
-4-	KITCHEN	10'x10' CANVAS
-5-	MEN'S UNIT	10'x11'
-6-7-8-	STAFF QUARTERS	9'x8'
-9-10-	TOILET	10'x10'
-11-	LATRINE	1'-10" FRAME
-12-	ESCAPE PIT	ESCAPAYS
-13-	WOOD BURNING STOVE	10'x10' FRAME
-14-	DISPATCH OFFICE	10'x10' CANVAS

NOTE #1:-

IF DESIRED, CANVAS PLYS MAY BE USED INSTEAD OF BUILT-UP BRICKS OR FRAME UNITS DURING WILD SEASONS.

NOTE #2:-

FOR COMPLETE TECHNICAL DETAILS SEE SHEETS # 1, 2, 3 & 4, 7, 8, 9. THESE DETAILS SHALL BE MODIFIED IN ACC. TO SITU. REQUIS. ELEMENTS OF THIS CAMP AS LISTED ABOVE.

LATRINE TO HAVE 2 BAKES
WASH UNIT TO HAVE 2 BAKES
TOILETS UNIT TO HAVE 2 TOILETS HEADS

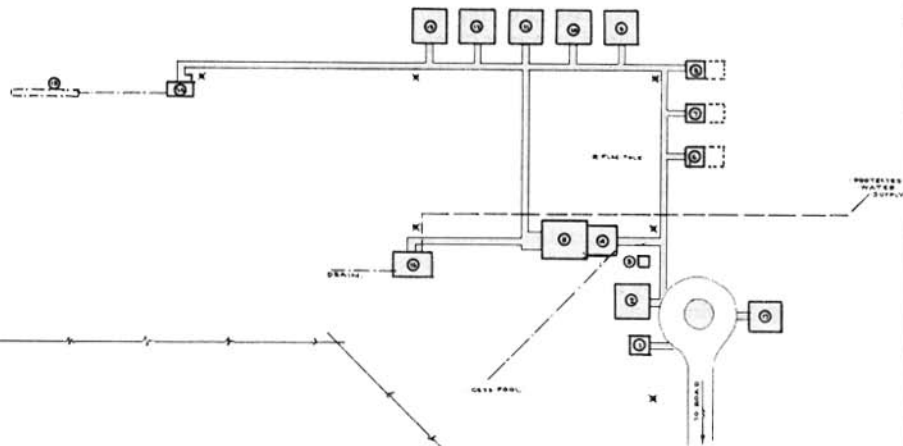

TYPICAL 25-MAN CAMP

SYMBOLS:

--- WATER LINES
--- SEWER LINES
X OUTSIDE POLE LIGHTS

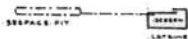

MOBILE CAMP UNITS - ALL CANVAS

ALL MEN SUPPLIES WITH INFANTRY PACK CANTEN & PESTICIDE FOR BATHING USE. INDIVIDUAL WASH BATH OR STREAM IN WILDLANDS OUT OF BASE CAMP. FIVE BANG BATTERIES MADE BY EACH MAN. THIS ILLUMINATING KITCHEN UNIT 14'-6" HIGH THAT IS DESIRABLE FOR SHELTER PURPOSES. USE IMPROVED TENT POLES & STAKES. PROVIDE STERILIZING WATER BAG AND CHLORIDE OF LIME CAPSULES WITH EACH MAN.

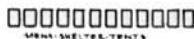

MEN'S SHELTER, TENTS

STAFF
QUARTERS

PROTECTED
WOOD BURNING
STOVE

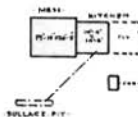

MOBILE 25-MAN CAMP

CAMPS FOR 25 MEN - TYPICAL - MOBILE

EMERGENCY CONSERVATION WORK
ROBERT TECHNER DIRECTOR

LABOR CAMPS -
FOR REFORESTATION PROJECTS

PREPARED BY
U. S. DEPARTMENT OF AGRICULTURE
FOREST SERVICE
ROBERT J. STUART, CHIEF FORESTER

DATE

4-15-35

SCALE

1" = 20'

APPROX. 1935

DATE

1-1-35

SHEET NO.

1-1

OF 35