



ASHLAND FOREST RESERVE





OREGON

WILLAMETTE MERIDIAN AND BASE

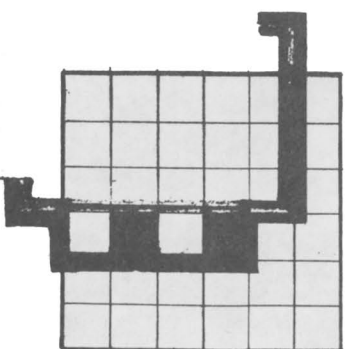
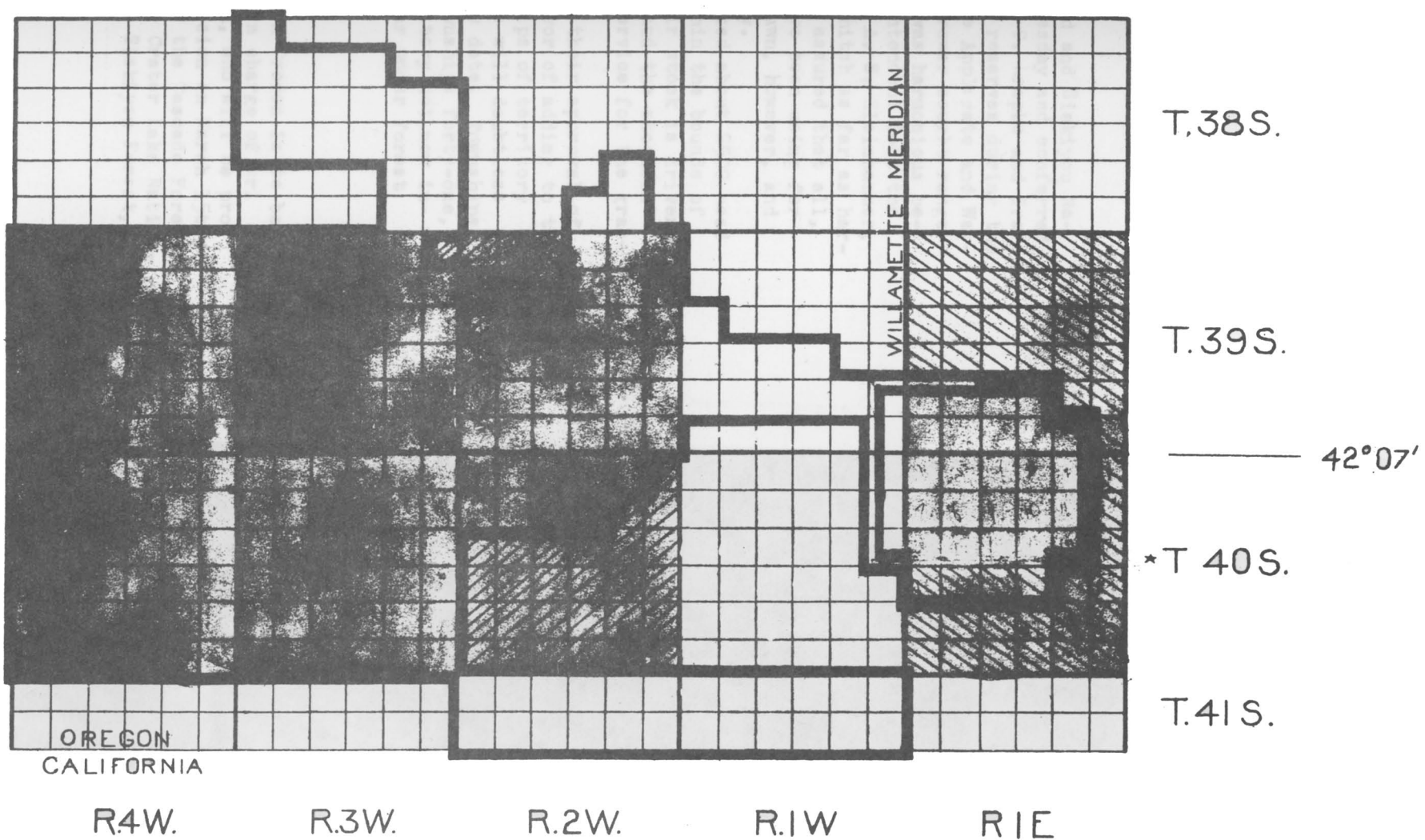
FOREST SERVICE U.S. DEPT. OF AGRICULTURE
1907

-  FOREST RESERVE BOUNDARY MARCH 2, 1907
-  NATIONAL FOREST BOUNDARY SEPT. 28, 1893
-  NATIONAL FOREST BOUNDARY APRIL 24, 1906



-  Withdrawn Mar. 5, 1892
-  Released Nov. 9, 1893
(SET. ENT. FEB. 10, 1894)
-  Withdrawn May 23, 1902
-  Withdrawn Dec 17, 1906 (SISKIYOU)
-  Released May 6, 1907 (SISKIYOU)
(SET. JULY 23, 1907. ENT. AUG. 22, 1907)

MAR 2 1907

45°42' W. from Washington

R1E