

United States Department of the Interior
National Park Service



MAR 25 1991

National Register of Historic Places
Registration Form

NATIONAL
REGISTER

This form is for use in nominating or requesting determinations of eligibility for individual properties or districts. See instructions in *Guidelines for Completing National Register Forms* (National Register Bulletin 16). Complete each item by marking "x" in the appropriate box or by entering the requested information. If an item does not apply to the property being documented, enter "N/A" for "not applicable." For functions, styles, materials, and areas of significance, enter only the categories and subcategories listed in the instructions. For additional space use continuation sheets (Form 10-900a). Type all entries.

1. Name of Property

historic name Good Spring Baptist Church and Cemetery
other names/site number T-43, C-11

2. Location

street & number Mammoth Cave National Park (MACA) not for publication NA
city, town Mammoth Cave vicinity NA
state Kentucky code KY county Edmonson code 061 zip code 42259

3. Classification

Ownership of Property	Category of Property	Number of Resources within Property	
		Contributing	Noncontributing
<input type="checkbox"/> private	<input checked="" type="checkbox"/> building(s)	<u>1</u>	<u> </u> buildings
<input type="checkbox"/> public-local	<input type="checkbox"/> district	<u>1</u>	<u> </u> sites
<input type="checkbox"/> public-State	<input type="checkbox"/> site	<u> </u>	<u> </u> structures
<input checked="" type="checkbox"/> public-Federal	<input type="checkbox"/> structure	<u> </u>	<u> </u> objects
	<input type="checkbox"/> object	<u>2</u>	<u>0</u> Total

Name of related multiple property listing: Historic Resources of Mammoth Cave National Park
Number of contributing resources previously listed in the National Register 0

4. State/Federal Agency Certification

As the designated authority under the National Historic Preservation Act of 1966, as amended, I hereby certify that this nomination request for determination of eligibility meets the documentation standards for registering properties in the National Register of Historic Places and meets the procedural and professional requirements set forth in 36 CFR Part 60. In my opinion, the property meets does not meet the National Register criteria. See continuation sheet.
Chapman 3/20/91
Signature of certifying official Date
National Park Service
State or Federal agency and bureau

In my opinion, the property meets does not meet the National Register criteria. See continuation sheet.
David L. Morgan Jan. 8, 1991
Signature of commenting or other official Date
State Historic Preservation Officer, Kentucky Heritage Council
State or Federal agency and bureau

5. National Park Service Certification

I, hereby, certify that this property is:
 entered in the National Register. Patrick Andrus 5/8/91
 See continuation sheet.
 determined eligible for the National Register. See continuation sheet.
 determined not eligible for the National Register.
 removed from the National Register.
 other, (explain:)
for Signature of the Keeper Date of Action

6. Function or Use

Historic Functions (enter categories from instructions)

Religion:religious structure

Funerary:cemetery

Current Functions (enter categories from instructions)

Religion:religious structure

Funerary:cemetery

7. Description

Architectural Classification

(enter categories from instructions)

No style

Materials (enter categories from instructions)

foundation sandstone

walls wood:weatherboard

roof tin

other

Describe present and historic physical appearance.

United States Department of the Interior
National Park ServiceNational Register of Historic Places
Continuation SheetHistoric Resources of Mammoth Cave National Park, MPS
Edmonson, Hart, and Barren Counties, Kentucky
Good Spring Baptist Church and CemeterySection number 7 Page 1

7. Description of present and historic physical appearance.

The Good Spring Baptist Church property, located on the north side of the Green River, approximately 1.5 miles southwest of the Mammoth Cave Ferry Rd. on a gravel access road consists of one contributing building, Good Spring Baptist Church and one contributing site, the church cemetery.

Constructed around the turn of the century, Good Spring Baptist Church is a one story frame building with white weather-board siding and a tin, gable front roof. The building, which faces east, sits on a sandstone block foundation, measures 38 feet (E-W) by 26 feet (N-S), and has two front doors, each with four panels, a transom, and sandstone entry steps. Each side wall has three four-over-four double-hung sash windows with batten shutters. A wooden sign in between the two front entrances notes the following: "Estab. 1842, Good Spring United Baptist Church." A chimney is centered on the ridgeline of the roof. In front of the church is a semi-circular gravel drive which extends from the access road.

The church's interior is unadorned, with wood planked walls and floor, exposed rafter beams on the ceiling, and two square support columns. There are a number of movable hand-made pews set in rows facing the podium in the east end of the church. On the east and west walls are a number of hat and coat pegs extending from a wooden strip which covers the width of the building.

To the southwest of the church is Good Spring cemetery, which dates from the early nineteenth century and measures approximately 500' (E-W) by 190' (N-S). All of the graves face east, which is consistent with local tradition, and are designated predominantly with commercially produced head and foot markers. There are also a number of graves marked with field-stone head and foot stones, both engraved and unengraved, and also some unmarked graves. There are several large juniper trees and a pine tree in the cemetery and evidence of an old wire fence in the wooded areas on the north and east sides of the cemetery.

**United States Department of the Interior
National Park Service**

**National Register of Historic Places
Continuation Sheet**

Historic Resources of Mammoth Cave National Park, MPS
Edmonson, Hart, and Barren Counties, Kentucky
Good Spring Baptist Church and Cemetery

Section number 7 Page 2

The Good Spring Baptist Church property is in good condition. The church building is structurally sound, well-maintained, and is original in design, workmanship, and the majority of materials. The original metal roof was replaced in kind sometime in the last decade. The cemetery is also well-maintained and is still in use. For the entire property, integrity of location, setting, design, materials, workmanship, feeling, and association are intact.

8. Statement of Significance

Certifying official has considered the significance of this property in relation to other properties:

nationally statewide locally

Applicable National Register Criteria A B C D

Criteria Considerations (Exceptions) A B C D E F G

Areas of Significance (enter categories from instructions)

Social History

Period of Significance

ca. 1900 to 1941

Significant Dates

ca. 1900

Cultural Affiliation

N/A

Significant Person

N/A

Architect/Builder

N/A

State significance of property, and justify criteria, criteria considerations, and areas and periods of significance noted above.

See continuation sheet

9. Major Bibliographical References

Previous documentation on file (NPS):

- preliminary determination of individual listing (36 CFR 67) has been requested
- previously listed in the National Register
- previously determined eligible by the National Register
- designated a National Historic Landmark
- recorded by Historic American Buildings Survey # _____
- recorded by Historic American Engineering Record # _____

See continuation sheet

Primary location of additional data:

- State historic preservation office
- Other State agency
- Federal agency
- Local government
- University
- Other

Specify repository: _____

10. Geographical Data

Acreage of property _____

UTM References

A
Zone Easting Northing

B
Zone Easting Northing

C

D

See continuation sheet

Verbal Boundary Description _____

See continuation sheet

Boundary Justification _____

See continuation sheet

11. Form Prepared By

name/title Kelly A. Lally, consultant
organization Kentucky Heritage Council date June 1989
street & number 701 D Daniels ST. telephone 919-828-9123
city or town Raleigh state NC zip code 27605

**United States Department of the Interior
National Park Service**

**National Register of Historic Places
Continuation Sheet**

Historic Resources of Mammoth Cave National Park, MPS
Edmonson, Hart, and Barren Counties, Kentucky
Good Spring Baptist Church and Cemetery

Section number 8 Page 1

8. Statement of significance, criteria justification, criteria considerations, and areas and periods of significance.

The Good Spring Baptist Church property is historically significant in the area of Social History and represents the property type "Church Properties" (for property type information, see Section III of the Historic Resource Study, pages A-6 to A-8).

The period of significance (ca. 1900 to 1941) refers to the years from the construction of the current church building to the demise of the community with the official establishment of Mammoth Cave National Park in 1941.

As in other parts of rural Kentucky, churches in the Mammoth Cave area, mostly of the Baptist denomination, served as the centers of community life. Local residents attended weekly church services, weddings, funerals, baptisms, homecomings, revivals, and grave decoration days, not only for spiritual reasons, but also to interact with other people who lived in the area. In such a rural area, where the nearest substantial town was ten miles away over very poor dirt roads, community gatherings were very important. In addition to church functions, communities often used their churches as meeting houses and schools as well.

Before Mammoth Cave National Park was developed, there were seven churches which served the communities in the immediate cave area. During the 1930s, most private and public properties within the proposed park area were acquired by the Mammoth Cave National Park Association, the Mammoth Cave National Park Commission, and the National Park Service through purchase or condemnation, local residents were removed, and buildings were razed. Church properties were exceptions to the removal and demolition process. Although not required to do so, the National Park Service recognized the significance that church properties had for local communities. In return for the donation of community-owned church properties, the National Park Service agreed to grant special use permits to the congregations who wished to maintain the location of their churches. Currently there are three churches located within the boundaries of Mammoth Cave National Park which have agreements with the National Park Service: Mammoth Cave Baptist Church, Good Spring Baptist Church, and Joppa Baptist Church.

United States Department of the Interior
National Park Service

**National Register of Historic Places
Continuation Sheet**

Historic Resources of Mammoth Cave National Park, MPS
Edmonson, Hart, and Barren Counties, Kentucky

Section number 8 Page 2

Good Spring Baptist Church and Cemetery

Good Spring Baptist Church, established as a congregation in 1842, served the community of Cade and residents of the Maple Springs area, as well as families residing on the north side of the Green River. The current building was constructed ca. 1900. The Davis's, Demunbrun's and Vincent's were among the families belonging to Good Spring Baptist Church. The congregation requested and was granted a special use permit which allowed them to continue to use the church and cemetery, provided National Park Service guidelines were followed. The church and cemetery were used regularly through the 1950s and 1960s. Currently members of the congregation meet several times a year for funerals and burials, grave decoration days, and homecomings.

Though Good Spring Baptist Church is a religious property, it deserves exceptional status as the only physical representative of the once thriving Cade/Maple Springs area community, and as a reminder of part of the process of developing Mammoth Cave National Park through agreements between the National Park Service and local communities.

United States Department of the Interior
National Park Service

**National Register of Historic Places
Continuation Sheet**

Historic Resources of Mammoth Cave National Park, MPS
Edmonson, Hart, and Barren Counties, Kentucky
Good Spring Baptist Church and Cemetery

Section number 9 Page 1

9. Major Bibliographical References

Bridwell, Margaret. "A Brief History of Mammoth Cave National Park." Manuscript, Mammoth Cave National Park Library, Mammoth Cave, KY, 1952.

Lally, Kelly A. Tape Recorded interview with residents of the Mammoth Cave area, part of the oral history project, "The Civilian Conservation Corps and the Development of Mammoth Cave National Park." Mammoth Cave National Park Library, Mammoth Cave, KY, June to September 1987.

Lee, Kenneth, From the Silent Grove. Glasgow, KY: By the Author, 1972.

_____ Jacob's People. Glasgow, KY: By the Author, n.d.

_____ Near Elko. Glasgow, KY: By the Author, 1973.

Martin, Charles E. Cultural Landscape of the Pennyrile Region. Draft, State Historic Preservation Office, Frankfort, KY, 1988.

Strange, Richard N. "Memorandum to the Superintendent." Mammoth Cave National Park Library, Mammoth Cave, KY, 18 March 1985.

United States Department of the Interior
National Park Service

**National Register of Historic Places
Continuation Sheet**

Section number 10 Page 1 Historic Resources of Mammoth Cave National Park, MPS
Edmonson, Hart, and Barren Counties, Kentucky
Good Spring Baptist Church and Cemetery

10. Geographical Data

Acreage of property: approximately 2 acres

UTM References

A 16 4118180 575600

Verbal Boundary Description

Beginning at a point where the Good Spring Church access road meets the gravel drive, proceed 200' west along the drive and the southern edge of the Good Spring Loop Trail. Then proceed 75' south along the edge of the woodline. Then proceed 340' along the woodline on the northern side of the cemetery. Then proceed 140' south along the woodline at the western edge of the cemetery. Then proceed 240' along the woodline on the southern edge of the cemetery. Then proceed 340' northeast along a park trail to the point of origin.

Boundary Justification

The boundary includes the land, church, and all visible graves in the cemetery that are historically associated with the property.

GOOD SPRING CHURCH
AND CEMETERY
 (T-43 + C-11)

GOOD SPRING
 CEMETERY

WOODLINE

WOODLINE

WOODLINE

GOOD SPRING LOOP TRAIL

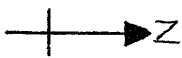

APPROX. SCALE: 1 INCH = 60 FEET

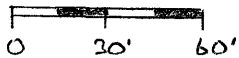

LEGEND

— — — — — = BOUNDARY

////// = BOUNDARY LIES ON WOODLINE

+ + = APPROX EXTENT OF GRAVEYARD.

+ +

2 photos

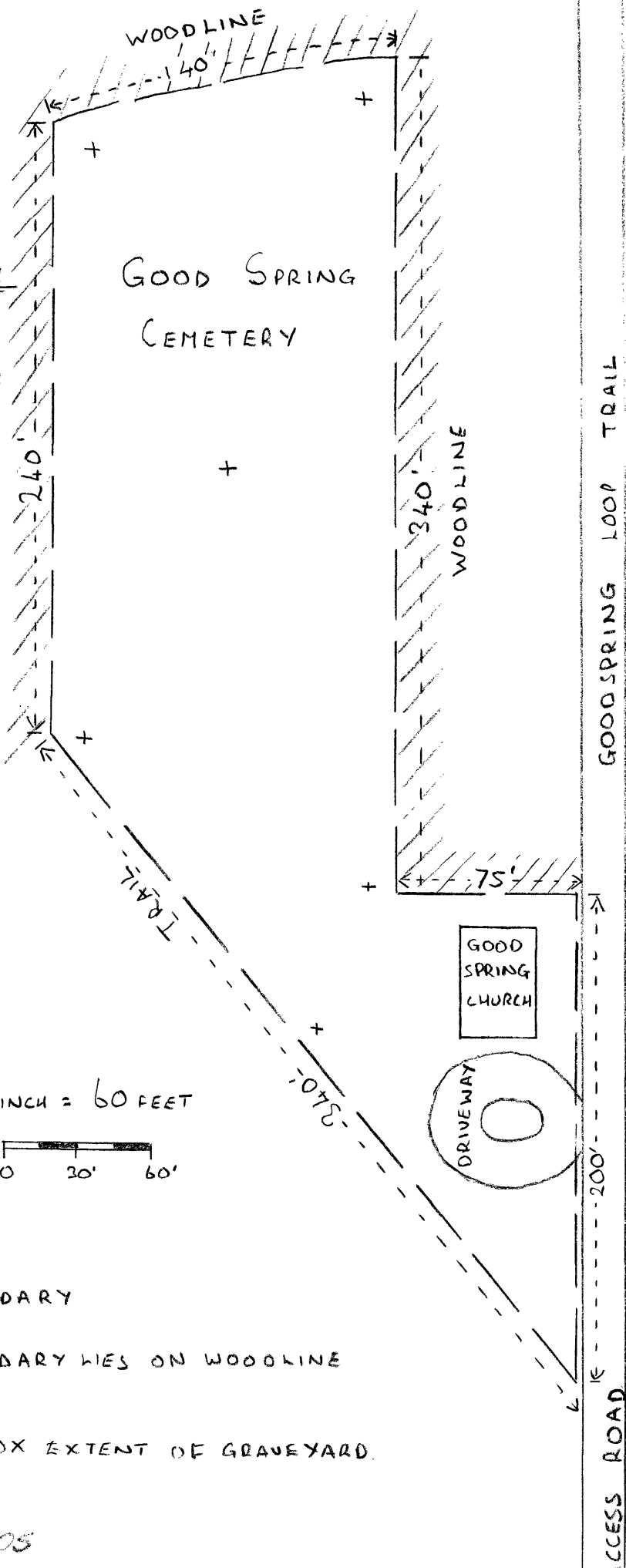



1. Good Spring Baptist Church (T-43)
Mammoth Cave National Park, Kentucky

Good Spring Baptist Church (T-43)

Mammoth Cave Nat'l Park

Mammoth Cave, Ky

Kelly Lally

November 1987

Mammoth Cave Nat'l Park Library

Southwest view



2. Good Spring Baptist Church (T-43) and Cemetery (C-11)
Mammoth Cave National Park, Kentucky

Good Spring Baptist Church (T-43)
and Cemetery (C-11)

Mammoth Cave Nat'l Park
Mammoth Cave, Ky

Kelly Lally

November 1987

Mammoth Cave Nat'l Park Library

Northeast view