

NATIONAL REGISTER OF HISTORIC PLACES
INVENTORY - NOMINATION FORM
FOR FEDERAL PROPERTIES

(Type all entries - complete applicable sections)

STATE:

Idaho

COUNTY:

Idaho

FOR NPS USE ONLY

ENTRY DATE

JUL 18 1974

1. NAME

COMMON:

White Bird Battlefield - Site 13

AND/OR HISTORIC:

Nez Perce National Historical Park

2. LOCATION

STREET AND NUMBER:

Off U.S. 95 one mile north

CITY OR TOWN:

White Bird

CONGRESSIONAL DISTRICT:

First

STATE:

Idaho

CODE

16

COUNTY:

Idaho

CODE

049

3. CLASSIFICATION

CATEGORY
(Check One)

- ☐ District ☐ Building
☒ Site ☐ Structure
☐ Object

OWNERSHIP

- ☒ Public
☐ Private
☐ Both

Public Acquisition:

- ☐ In Process
☐ Being Considered

STATUS

- ☐ Occupied
☒ Unoccupied
☐ Preservation work
in progress

ACCESSIBLE
TO THE PUBLIC

- Yes:
☒ Restricted
☐ Unrestricted
☐ No

PRESENT USE (Check One or More as Appropriate)

- ☒ Agricultural ☒ Government ☒ Park
☐ Commercial ☐ Industrial ☒ Private Residence
☐ Educational ☐ Military ☐ Religious
☐ Entertainment ☐ Museum ☐ Scientific

☐ Transportation☐ Comments☒ Other (Specify)Also highway
pullouts

4. AGENCY

National Park Service

REGIONAL HEADQUARTERS: (If applicable)

Pacific Northwest Region

CITY OR TOWN:

Seattle

STREET AND NUMBER:

4th and Pike Building

STATE:

Washington

CODE

053

5. LOCATION OF LEGAL DESCRIPTION

COURTHOUSE, REGISTRY OF DEEDS, ETC:

Idaho County Courthouse

STREET AND NUMBER:

CITY OR TOWN:

Grangeville

STATE:

Idaho

CODE

16

6. REPRESENTATION IN EXISTING SURVEYS

TITLE OF SURVEY:

Land ownership map

DATE OF SURVEY: 1969

☒ Federal☐ State☐ County☐ Local

DEPOSITORY FOR SURVEY RECORDS:

Denver Service Center - National Park Service

STREET AND NUMBER:

7200 W. Alameda Avenue

CITY OR TOWN:

Denver

STATE:

Colorado

CODE

08

SEE INSTRUCTIONS

STATE:

COUNTY:

ENTRY NUMBER

DATE

FOR NPS USE ONLY

7. DESCRIPTION

CONDITION	(Check One)					
	<input type="checkbox"/> Excellent	<input checked="" type="checkbox"/> Good	<input type="checkbox"/> Fair	<input type="checkbox"/> Deteriorated	<input type="checkbox"/> Ruins	<input type="checkbox"/> Unexposed
	(Check One)			(Check One)		
	<input checked="" type="checkbox"/> Altered	<input type="checkbox"/> Unaltered	<input type="checkbox"/> Moved	<input checked="" type="checkbox"/> Original Site		

DESCRIBE THE PRESENT AND ORIGINAL (if known) PHYSICAL APPEARANCE

The present site is enclosed by a major highway - U.S. 95 - on the west and old U.S. 95 on the east. It has been bisected by farms, highway construction, and pioneer roads, and criss-crossed with barb-wire fences. It is grazed on by sheep and cattle and 300 acres are planted in alfalfa. Lichen covered basaltic rock cliffs and outcrops are scattered throughout the area. There is a life estate farm (30 acres) in the bottom land on the east.

The original site was a natural open grassland covering the hillsides with cottonwood lined creeks along the bottomland.

There are 1900 acres of Class VI lands either owned or placed under senic easement by the National Park Service.

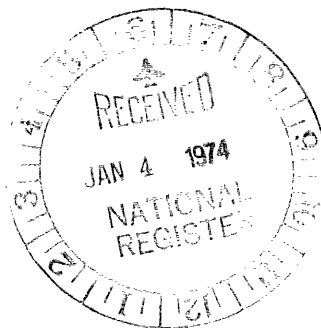

SEE INSTRUCTIONS

SEE INSTRUCTIONS

8. SIGNIFICANCE			
PERIOD (Check One or More as Appropriate)			
<input type="checkbox"/> Pre-Columbian	<input type="checkbox"/> 16th Century	<input type="checkbox"/> 18th Century	<input type="checkbox"/> 20th Century
<input type="checkbox"/> 15th Century	<input type="checkbox"/> 17th Century	<input checked="" type="checkbox"/> 19th Century	
SPECIFIC DATE(S) (If Applicable and Known) 1877			
AREAS OF SIGNIFICANCE (Check One or More as Appropriate)			
<input type="checkbox"/> Aboriginal	<input type="checkbox"/> Education	<input checked="" type="checkbox"/> Political	<input type="checkbox"/> Urban Planning
<input type="checkbox"/> Prehistoric	<input type="checkbox"/> Engineering	<input checked="" type="checkbox"/> Religion/Philosophy	<input type="checkbox"/> Other (Specify)
<input checked="" type="checkbox"/> Historic	<input type="checkbox"/> Industry	<input type="checkbox"/> Science	
<input type="checkbox"/> Agriculture	<input type="checkbox"/> Invention	<input type="checkbox"/> Sculpture	
<input type="checkbox"/> Architecture	<input type="checkbox"/> Landscape Architecture	<input checked="" type="checkbox"/> Social/Humanitarian	
<input type="checkbox"/> Art	<input type="checkbox"/> Literature	<input type="checkbox"/> Theater	
<input type="checkbox"/> Commerce	<input checked="" type="checkbox"/> Military	<input type="checkbox"/> Transportation	
<input type="checkbox"/> Communications	<input type="checkbox"/> Music		
<input type="checkbox"/> Conservation			
STATEMENT OF SIGNIFICANCE			
<p>On June 17, 1877 the first battle of the Nez Perce War was fought. Here some 750 Indians began an 1800 mile trek lasting four months, fighting all the way. Some 2000 American soldiers were engaged during the war, nearly 200 were killed and another 150 wounded. The Indians lost about 120. When it ended in the Bear's Paw Mountains in northern Montana on October 5, 418 Nez Percés surrendered. The remaining Indians escaped, to Canada.</p> <p>The war started when three young men of White Bird's band raided homes and ranches along White Bird, John Day, and Slate Creeks south of this site. Perhaps 12 white people had been murdered; the atrocities caused the other whites to band together for protection. Also camped here was Chief Joseph and his band of Wallowa Nez Percés. He had been forced to leave his native country in northeast Oregon to move onto the smaller reservation specified in the 1863 treaty.</p> <p>When reports of these depredations reached General O. O. Howard at Fort Lapwai, he ordered Captain David Perry and two companies of cavalry to investigate. Four officers and 99 troopers started on the night of June 15 and arrived at the Indian encampment here at dawn, two days later. With Perry also were 11 citizen volunteers who had joined him along the way.</p> <p>Perry hoped to avoid bloodshed; so did most of the Indians. It is not clear as to what actually happened; evidence indicates that one of the volunteers fired at a peace party of Indians from the east side of one of the two buttes which are located at the south end of the battlefield. From that moment a fight could not be averted.</p> <p>Perry had lined his two companies up on the north side of the buttes but fate interfered with communications; both buglers had misplaced their bugles. The Indians, unseen by the troops, swarmed around both sides of the buttes and nearly engulfed the command.</p> <p>Outflanked and unable to hear bugle messages or the officer's shouts, the undisciplined army began a retreat which soon became a rout. Many of the men were little more than raw recruits. Fortunately for Perry, most of the soldiers were not completely surrounded and the resulting battle was a running, chasing affair.</p>			

9. MAJOR BIBLIOGRAPHICAL REFERENCES

The Flight of the Nez Perce, Brown, Mark H., 1967
The Nez Perce and the Opening of the Northwest, Josephy, Alvin M., Jr., 1965
The Nez Percés, Haines, 1955
Forlorn Hope, National Park Service, 1968

10. GEOGRAPHICAL DATA

LATITUDE AND LONGITUDE COORDINATES DEFINING A RECTANGLE LOCATING THE PROPERTY			O R	LATITUDE AND LONGITUDE COORDINATES DEFINING THE CENTER POINT OF A PROPERTY OF LESS THAN TEN ACRES		
CORNER	LATITUDE	LONGITUDE		LATITUDE	LONGITUDE	
	Degrees Minutes Seconds	Degrees Minutes Seconds		Degrees Minutes Seconds	Degrees Minutes Seconds	
NW	45° 49' 48"	116° 17' 03"		° ' "	° ' "	
NE	45° 49' 48"	116° 15' 00"				
SE	45° 46' 20"	116° 15' 00"				
SW	45° 46' 20"	116° 18' 19"				

APPROXIMATE ACREAGE OF NOMINATED PROPERTY: 1900

LIST ALL STATES AND COUNTIES FOR PROPERTIES OVERLAPPING STATE OR COUNTY BOUNDARIES

STATE:	CODE	COUNTY:	CODE
STATE:	CODE	COUNTY:	CODE
STATE:	CODE	COUNTY:	CODE
STATE:	CODE	COUNTY:	CODE

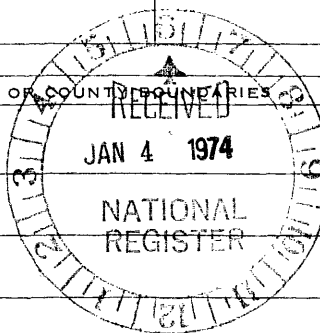

SEE INSTRUCTIONS
 555499
 N5075250
 E553340
 N5068780
 555400
 N5368755
 5555090
 N5075
 220
 274HF

11. FORM PREPARED BY

NAME AND TITLE: Jack R. Williams, Superintendent and Laurin C. Huffman II		DATE: March 15, 1973
BUSINESS ADDRESS:		
STREET AND NUMBER: P.O. Box 93		PHONE: 206-442-4530
CITY OR TOWN: Spalding	STATE: Idaho	CODE: 16

12. CERTIFICATION OF NOMINATION

<p>State Liaison Officer recommendation:</p> <p><input checked="" type="checkbox"/> Yes <input type="checkbox"/> No <input type="checkbox"/> None</p> <p><i>Merle W. Wells</i> State Liaison Officer Signature</p> <p>In compliance with Executive Order 11593, I hereby nominate this property to the National Register, certifying that the State Liaison Officer has been allowed 90 days in which to present the nomination to the State Review Board and to evaluate its significance. The recommended level of significance is <input checked="" type="checkbox"/> National <input type="checkbox"/> State <input type="checkbox"/> Local</p> <p><i>Victor E. Dahlberg</i> Federal Representative Signature</p> <p>12/20/73 Date</p> <p>Acting Regional Director Title</p>	<p>NATIONAL REGISTER VERIFICATION</p> <p>I hereby certify that this property is included in the National Register.</p> <p><i>A. H. Hartsen</i> Director, Office of Archeology and Historic Preservation</p> <p>7/18/74 Date</p> <p>ATTEST: <i>Laurin C. Huffman II</i> Keeper of The National Register</p> <p>7-17-74 Date</p>
--	---

**NATIONAL REGISTER OF HISTORIC PLACES
INVENTORY - NOMINATION FORM**

(Continuation Sheet)

STATE Idaho	
COUNTY Idaho	
FOR NPS USE ONLY	
ENTRY NUMBER	DATE
	JUL 18 1974

(Number all entries)

8. SIGNIFICANCE

Statement of Significance: (cont.)

Somehow, most of the troops reached the steep road up White Bird Mountain and made it over the top of Mount Idaho where a stop was made to rest, tend the wounded, and await reinforcements. Perry had 34 men killed; the Indians none, although three or four were wounded.

The Nez Perces wanted no further trouble and attempted to escape. Soon, General Howard, with about 250 reinforcements, was in hot pursuit of the hostiles, but he did not catch up with them until July 11 on the Clearwater River.

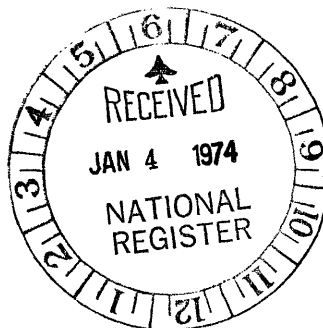

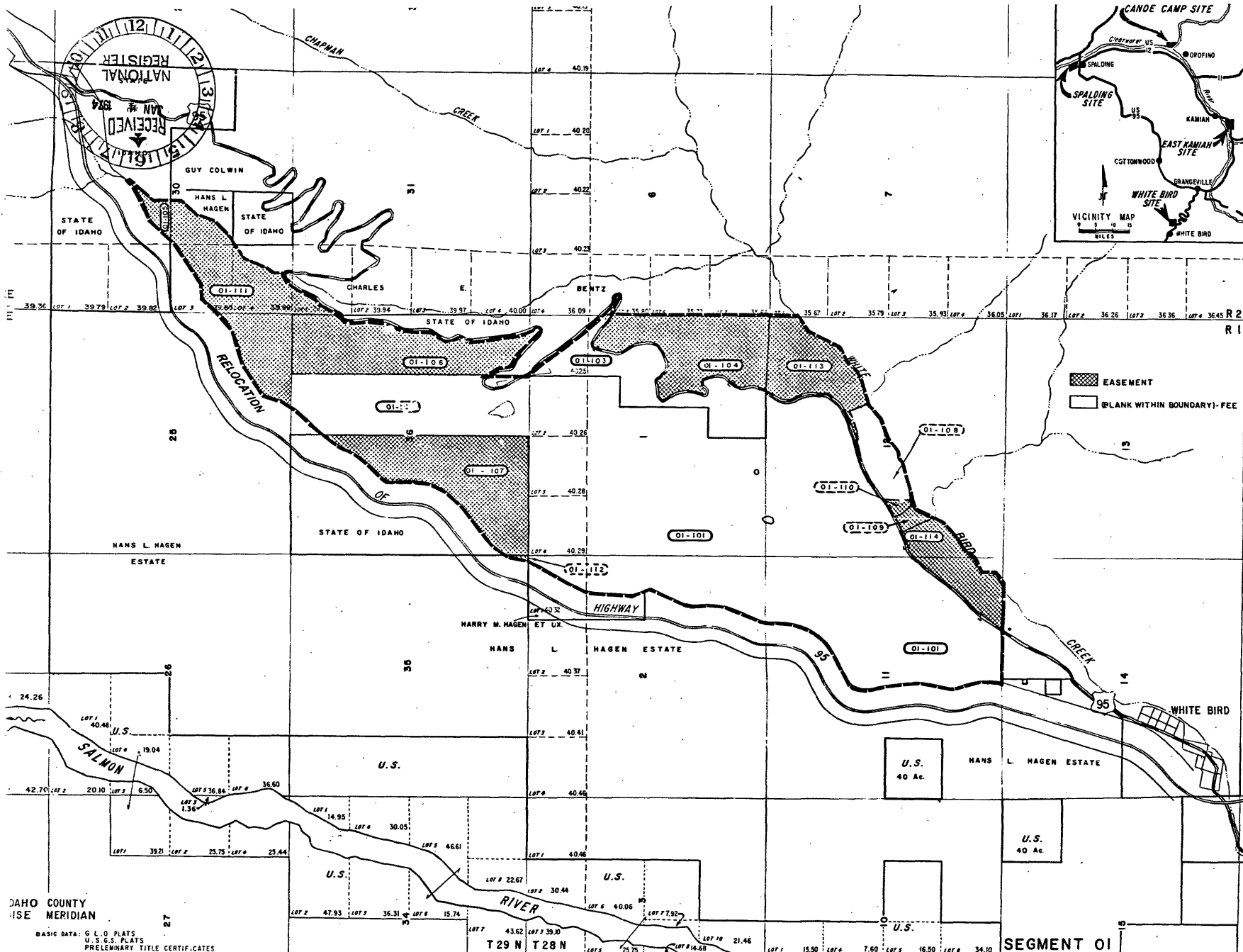

TRACT REGISTER	
TRACT No.	NAME OF OWNER
01-100	Deleted
01-101	Hagen, Hans L., Estate, et al.
01-102	Deleted
01-103	Bentz, Charles E., et ux.
01-104	Bentz, Charles E., et ux.
01-105	Idaho, State of
01-106	Idaho, State of
01-107	Idaho, State of
01-108	Price, Dry, et ux.
01-109	Richman, Verna, et al.
01-110	Viverson, Wilson
01-111	Hagen, Hans L., Estate, et al. (01-102)
01-112	Hagen, Hans L., Estate, et al. (01-103)
01-113	Hagen, Hans L., Estate, et al. (01-102)
01-114	Hagen, Hans L., Estate, et al. (01-102)

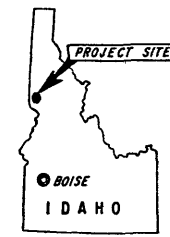

REVISIONS	
DATE	NATURE OF REVISIONS
1-25-67	7-68 Relocation of proposed Highway 95, tract boundary numbering
10-27-68	Accepted National Fee & Easement Areas
16 July 69	Changed Tract Nos. as noted above in Register
28 June 70	Removed addition areas & deletion areas
28 June 70	Changed 01-100 from EASEMENT to FEE

UNITED STATES DEPARTMENT OF THE
NATIONAL PARK SERVICE

OFFICE OF LAND & WATER RIGHTS SSC

TITLE OF DRAWING:
LAND OWNERSHIP MAP

NAME OF PARK:
NEZ PERCE NHP

LOCATION WITHIN PARK:
WHITE BIRD SITE

IDAHO COUNTY
ISE MERIDIAN

BASIC DATA: G.L.O. PLATS
U.S.G.S. PLATS
PRELIMINARY TITLE CERTIFICATES

HAL F-SIZE REPRODUCTION



UNITED STATES DEPARTMENT OF THE INTERIOR
NATIONAL PARK SERVICE

NATIONAL REGISTER OF HISTORIC PLACES
PROPERTY PHOTOGRAPH FORM

(Type all entries - attach to or enclose with photograph)

1. NAME		
COMMON White Bird Battlefield Nez Perce Nat. Hist. Park	AND/OR HISTORIC	NUMERIC CODE (Assigned by NPS) JUL 18 1974

2. LOCATION		
STATE Idaho	COUNTY Idaho	TOWN Whitebird
STREET AND NUMBER		

One mile north of Whitebird off U.S. 95

3. PHOTO REFERENCE		
PHOTO CREDIT J.R. Williams	DATE 1973	NEGATIVE FILED AT Nez Perce Nat. Hist. Park

4. IDENTIFICATION
DESCRIBE VIEW, DIRECTION, ETC.

View of battlefield area looking west

