



Layout

In the early months of 1942, following America’s entry into World War II, President Franklin D. Roosevelt authorized the U.S. Army to remove nearly 110,000 people of Japanese ancestry from their homes and communities on the West Coast; two-thirds of whom were American citizens. Tule Lake was one of ten remote War Relocation Centers to which they were sent. Enclosed by barbed wire, the 7,400 acres devoted to the relocation center in Newell, CA contained barracks, mess halls, and administrative buildings to house the 29,490 incarcerated Japanese Americans and 1,200 military and civilian staff who lived there between May of 1942 and March of 1946.

Typical Block

Construction of the Tule Lake War Relocation Center began on April 15, 1942 and was designed to house 12,000 people. By September 1942 the population had reached 15,276. In 1943 Tule Lake became a segregation center and was expanded to accommodate 15,000, but despite attempts to accommodate all those sent to the center it nevertheless became overpopulated as it reached a peak population of 18,789.

The Tule Lake War Relocation Center had 74 residential blocks divided into eight wards. Each ward was separated by a 200 foot wide firebreak and most wards comprised of nine blocks. The exceptions to this were Ward 6, having only six blocks, and Ward 8, having thirteen blocks.

Each block had 14 residential barracks, (20 by 100 to 120 feet) which were typically divided into four to six rooms. WCCA policy was to allot a space of 200 square feet per couple. However, many families, regardless of family size, were housed in either 16ft by 20ft, 20ft by 20ft, or 24ft by 20ft rooms. Blocks typically had men’s and women’s

latrines and showers, laundry and ironing rooms, a recreation building, and a mess hall. Each block was designed to house approximately 300 people in an attempt to create a basic community unit.

Each room was furnished with a single light bulb hung from the ceiling, a coal burning pot-bellied stove, and up to eight cots. One outdoor faucet provided water for each barrack. Buildings originally built for recreation were eventually used for other purposes in each block, as stores, canteens, beauty parlors, barber shops, judo halls, or churches.

After the Tule Lake Segregation Center closed in 1946 the barracks were dispersed throughout the Tulelake basin, and turned into houses by homesteaders. Many of the other buildings are no longer on the site, but concrete slabs of the latrines and guard towers can still be found.

You can also see a partial barrack and guard tower at the Tulelake – Butte Valley fairgrounds museum

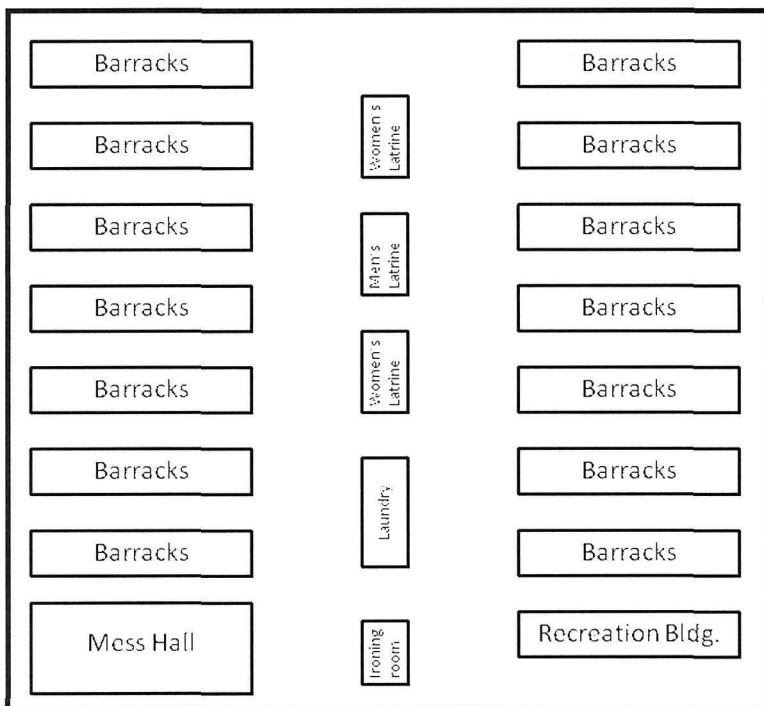

Typical Block Built in 1942

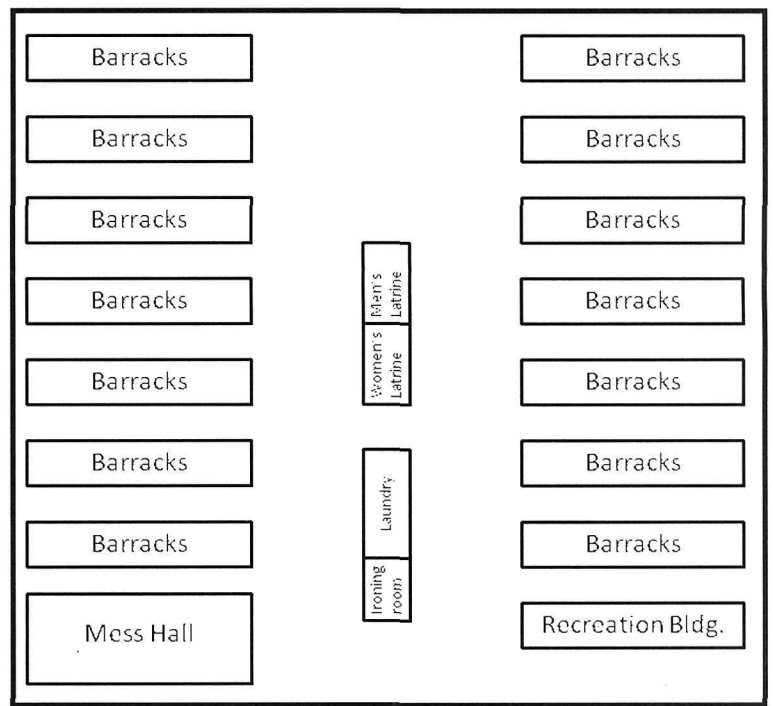

Typical Block Built After 1943

Enjoy your visit to the Tule Lake Segregation Center and please do your part to protect the site. Do not disturb or collect any natural or cultural resources, artifacts, or other objects both within park service property and on privately owned property.



- COMMUNITY BUILDINGS**
- NO. 1 FIRE STATION
 - NO. 2
 - NO. 3
 - NO. 4
 - NO. 5
 - NO. 6
 - NO. 7
 - NO. 8
 - NO. 9
 - NO. 10
 - NO. 11
 - NO. 12
 - NO. 13
 - NO. 14
 - NO. 15
 - NO. 16
 - NO. 17
 - NO. 18
 - NO. 19
 - NO. 20
 - NO. 21
 - NO. 22
 - NO. 23
 - NO. 24
 - NO. 25
 - NO. 26
 - NO. 27
 - NO. 28
 - NO. 29
 - NO. 30
 - NO. 31
 - NO. 32
 - NO. 33
 - NO. 34
 - NO. 35
 - NO. 36
 - NO. 37
 - NO. 38
 - NO. 39
 - NO. 40
 - NO. 41
 - NO. 42
 - NO. 43
 - NO. 44
 - NO. 45
 - NO. 46
 - NO. 47
 - NO. 48
 - NO. 49
 - NO. 50
 - NO. 51
 - NO. 52
 - NO. 53
 - NO. 54
 - NO. 55
 - NO. 56
 - NO. 57
 - NO. 58
 - NO. 59
 - NO. 60
 - NO. 61
 - NO. 62
 - NO. 63
 - NO. 64
 - NO. 65
 - NO. 66
 - NO. 67
 - NO. 68
 - NO. 69
 - NO. 70
 - NO. 71
 - NO. 72
 - NO. 73
 - NO. 74
 - NO. 75
 - NO. 76
 - NO. 77
 - NO. 78
 - NO. 79
 - NO. 80
 - NO. 81
 - NO. 82
 - NO. 83
 - NO. 84
 - NO. 85
 - NO. 86
 - NO. 87
 - NO. 88
 - NO. 89
 - NO. 90
 - NO. 91
 - NO. 92
 - NO. 93
 - NO. 94
 - NO. 95
 - NO. 96
 - NO. 97
 - NO. 98
 - NO. 99
 - NO. 100

- WATER SUPPLY**
- 1-7 WATER STORAGE TANKS
 - 1-7 WELL RAMP HOUSES
 - 1-7 WATER TREATMENT TANK
 - 1-7 WATER STORAGE TANK
- SANITARY FACILITIES**
- 2-1 SLUDGE BEDS
 - 2-1 PUMP HOUSE STATION
 - 2-1 BATH SCREEN
 - 2-1 CHILDREN'S HOUSE
 - 2-1 PRIVY
 - 2-1 BUNK HOUSE
 - 2-1 STAFF PUMPING UNIT
 - 2-1 PARTIAL FILLING EFFLUENT BEDS

ELEVATED STORAGE TANK
200,000 GAL CAP.

MILITARY & ENTRANCE AREA

- 1. 2.4.0 TURRET & GATE
- 2. ENTRY HOUSE
- 3. GUARD STATION
- 4. PROCESSING BLDG.
- 5. TURRET
- 6. GUARD HOUSE
- 7. GUARD INSPECTION
- 8. OFFICER'S MESS
- 9. OFFICER'S SUPPLY RM.
- 10. ORDNANCE
- 11. AIR. POWER HSE.
- 12. SUB. STATION
- 13. OFFICER'S REC.
- 14. GOLD STORAGE
- 15. FIRE STATION
- 16. 4' x 6' MESS (320)
- 17. THEATRE
- 18. ADMINISTRATION
- 19. POST EXCHANGE
- 20. O.M. WHEEL
- 21. SCHOOL
- 22. 30.32 OFFICER'S OTA'S
- 23. 30.32 A. RECEPTION
- 24. 30.32 B. RECEPTION
- 25. 30.32 C. RECEPTION
- 26. 30.32 D. RECEPTION
- 27. 30.32 E. RECEPTION
- 28. 30.32 F. RECEPTION
- 29. 30.32 G. RECEPTION
- 30. 30.32 H. RECEPTION
- 31. 30.32 I. RECEPTION
- 32. 30.32 J. RECEPTION
- 33. 30.32 K. RECEPTION
- 34. 30.32 L. RECEPTION
- 35. 30.32 M. RECEPTION
- 36. 30.32 N. RECEPTION
- 37. 30.32 O. RECEPTION
- 38. 30.32 P. RECEPTION
- 39. 30.32 Q. RECEPTION
- 40. 30.32 R. RECEPTION
- 41. 30.32 S. RECEPTION
- 42. 30.32 T. RECEPTION
- 43. 30.32 U. RECEPTION
- 44. 30.32 V. RECEPTION
- 45. 30.32 W. RECEPTION
- 46. 30.32 X. RECEPTION
- 47. 30.32 Y. RECEPTION
- 48. 30.32 Z. RECEPTION

POST ENGR'S MOTOR POOL

- 63. GAS STA. 2 PUMP S.
- 64. LUBRICATION
- 65. GREASE RACK
- 66. T.V. AMBULANCE SHEDS
- 67. MOTOR REPAIR
- 68. WAREHOUSE
- 69. ADMINISTRATION
- 70. UTILITIES BUILDING
- 71. CARPENTERS & PAINT

STOKADE AREA BLK 89

- 364. PRISON
- 365. BARRACKS
- 366. MESS
- 367. LATRINE

WRA MOTOR POOL AREA

- 101. DISPATCH OFFICE
- 102. OFFICE
- 103. AUTO REPAIR SHOP
- 104. FURNITURE FACTORY
- 105. OPEN
- 106. FURNITURE FACTORY
- 107. VEHICLE WASH RACK
- 108. EXHAUST & INSULATORS
- 109. PERSONNEL SHED
- 110. VEHICLE

PERSONNEL AREA - BLK. 1

- 111. POST OFFICE
- 112. RECEPTION
- 113. RECEPTION
- 114. RECEPTION
- 115. RECEPTION
- 116. RECEPTION
- 117. RECEPTION
- 118. RECEPTION
- 119. RECEPTION
- 120. RECEPTION
- 121. RECEPTION
- 122. RECEPTION
- 123. RECEPTION
- 124. RECEPTION
- 125. RECEPTION
- 126. RECEPTION
- 127. RECEPTION
- 128. RECEPTION
- 129. RECEPTION
- 130. RECEPTION
- 131. RECEPTION
- 132. RECEPTION
- 133. RECEPTION
- 134. RECEPTION
- 135. RECEPTION
- 136. RECEPTION
- 137. RECEPTION
- 138. RECEPTION
- 139. RECEPTION
- 140. RECEPTION
- 141. RECEPTION
- 142. RECEPTION
- 143. RECEPTION
- 144. RECEPTION
- 145. RECEPTION
- 146. RECEPTION
- 147. RECEPTION
- 148. RECEPTION
- 149. RECEPTION
- 150. RECEPTION
- 151. RECEPTION
- 152. RECEPTION
- 153. RECEPTION
- 154. RECEPTION
- 155. RECEPTION
- 156. RECEPTION
- 157. RECEPTION
- 158. RECEPTION
- 159. RECEPTION
- 160. RECEPTION
- 161. RECEPTION
- 162. RECEPTION
- 163. RECEPTION
- 164. RECEPTION
- 165. RECEPTION
- 166. RECEPTION
- 167. RECEPTION
- 168. RECEPTION
- 169. RECEPTION
- 170. RECEPTION
- 171. RECEPTION
- 172. RECEPTION
- 173. RECEPTION
- 174. RECEPTION
- 175. RECEPTION
- 176. RECEPTION
- 177. RECEPTION
- 178. RECEPTION
- 179. RECEPTION
- 180. RECEPTION
- 181. RECEPTION
- 182. RECEPTION
- 183. RECEPTION
- 184. RECEPTION
- 185. RECEPTION
- 186. RECEPTION
- 187. RECEPTION
- 188. RECEPTION
- 189. RECEPTION
- 190. RECEPTION
- 191. RECEPTION
- 192. RECEPTION
- 193. RECEPTION
- 194. RECEPTION
- 195. RECEPTION
- 196. RECEPTION
- 197. RECEPTION
- 198. RECEPTION
- 199. RECEPTION
- 200. RECEPTION

INDUSTRIAL AREA

- 201. HEAVY EQUIPMENT OFFICE
- 202. COAL DUMPING SHED
- 203. ROOFING
- 204. ROOFING
- 205. SURVEY SURPLUS
- 206. SURVEY SURPLUS
- 207. SURVEY SURPLUS
- 208. SURVEY SURPLUS
- 209. SURVEY SURPLUS
- 210. SURVEY SURPLUS
- 211. SURVEY SURPLUS
- 212. SURVEY SURPLUS
- 213. SURVEY SURPLUS
- 214. SURVEY SURPLUS
- 215. SURVEY SURPLUS
- 216. SURVEY SURPLUS
- 217. SURVEY SURPLUS
- 218. SURVEY SURPLUS
- 219. SURVEY SURPLUS
- 220. SURVEY SURPLUS
- 221. SURVEY SURPLUS
- 222. SURVEY SURPLUS
- 223. SURVEY SURPLUS
- 224. SURVEY SURPLUS
- 225. SURVEY SURPLUS
- 226. SURVEY SURPLUS
- 227. SURVEY SURPLUS
- 228. SURVEY SURPLUS
- 229. SURVEY SURPLUS
- 230. SURVEY SURPLUS
- 231. SURVEY SURPLUS
- 232. SURVEY SURPLUS
- 233. SURVEY SURPLUS
- 234. SURVEY SURPLUS
- 235. SURVEY SURPLUS
- 236. SURVEY SURPLUS
- 237. SURVEY SURPLUS
- 238. SURVEY SURPLUS
- 239. SURVEY SURPLUS
- 240. SURVEY SURPLUS
- 241. SURVEY SURPLUS
- 242. SURVEY SURPLUS
- 243. SURVEY SURPLUS
- 244. SURVEY SURPLUS
- 245. SURVEY SURPLUS
- 246. SURVEY SURPLUS
- 247. SURVEY SURPLUS
- 248. SURVEY SURPLUS
- 249. SURVEY SURPLUS
- 250. SURVEY SURPLUS
- 251. SURVEY SURPLUS
- 252. SURVEY SURPLUS
- 253. SURVEY SURPLUS
- 254. SURVEY SURPLUS
- 255. SURVEY SURPLUS
- 256. SURVEY SURPLUS
- 257. SURVEY SURPLUS
- 258. SURVEY SURPLUS
- 259. SURVEY SURPLUS
- 260. SURVEY SURPLUS
- 261. SURVEY SURPLUS
- 262. SURVEY SURPLUS
- 263. SURVEY SURPLUS
- 264. SURVEY SURPLUS
- 265. SURVEY SURPLUS
- 266. SURVEY SURPLUS
- 267. SURVEY SURPLUS
- 268. SURVEY SURPLUS
- 269. SURVEY SURPLUS
- 270. SURVEY SURPLUS
- 271. SURVEY SURPLUS
- 272. SURVEY SURPLUS
- 273. SURVEY SURPLUS
- 274. SURVEY SURPLUS
- 275. SURVEY SURPLUS
- 276. SURVEY SURPLUS
- 277. SURVEY SURPLUS
- 278. SURVEY SURPLUS
- 279. SURVEY SURPLUS
- 280. SURVEY SURPLUS
- 281. SURVEY SURPLUS
- 282. SURVEY SURPLUS
- 283. SURVEY SURPLUS
- 284. SURVEY SURPLUS
- 285. SURVEY SURPLUS
- 286. SURVEY SURPLUS
- 287. SURVEY SURPLUS
- 288. SURVEY SURPLUS
- 289. SURVEY SURPLUS
- 290. SURVEY SURPLUS
- 291. SURVEY SURPLUS
- 292. SURVEY SURPLUS
- 293. SURVEY SURPLUS
- 294. SURVEY SURPLUS
- 295. SURVEY SURPLUS
- 296. SURVEY SURPLUS
- 297. SURVEY SURPLUS
- 298. SURVEY SURPLUS
- 299. SURVEY SURPLUS
- 300. SURVEY SURPLUS

EVACUEE AREA

- 301. 01-07 APARTMENTS
- 302. 01-08 APARTMENTS
- 303. 01-09 APARTMENTS
- 304. 01-10 APARTMENTS
- 305. 01-11 APARTMENTS
- 306. 01-12 APARTMENTS
- 307. 01-13 APARTMENTS
- 308. 01-14 APARTMENTS
- 309. 01-15 APARTMENTS
- 310. 01-16 APARTMENTS
- 311. 01-17 APARTMENTS
- 312. 01-18 APARTMENTS
- 313. 01-19 APARTMENTS
- 314. 01-20 APARTMENTS
- 315. 01-21 APARTMENTS
- 316. 01-22 APARTMENTS
- 317. 01-23 APARTMENTS
- 318. 01-24 APARTMENTS
- 319. 01-25 APARTMENTS
- 320. 01-26 APARTMENTS
- 321. 01-27 APARTMENTS
- 322. 01-28 APARTMENTS
- 323. 01-29 APARTMENTS
- 324. 01-30 APARTMENTS
- 325. 01-31 APARTMENTS
- 326. 01-32 APARTMENTS
- 327. 01-33 APARTMENTS
- 328. 01-34 APARTMENTS
- 329. 01-35 APARTMENTS
- 330. 01-36 APARTMENTS
- 331. 01-37 APARTMENTS
- 332. 01-38 APARTMENTS
- 333. 01-39 APARTMENTS
- 334. 01-40 APARTMENTS
- 335. 01-41 APARTMENTS
- 336. 01-42 APARTMENTS
- 337. 01-43 APARTMENTS
- 338. 01-44 APARTMENTS
- 339. 01-45 APARTMENTS
- 340. 01-46 APARTMENTS
- 341. 01-47 APARTMENTS
- 342. 01-48 APARTMENTS
- 343. 01-49 APARTMENTS
- 344. 01-50 APARTMENTS
- 345. 01-51 APARTMENTS
- 346. 01-52 APARTMENTS
- 347. 01-53 APARTMENTS
- 348. 01-54 APARTMENTS
- 349. 01-55 APARTMENTS
- 350. 01-56 APARTMENTS
- 351. 01-57 APARTMENTS
- 352. 01-58 APARTMENTS
- 353. 01-59 APARTMENTS
- 354. 01-60 APARTMENTS
- 355. 01-61 APARTMENTS
- 356. 01-62 APARTMENTS
- 357. 01-63 APARTMENTS
- 358. 01-64 APARTMENTS
- 359. 01-65 APARTMENTS
- 360. 01-66 APARTMENTS
- 361. 01-67 APARTMENTS
- 362. 01-68 APARTMENTS
- 363. 01-69 APARTMENTS
- 364. 01-70 APARTMENTS
- 365. 01-71 APARTMENTS
- 366. 01-72 APARTMENTS
- 367. 01-73 APARTMENTS
- 368. 01-74 APARTMENTS
- 369. 01-75 APARTMENTS
- 370. 01-76 APARTMENTS
- 371. 01-77 APARTMENTS
- 372. 01-78 APARTMENTS
- 373. 01-79 APARTMENTS
- 374. 01-80 APARTMENTS
- 375. 01-81 APARTMENTS
- 376. 01-82 APARTMENTS
- 377. 01-83 APARTMENTS
- 378. 01-84 APARTMENTS
- 379. 01-85 APARTMENTS
- 380. 01-86 APARTMENTS
- 381. 01-87 APARTMENTS
- 382. 01-88 APARTMENTS
- 383. 01-89 APARTMENTS
- 384. 01-90 APARTMENTS
- 385. 01-91 APARTMENTS
- 386. 01-92 APARTMENTS
- 387. 01-93 APARTMENTS
- 388. 01-94 APARTMENTS
- 389. 01-95 APARTMENTS
- 390. 01-96 APARTMENTS
- 391. 01-97 APARTMENTS
- 392. 01-98 APARTMENTS
- 393. 01-99 APARTMENTS
- 394. 01-100 APARTMENTS

JUNIOR & SENIOR HIGH - 247

- 247. AUDITORIUM
- 248. ELEMENTARY SCHOOL
- 249. WOOD & MACHINE SHOP
- 250. SCIENCE & ECONOMICS
- 251. CLASSROOMS
- 252. LIBRARY
- 253. ADMINISTRATION
- 254. STORAGE

- COMMUNITY BUILDINGS**
- 1708. OUTDOOR STAGE
 - 1709. COUNCIL CHAMBER
 - 1710. COLONIAL PEACE HALL
 - 1711. PLACEMENT OFFICE
 - 1712. WE'FARE LEGAL AID OFFICE
 - 1713. BLK. WGR'S HALL
 - 1714. COMMUNITY ACTIVITIES OFF.
 - 1715. JUDIC. HALL
 - 1716. JUDIC. HALL
 - 1717. JUDIC. HALL
 - 1718. JUDIC. HALL
 - 1719. JUDIC. HALL
 - 1720. JUDIC. HALL
 - 1721. JUDIC. HALL
 - 1722. JUDIC. HALL
 - 1723. JUDIC. HALL
 - 1724. JUDIC. HALL
 - 1725. JUDIC. HALL
 - 1726. JUDIC. HALL
 - 1727. JUDIC. HALL
 - 1728. JUDIC. HALL
 - 1729. JUDIC. HALL
 - 1730. JUDIC. HALL
 - 1731. JUDIC. HALL
 - 1732. JUDIC. HALL
 - 1733. JUDIC. HALL
 - 1734. JUDIC. HALL
 - 1735. JUDIC. HALL
 - 1736. JUDIC. HALL
 - 1737. JUDIC. HALL
 - 1738. JUDIC. HALL
 - 1739. JUDIC. HALL
 - 1740. JUDIC. HALL
 - 1741. JUDIC. HALL
 - 1742. JUDIC. HALL
 - 1743. JUDIC. HALL
 - 1744. JUDIC. HALL
 - 1745. JUDIC. HALL
 - 1746. JUDIC. HALL
 - 1747. JUDIC. HALL
 - 1748. JUDIC. HALL
 - 1749. JUDIC. HALL
 - 1750. JUDIC. HALL
 - 1751. JUDIC. HALL
 - 1752. JUDIC. HALL
 - 1753. JUDIC. HALL
 - 1754. JUDIC. HALL
 - 1755. JUDIC. HALL
 - 1756. JUDIC. HALL
 - 1757. JUDIC. HALL
 - 1758. JUDIC. HALL
 - 1759. JUDIC. HALL
 - 1760. JUDIC. HALL
 - 1761. JUDIC. HALL
 - 1762. JUDIC. HALL
 - 1763. JUDIC. HALL
 - 1764. JUDIC. HALL
 - 1765. JUDIC. HALL
 - 1766. JUDIC. HALL
 - 1767. JUDIC. HALL
 - 1768. JUDIC. HALL
 - 1769. JUDIC. HALL
 - 1770. JUDIC. HALL
 - 1771. JUDIC. HALL
 - 1772. JUDIC. HALL
 - 1773. JUDIC. HALL
 - 1774. JUDIC. HALL
 - 1775. JUDIC. HALL
 - 1776. JUDIC. HALL
 - 1777. JUDIC. HALL
 - 1778. JUDIC. HALL
 - 1779. JUDIC. HALL
 - 1780. JUDIC. HALL
 - 1781. JUDIC. HALL
 - 1782. JUDIC. HALL
 - 1783. JUDIC. HALL
 - 1784. JUDIC. HALL
 - 1785. JUDIC. HALL
 - 1786. JUDIC. HALL
 - 1787. JUDIC. HALL
 - 1788. JUDIC. HALL
 - 1789. JUDIC. HALL
 - 1790. JUDIC. HALL
 - 1791. JUDIC. HALL
 - 1792. JUDIC. HALL
 - 1793. JUDIC. HALL
 - 1794. JUDIC. HALL
 - 1795. JUDIC. HALL
 - 1796. JUDIC. HALL
 - 1797. JUDIC. HALL
 - 1798. JUDIC. HALL
 - 1799. JUDIC. HALL
 - 1800. JUDIC. HALL

- COMMUNITY BUILDINGS**
- 1801. JUDIC. HALL
 - 1802. JUDIC. HALL
 - 1803. JUDIC. HALL
 - 1804. JUDIC. HALL
 - 1805. JUDIC. HALL
 - 1806. JUDIC. HALL
 - 1807. JUDIC. HALL
 - 1808. JUDIC. HALL
 - 1809. JUDIC. HALL
 - 1810. JUDIC. HALL
 - 1811. JUDIC. HALL
 - 1812. JUDIC. HALL
 - 1813. JUDIC. HALL
 - 1814. JUDIC. HALL
 - 1815. JUDIC. HALL
 - 1816. JUDIC. HALL
 - 1817. JUDIC. HALL
 - 1818. JUDIC. HALL
 - 1819. JUDIC. HALL
 - 1820. JUDIC. HALL
 - 1821. JUDIC. HALL
 - 1822. JUDIC. HALL
 - 1823. JUDIC. HALL
 - 1824. JUDIC. HALL
 - 1825. JUDIC. HALL
 - 1826. JUDIC. HALL
 - 1827. JUDIC. HALL
 - 1828. JUDIC. HALL
 - 1829. JUDIC. HALL
 - 1830. JUDIC. HALL
 - 1831. JUDIC. HALL
 - 1832. JUDIC. HALL
 - 1833. JUDIC. HALL
 - 1834. JUDIC. HALL
 - 1835. JUDIC. HALL
 - 1836. JUDIC. HALL
 - 1837. JUDIC. HALL
 - 1838. JUDIC. HALL
 - 1839. JUDIC. HALL
 - 1840. JUDIC. HALL
 - 1841. JUDIC. HALL
 - 1842. JUDIC. HALL
 - 1843. JUDIC. HALL
 - 1844. JUDIC. HALL
 - 1845. JUDIC. HALL
 - 1846. JUDIC. HALL
 - 1847. JUDIC. HALL
 - 1848. JUDIC. HALL
 - 1849. JUDIC. HALL
 - 1850. JUDIC. HALL
 - 1851. JUDIC. HALL
 - 1852. JUDIC. HALL
 - 1853. JUDIC. HALL
 - 1854. JUDIC. HALL
 - 1855. JUDIC. HALL
 - 1856. JUDIC. HALL
 - 1857. JUDIC. HALL
 - 1858. JUDIC. HALL
 - 1859. JUDIC. HALL
 - 1860. JUDIC. HALL
 - 1861. JUDIC. HALL
 - 1862. JUDIC. HALL
 - 1863. JUDIC. HALL
 - 1864. JUDIC. HALL
 - 1865. JUDIC. HALL
 - 1866. JUDIC. HALL
 - 1867. JUDIC. HALL
 - 1868. JUDIC. HALL
 - 1869. JUDIC. HALL
 - 1870. JUDIC. HALL
 - 1871. JUDIC. HALL
 - 1872. JUDIC. HALL
 - 1873. JUDIC. HALL
 - 1874. JUDIC. HALL
 - 1875. JUDIC. HALL
 - 1876. JUDIC. HALL
 - 1877. JUDIC. HALL
 - 1878. JUDIC. HALL
 - 1879. JUDIC. HALL
 - 1880. JUDIC. HALL
 - 1881. JUDIC. HALL
 - 1882. JUDIC. HALL
 - 1883. JUDIC. HALL
 - 1884. JUDIC. HALL
 - 1885. JUDIC. HALL
 - 1886. JUDIC. HALL
 - 1887. JUDIC. HALL
 - 1888. JUDIC. HALL
 - 1889. JUDIC. HALL
 - 1890. JUDIC. HALL
 - 1891. JUDIC. HALL
 - 1892. JUDIC. HALL
 - 1893. JUDIC. HALL
 - 1894. JUDIC. HALL
 - 1895. JUDIC. HALL
 - 1896. JUDIC. HALL
 - 1897. JUDIC. HALL
 - 1898. JUDIC. HALL
 - 1899. JUDIC. HALL
 - 1900. JUDIC. HALL

- COMMUNITY BUILDINGS**
- 1901. JUDIC. HALL
 - 1902. JUDIC. HALL
 - 1903. JUDIC. HALL
 - 1904. JUDIC. HALL
 - 1905. JUDIC. HALL
 - 1906. JUDIC. HALL
 - 1907. JUDIC. HALL
 - 1908. JUDIC. HALL
 - 1909. JUDIC. HALL
 - 1910. JUDIC. HALL
 - 1911. JUDIC. HALL
 - 1912. JUDIC. HALL
 - 1913. JUDIC. HALL
 - 1914. JUDIC. HALL
 - 1915. JUDIC. HALL
 - 1916. JUDIC. HALL
 - 1917. JUDIC. HALL
 - 1918. JUDIC. HALL
 - 1919. JUDIC. HALL
 - 1920. JUDIC. HALL
 - 1921. JUDIC. HALL
 - 1922. JUDIC. HALL
 - 1923. JUDIC. HALL
 - 1924. JUDIC. HALL
 - 1925. JUDIC. HALL
 - 1926. JUDIC. HALL
 - 1927. JUDIC. HALL
 - 1928. JUDIC. HALL
 - 1929. JUDIC. HALL
 - 1930. JUDIC. HALL
 - 1931. JUDIC. HALL
 - 1932. JUDIC. HALL
 - 1933. JUDIC. HALL
 - 1934. JUDIC. HALL
 - 1935. JUDIC. HALL
 - 1936. JUDIC. HALL
 - 1937. JUDIC. HALL
 - 1938. JUDIC. HALL
 - 1939. JUDIC. HALL
 - 1940. JUDIC. HALL
 - 1941. JUDIC. HALL
 - 1942. JUDIC. HALL
 - 1943. JUDIC. HALL
 - 1944. JUDIC. HALL
 - 1945. JUDIC. HALL
 - 1946. JUDIC. HALL
 - 1947. JUDIC. HALL
 - 1948. JUDIC. HALL
 - 1949. JUDIC. HALL
 - 1950. JUDIC. HALL
 - 1951. JUDIC. HALL
 - 1952. JUDIC. HALL
 - 1953. JUDIC. HALL
 - 1954. JUDIC. HALL
 - 1955. JUDIC. HALL
 - 1956. JUDIC. HALL
 - 1